

MODULAR BORDERLESS

PROJECTION SCREENS & GRAPHIC PANELS

INSTALLATION & MAINTENANCE GUIDE

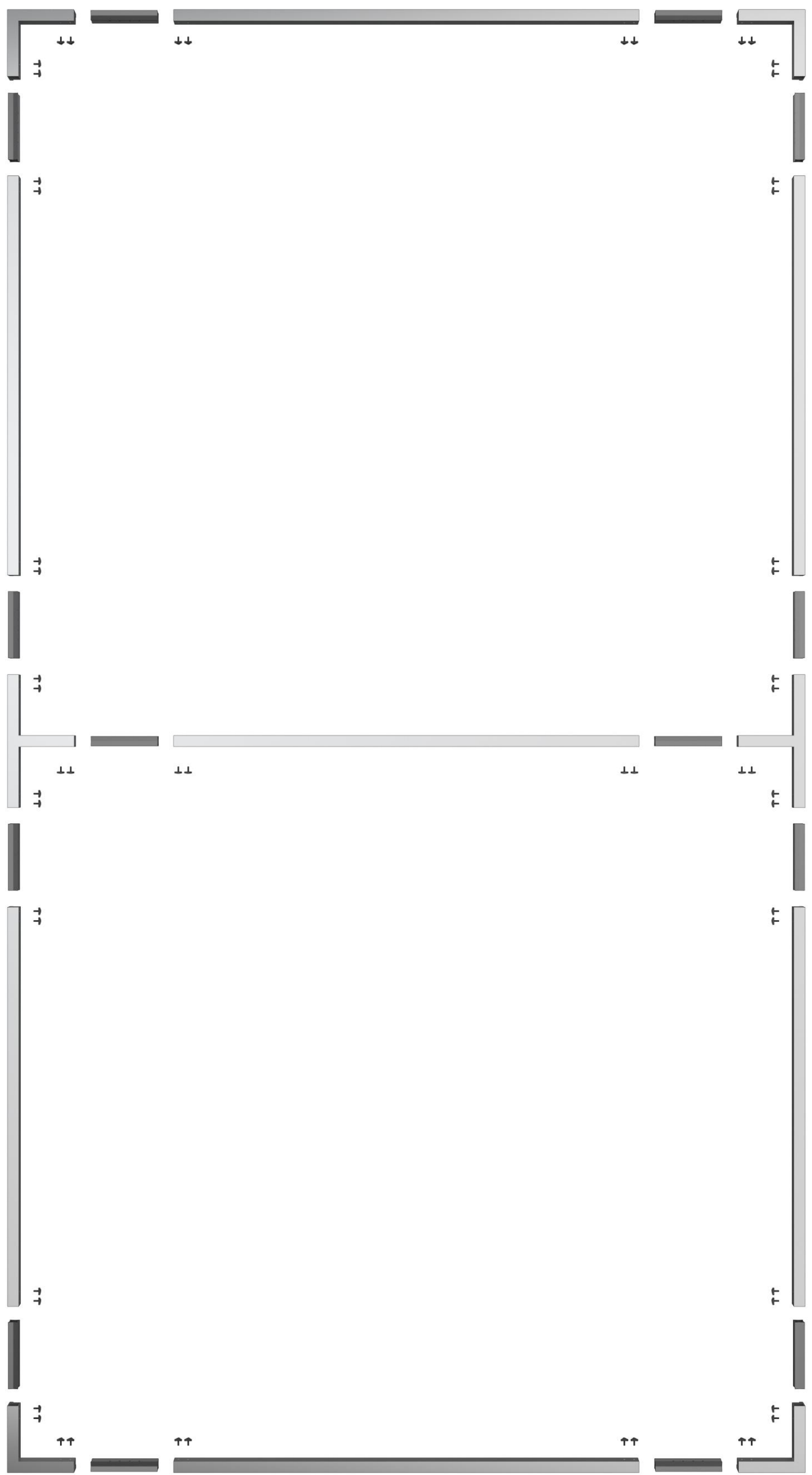

LARGE-SCALE FRAME SOLUTIONS FOR PROJECTION AND PRINT

TABLE OF CONTENTS

1.0

Before You Build

3

Proper Fabric Handling

3

Included Parts and Recommended Tools

3

2.0

Product Construction

4 - 14

Frame Assembly Instructions

4 - 10

Fabric Tips and Tricks

11

Fabric Application Instructions

12 - 14

3.0

Product Installation

15 - 19

Rigging and Installation Notes

15

Rigging Hardware Options

16-19

i. M10 Aerial Rigging Eyes

16

ii. Top Hang Brackets

17

iii. Pro Clamps

18

iv. Ground Mount Brackets

19

4.0

Fabric Care

20-21

BOSF Storage notes and methods

20

BOSF Cleaning and fabric care

20

USF Storage notes and methods

21

USF Cleaning and fabric care

21

Install questions?

Contact us. We are here to
help you succeed!

1.888.370.0202



BEFORE YOU BUILD

Proper Fabric Handling

To avoid smudges and dirt buildup on your fabric, always install your product using nitrile gloves. Even clean hands can leave an oily residue on the fabric surface that attracts dirt and dust. Additionally, consider using drop cloths or plastic sheeting on the floor to maintain a clean working environment free of debris.

Included in the Bag



Nitrile Gloves

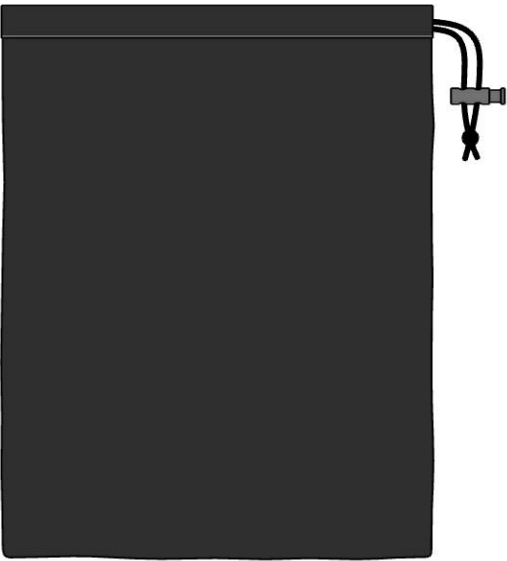

Storage Bag

(Not Included with Oversized Skins)

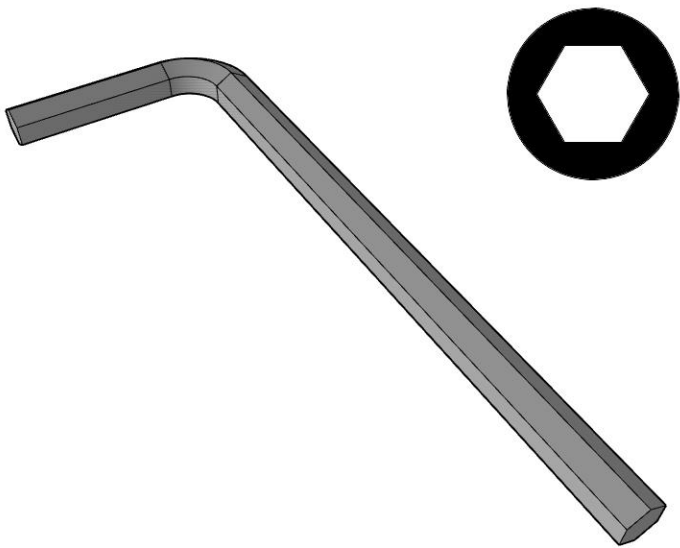

3/16" Allen Key - x1

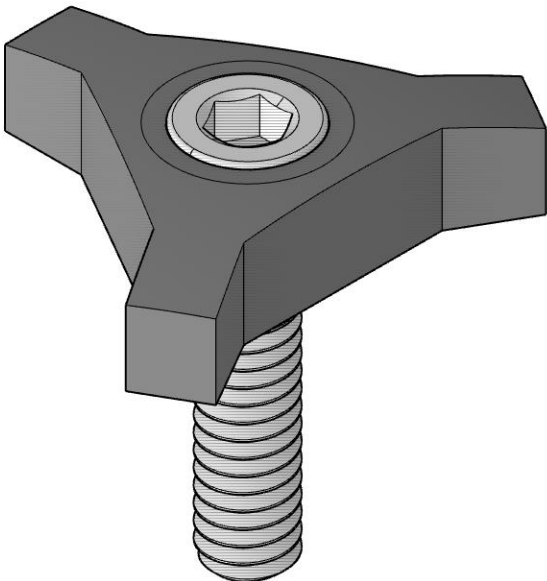

1/4-20 TS Fasteners

Recommended Tools

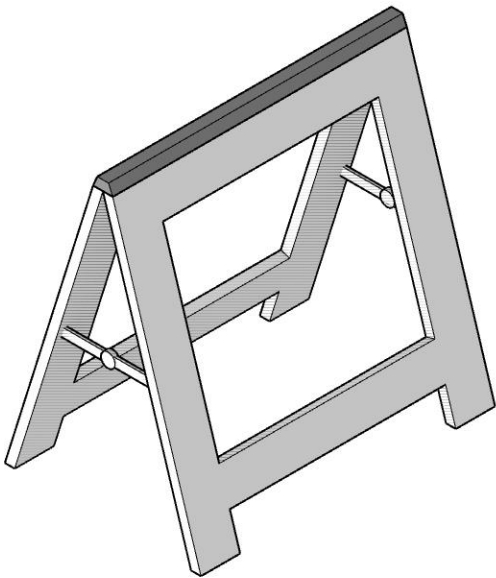

Sawhorses

(Wood Blocks, or Road Cases also work)

PRODUCT CONSTRUCTION

Frame Assembly

1

Establish a clean working environment. Consider using drop cloths or plastic sheeting to maintain a debris-free surface.

PRO TIP

Carpeted floors work well for setup

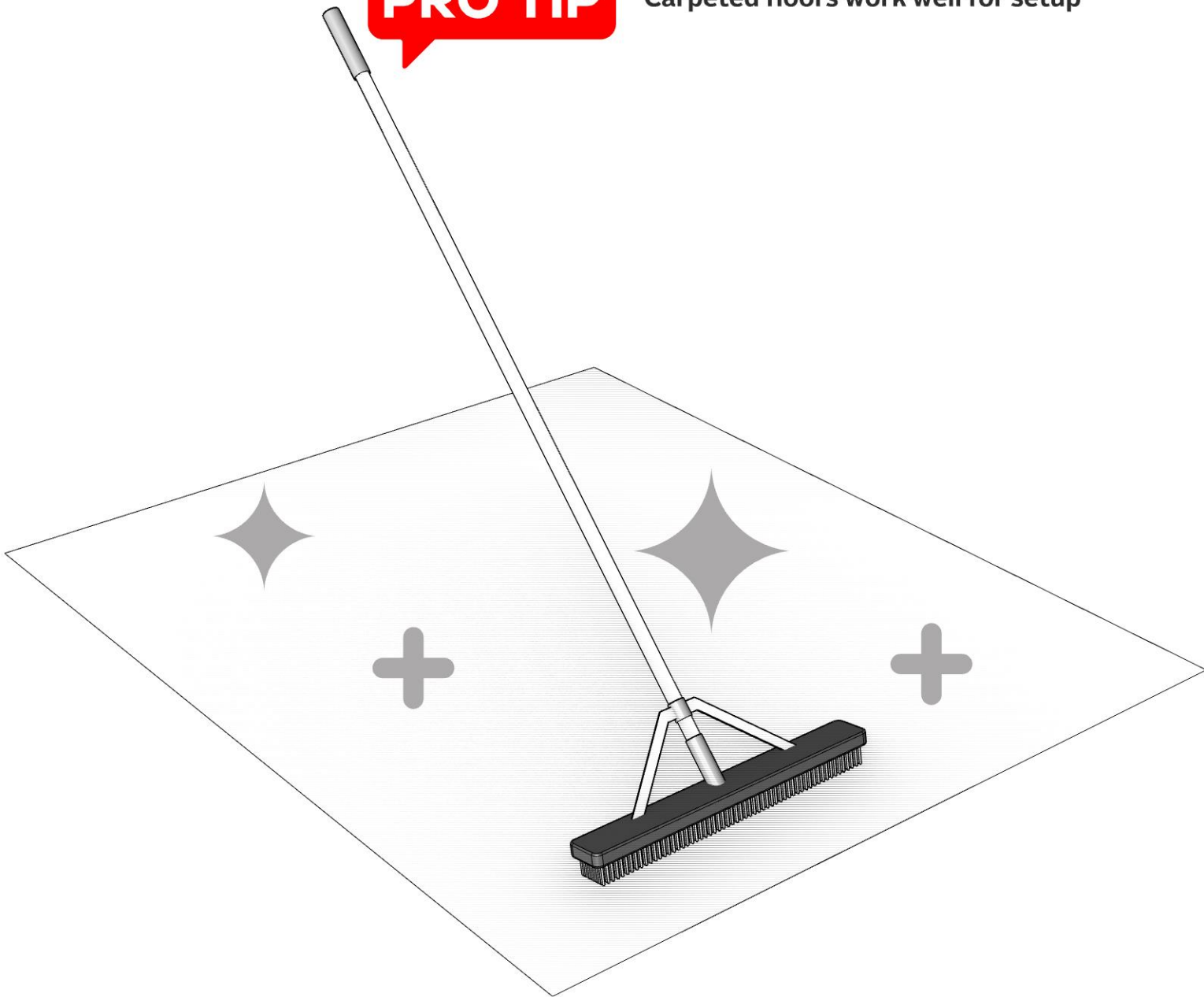

2

Familiarize yourself with assembly labels. Modular Borderless Frames come with design drawings that show how a frame is constructed. All parts are color coded to a key.

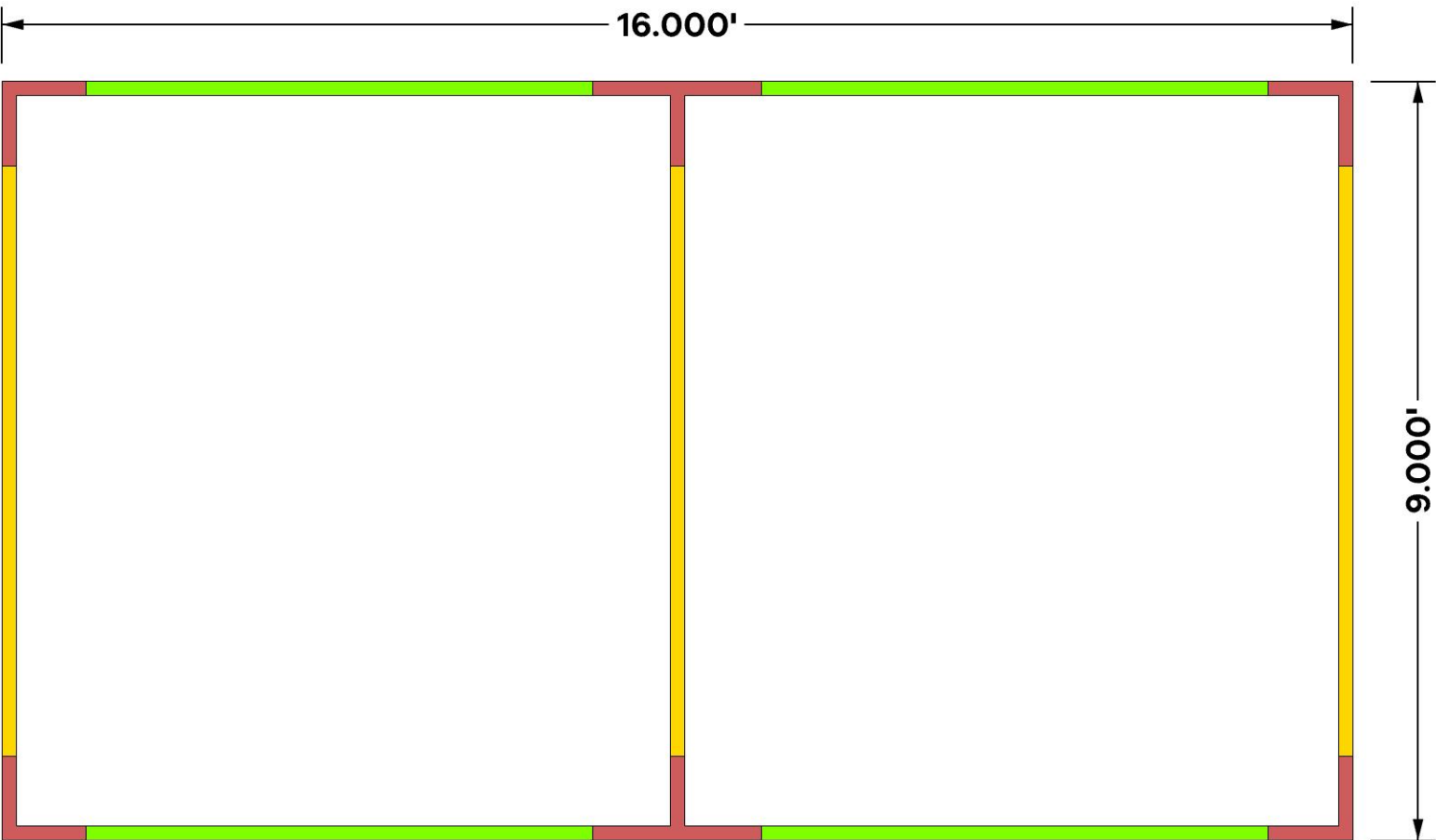

3

Organize your frame parts. Place each frame segment and junction on your clean surface, matching the layout in the provided drawing.

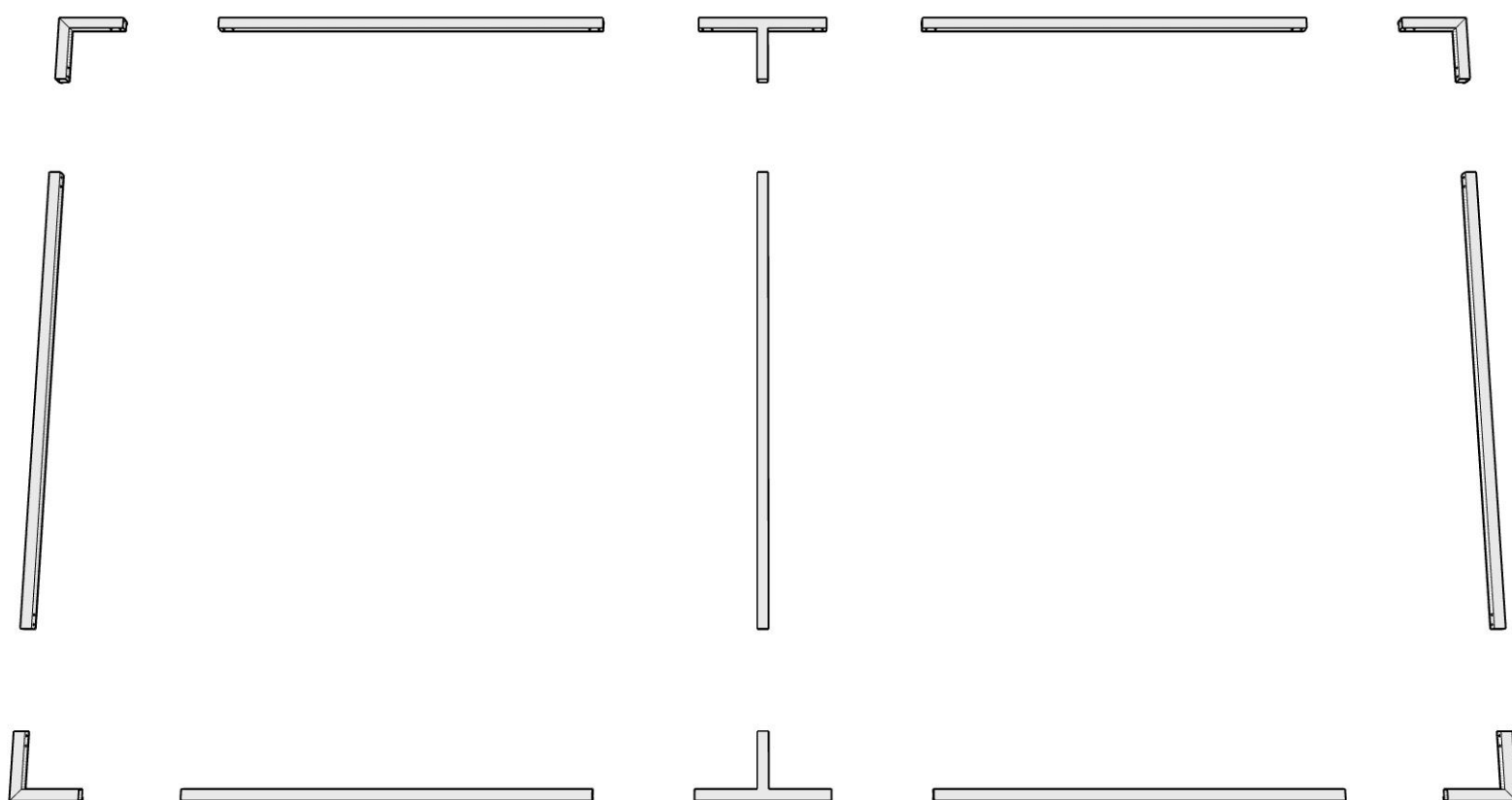

IF YOUR FRAME HAS GROUND SUPPORT CAPABILITIES, ensure that you place all junctions with ground support inserts along one edge of the frame. **SEE BELOW.**

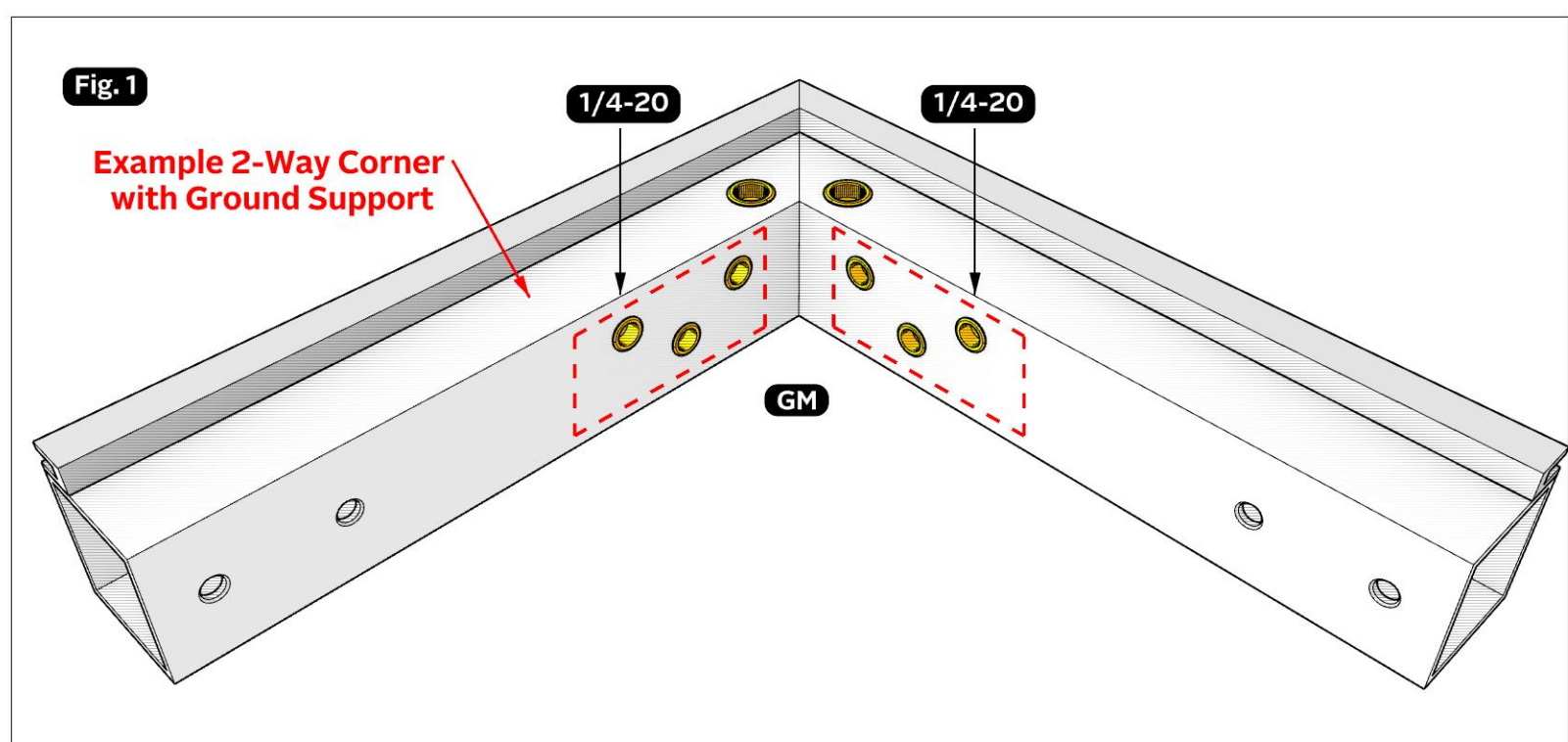
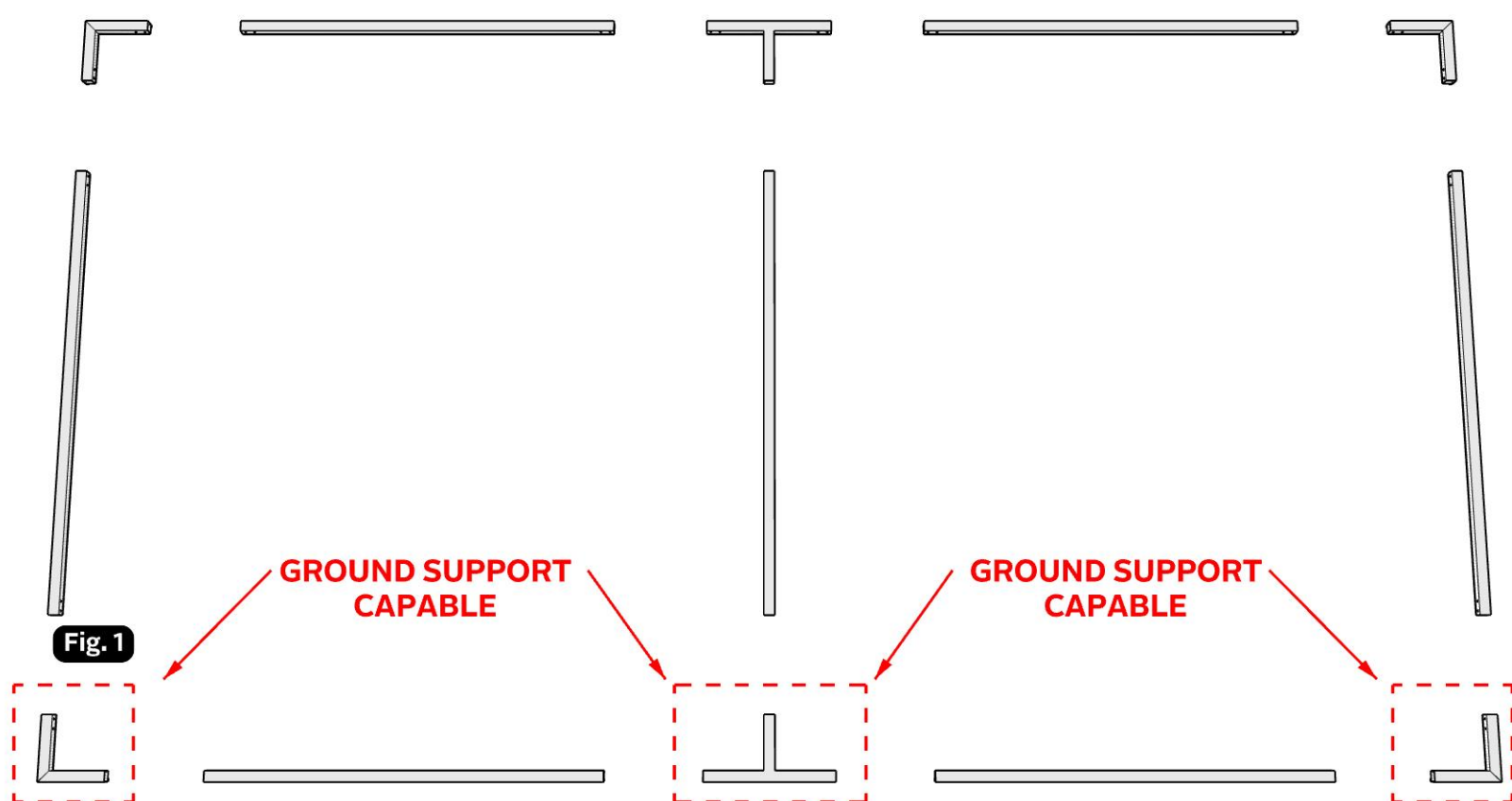

4

Place a coupler at every location where frame parts join together.

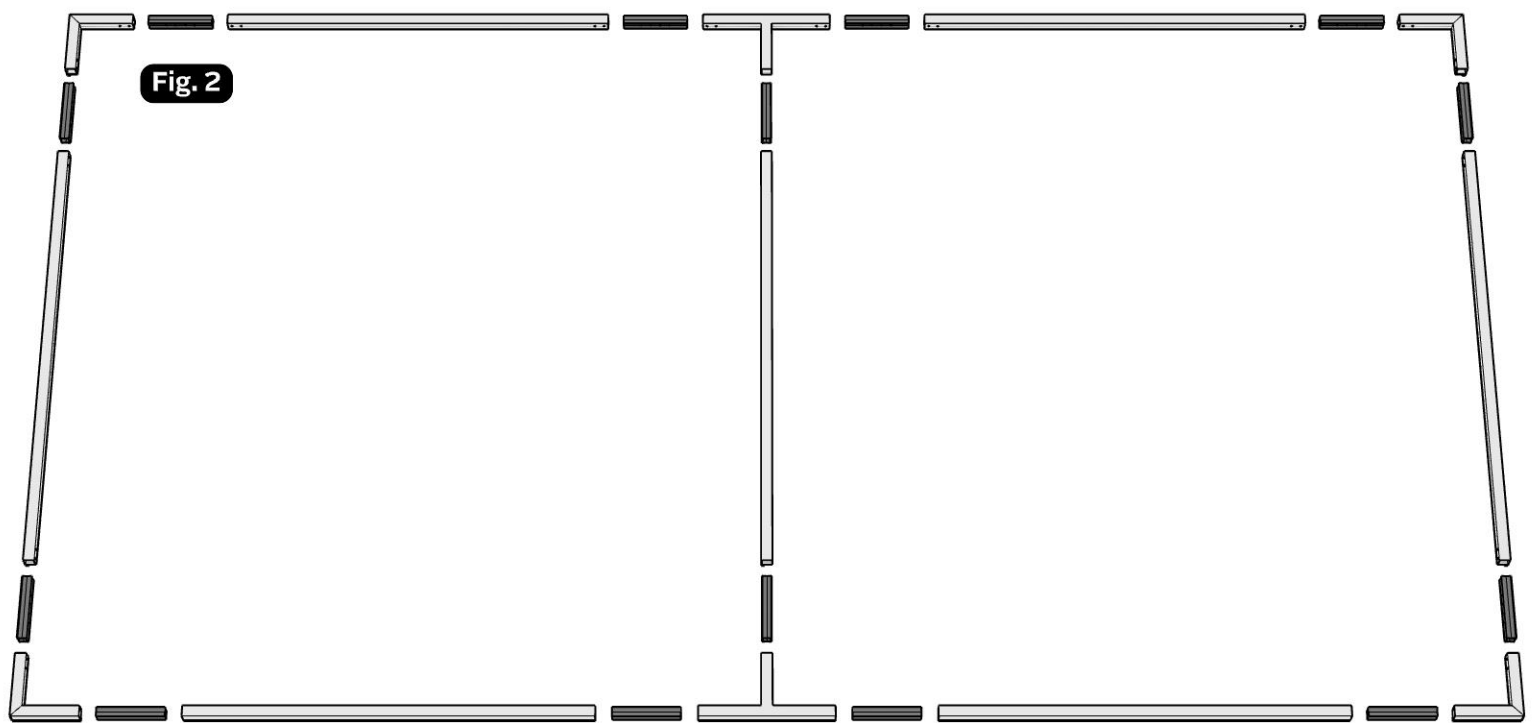
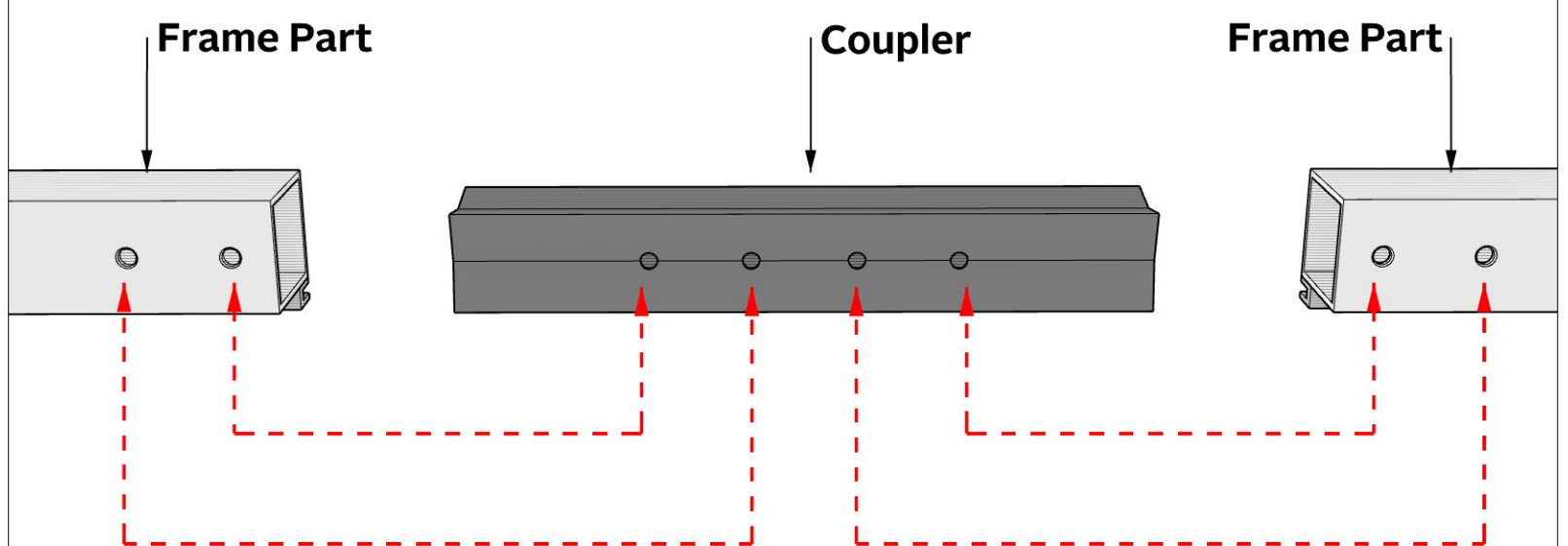
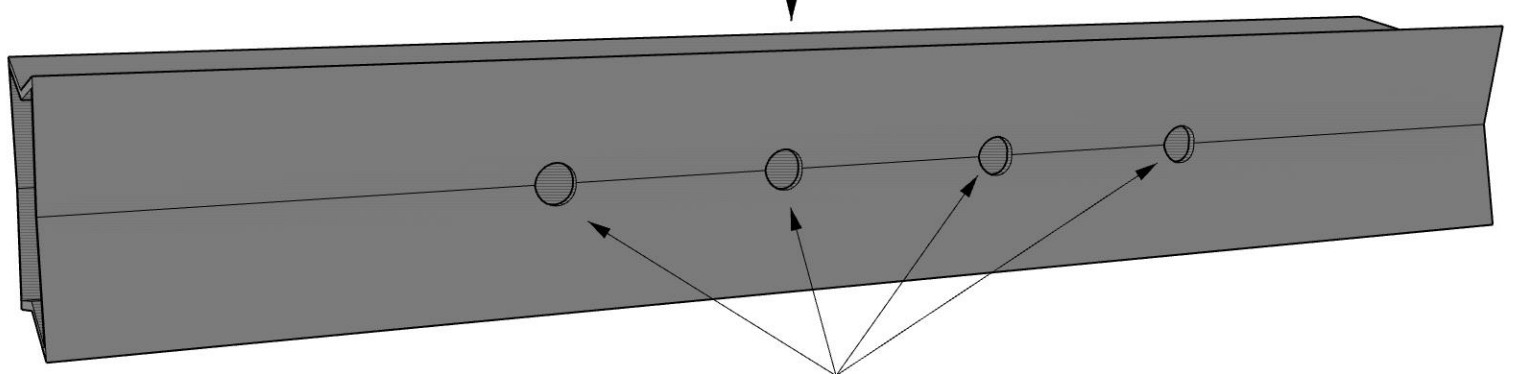

Fig. 2



12" Coupler



Holes for Fasteners

5

Before constructing your frame, review the recommended steps for assembling a coupler joint as outlined below. This method can be used for all coupler joints.

A

Insert the steel coupler into one segment or junction. Align the first two holes of the coupler with the holes on the frame part.

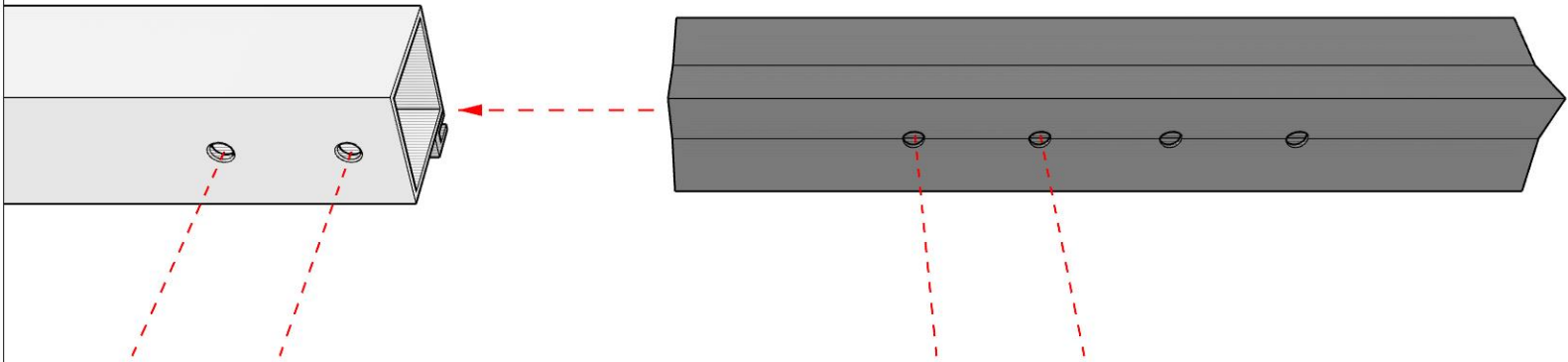

B

Use the provided fasteners to attach the coupler to the tube. Do not fully tighten the fasteners until STEP 8.

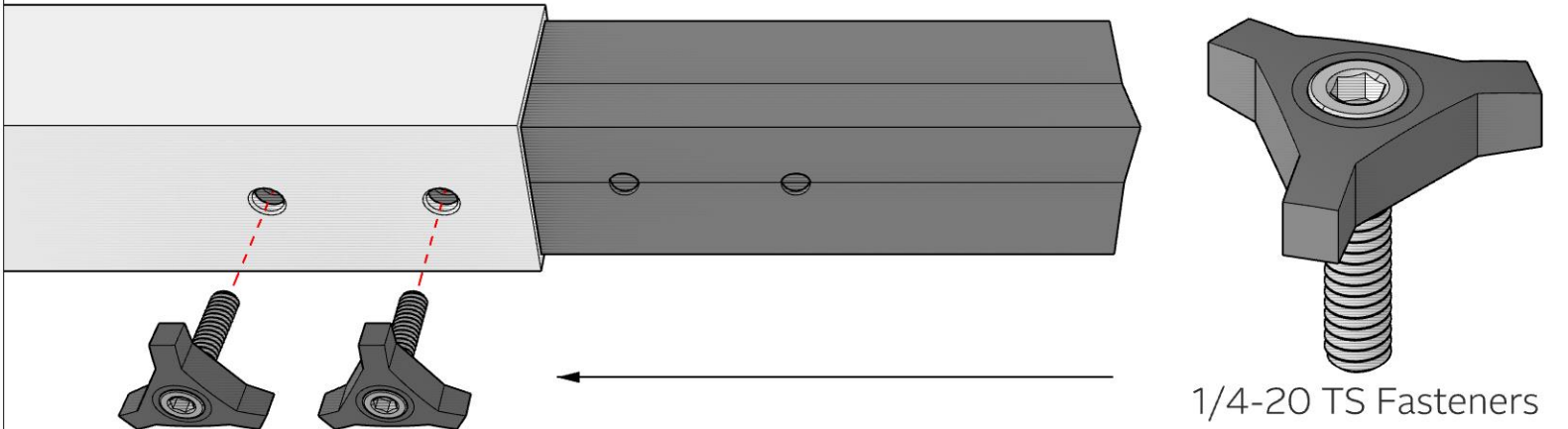

C

Slide another frame part onto the coupler. Align the remaining holes of the coupler with the holes on the frame part.

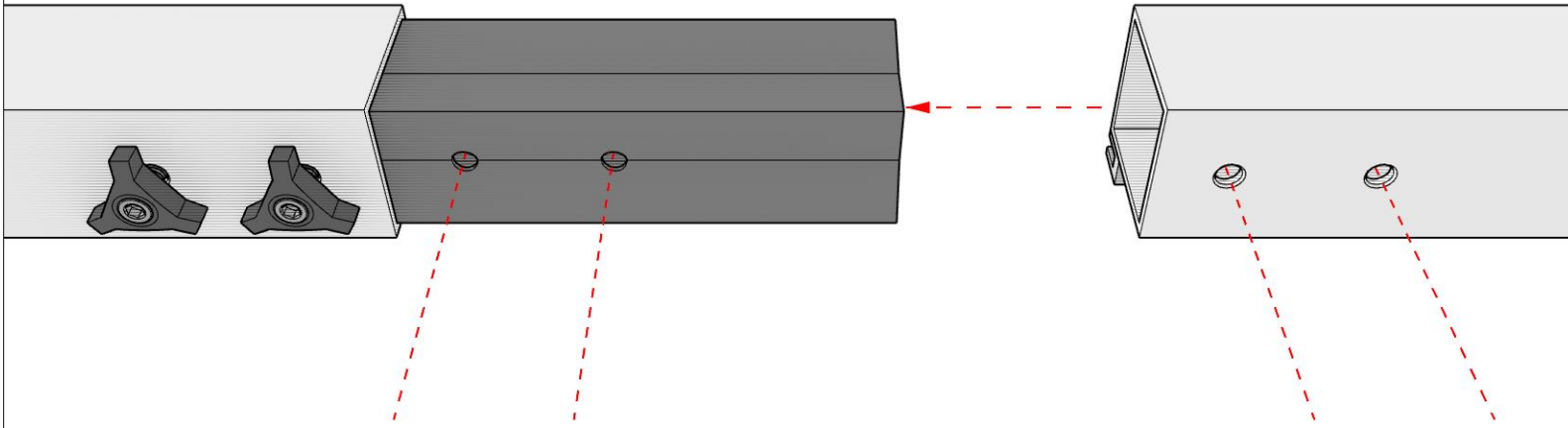

D

Use the provided fasteners to attach the coupler to the tube. Do not fully tighten the fasteners until STEP 8.

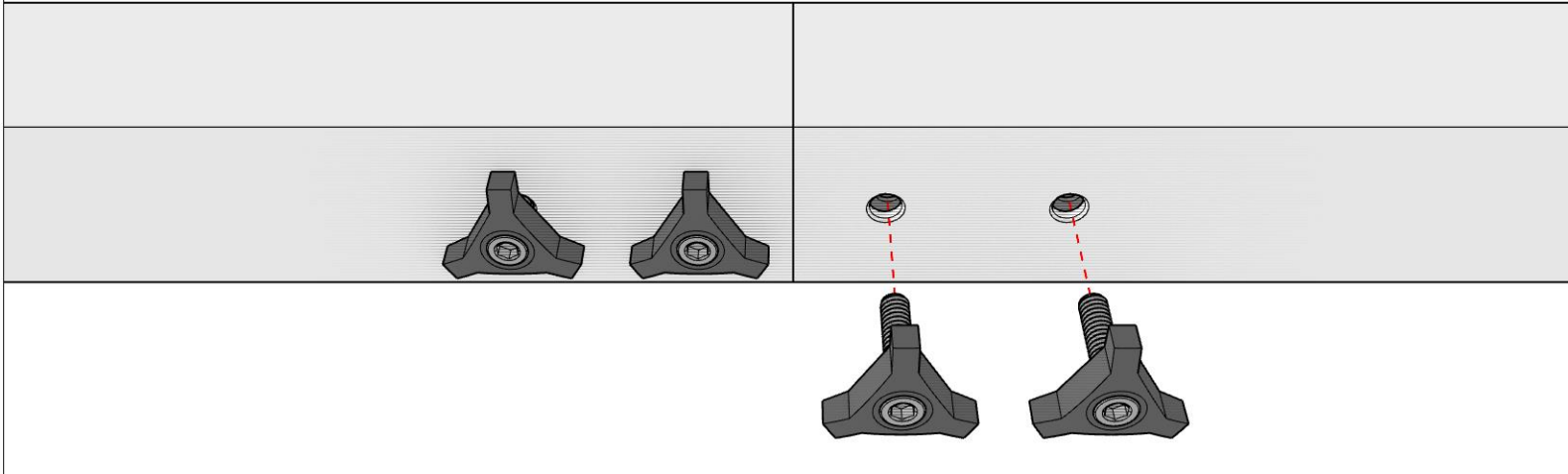

6

Using the methodology from step 5, construct the external ends of your frame assembly. Construct any internal supports as well. **DO NOT fully tighten the fasteners until STEP 8.**

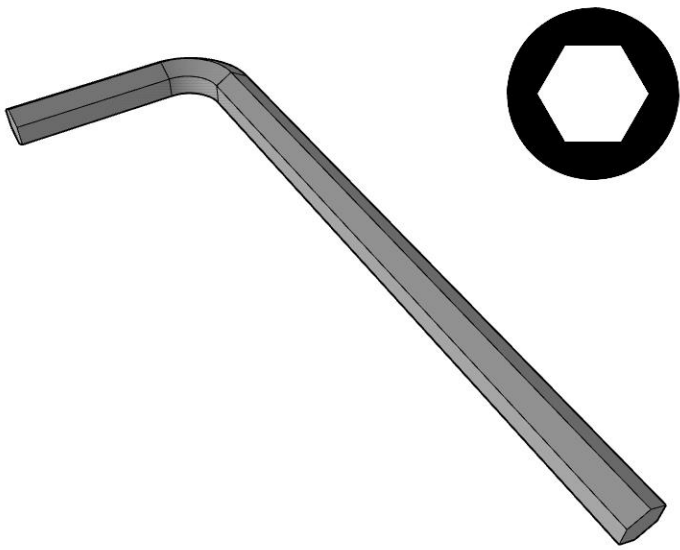

3/16" Allen Key - x1

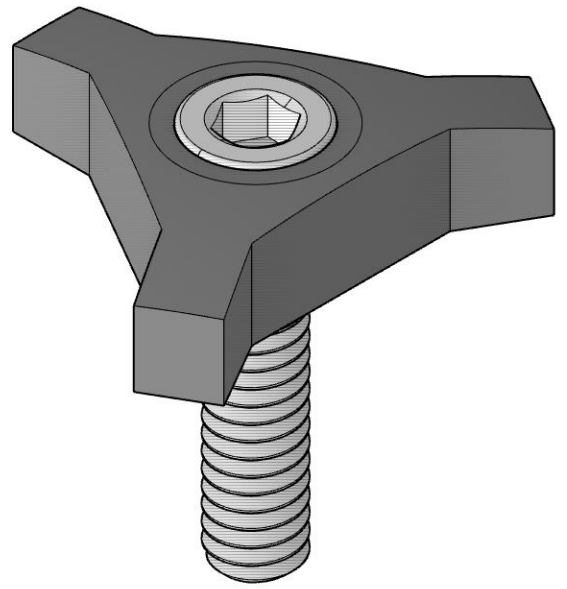

1/4-20 TS Fasteners

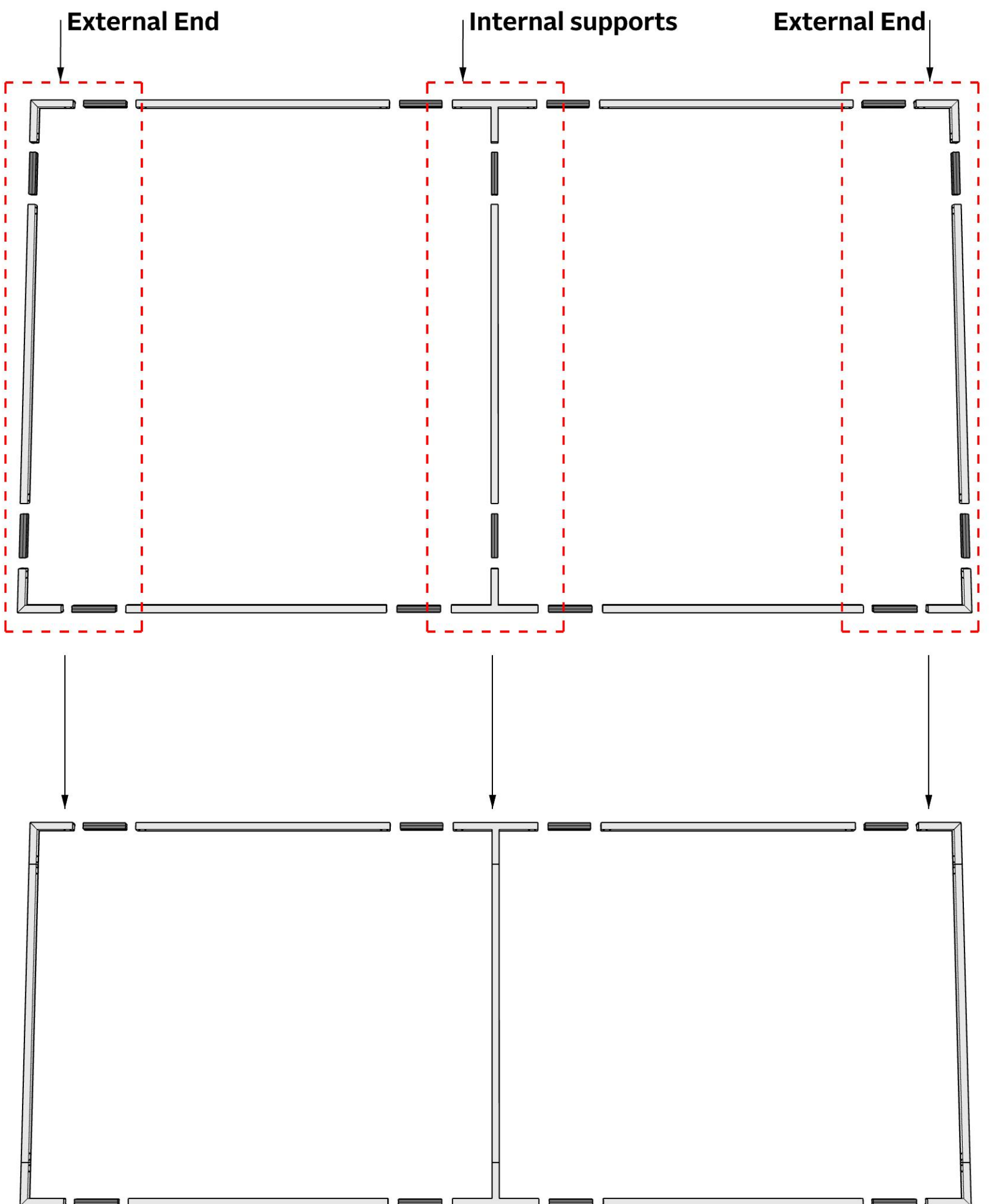

DO NOT fully tighten the fasteners until STEP 8

7

Using the methodology from step 5, connect the horizontal segments to the frame. Work in one direction, from one side to the other. **DO NOT fully tighten the fasteners until STEP 8.**

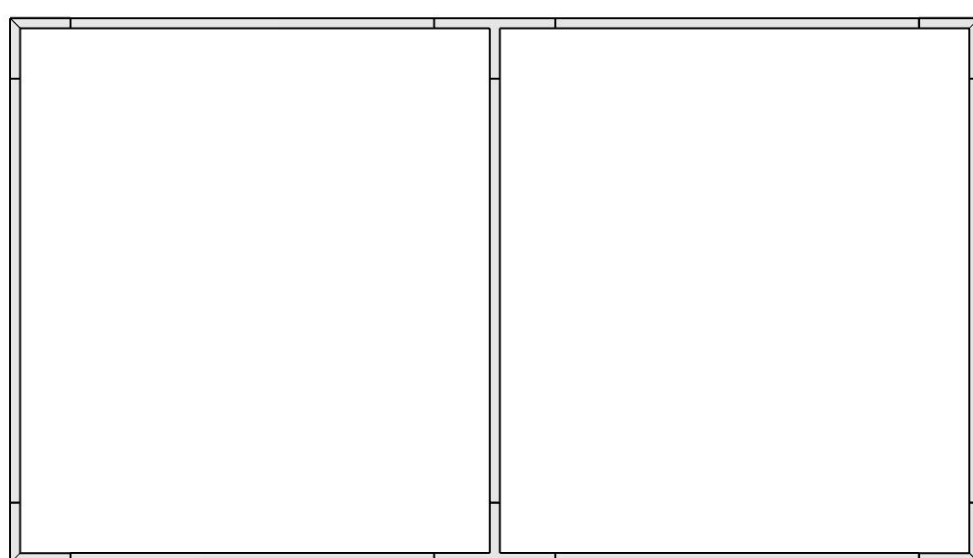
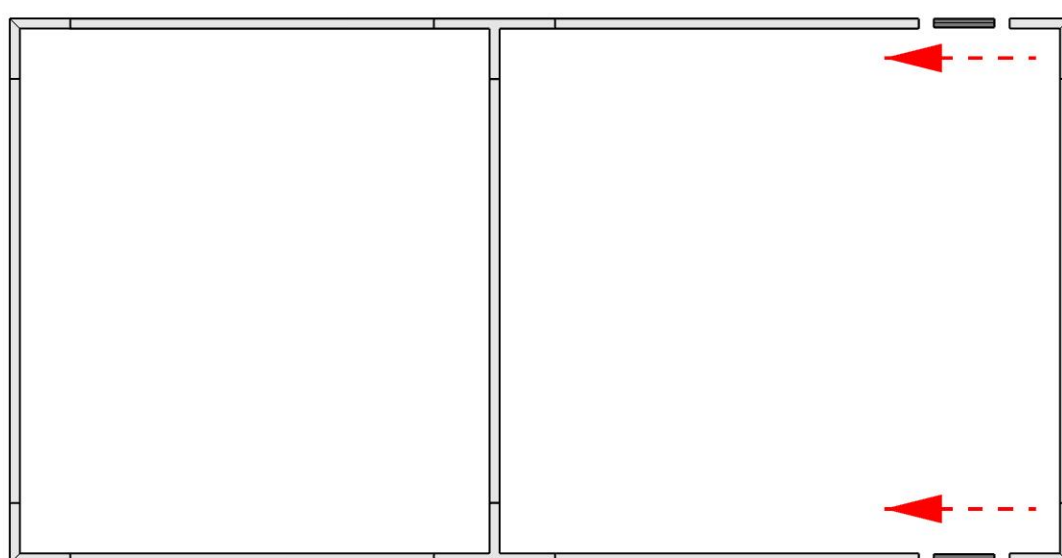
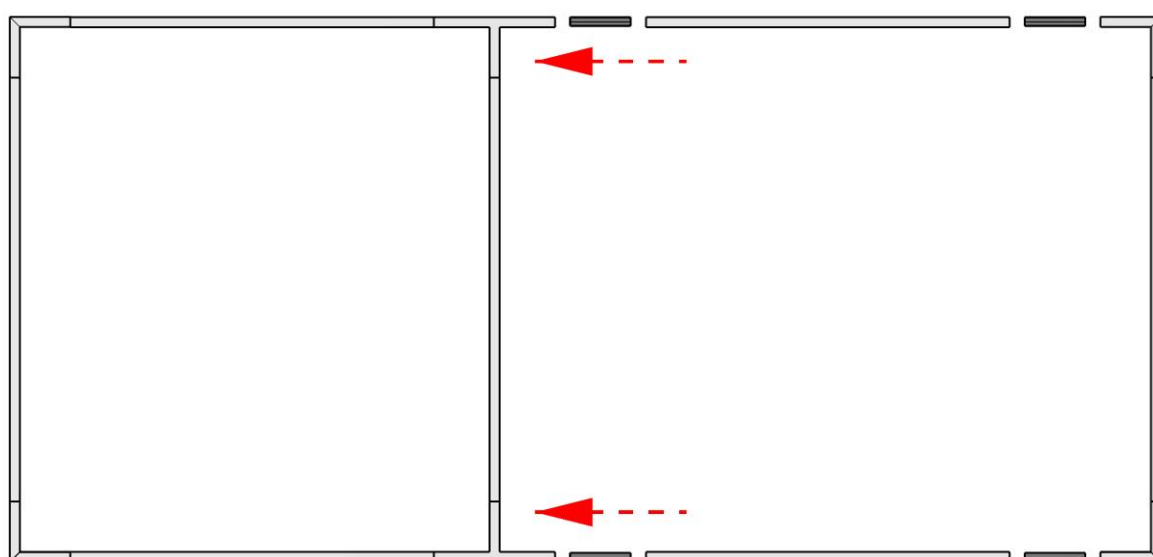
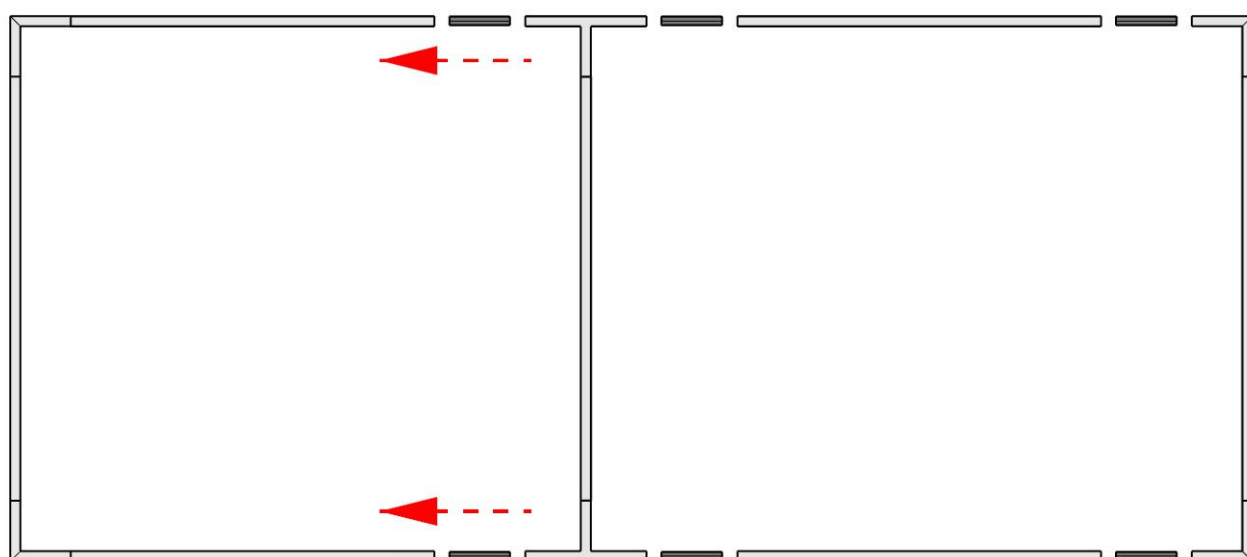
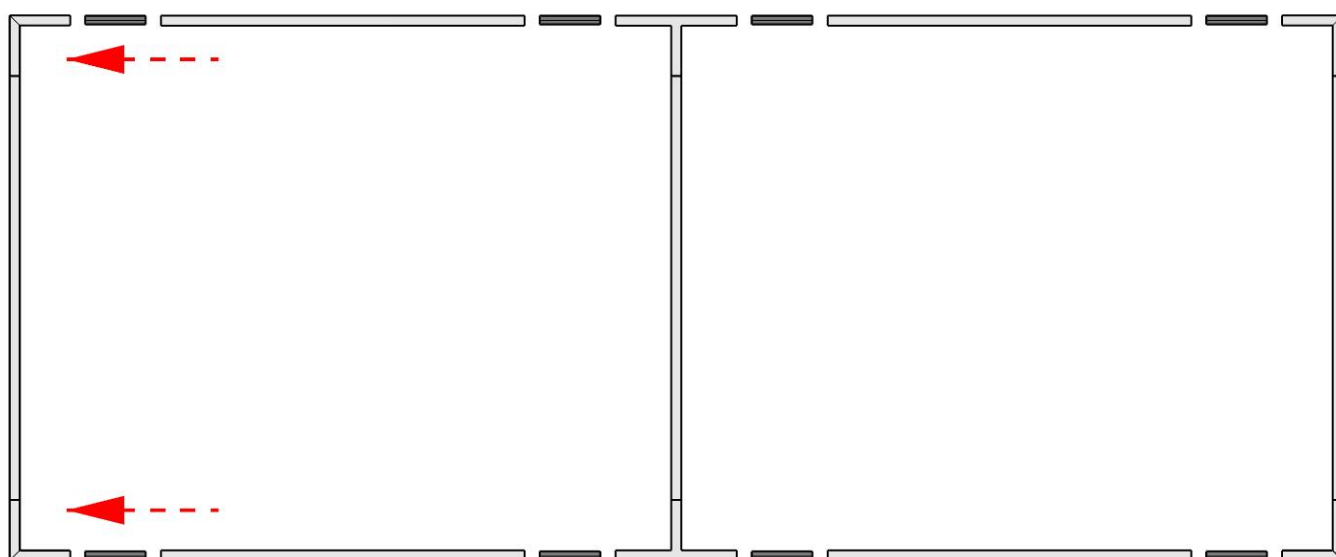

8

After all frame parts are connected, **FULLY TIGHTEN ALL FASTENERS.**

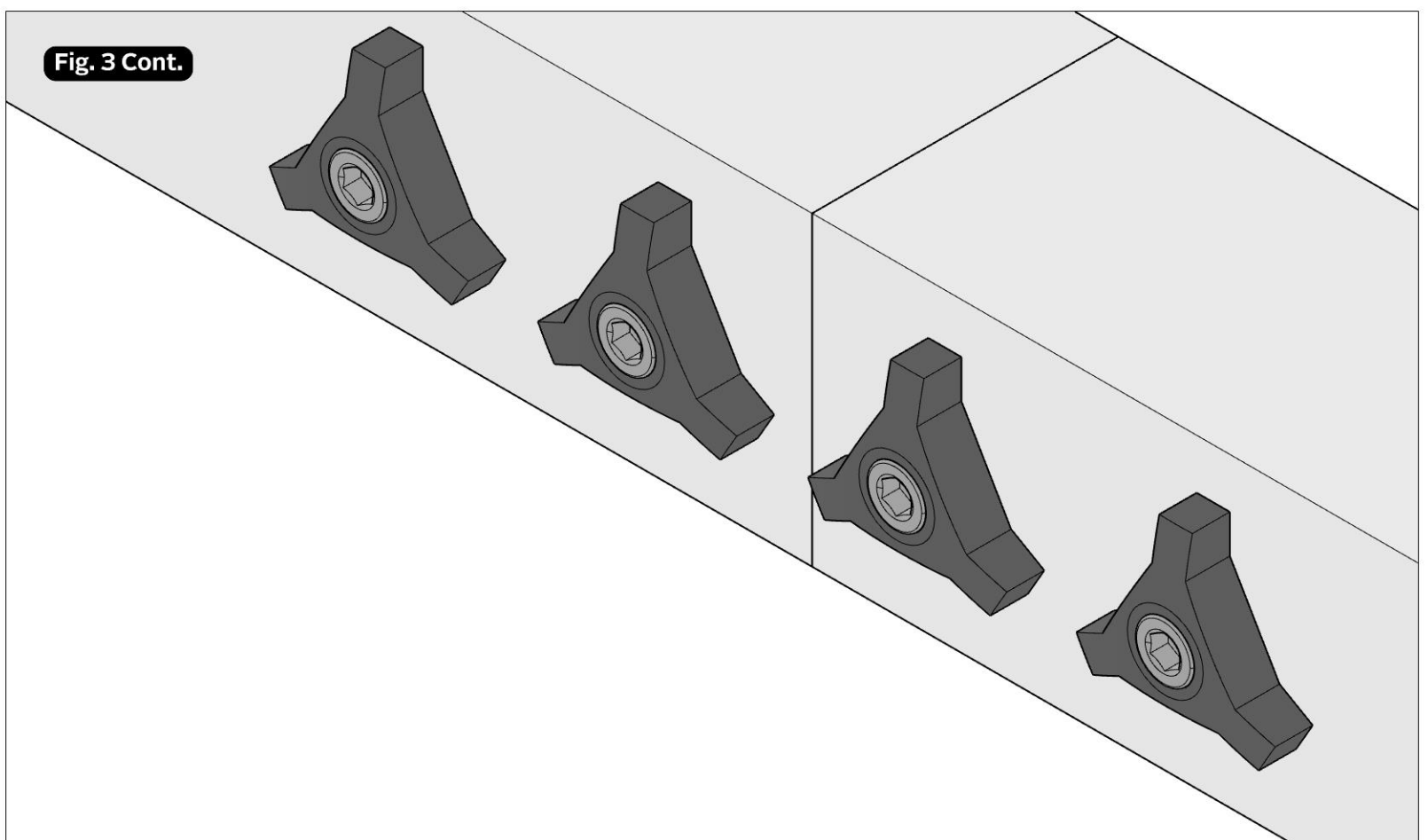
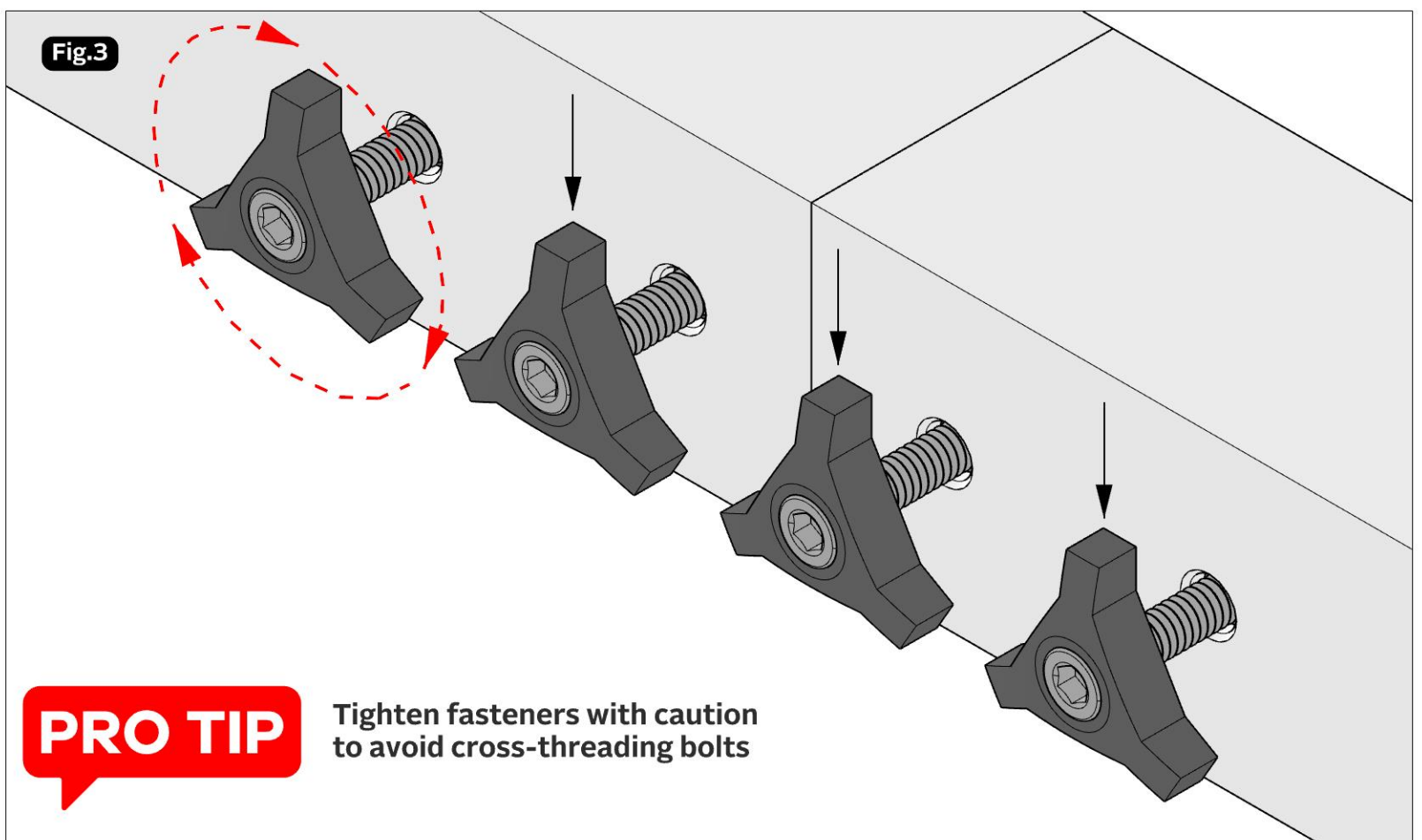
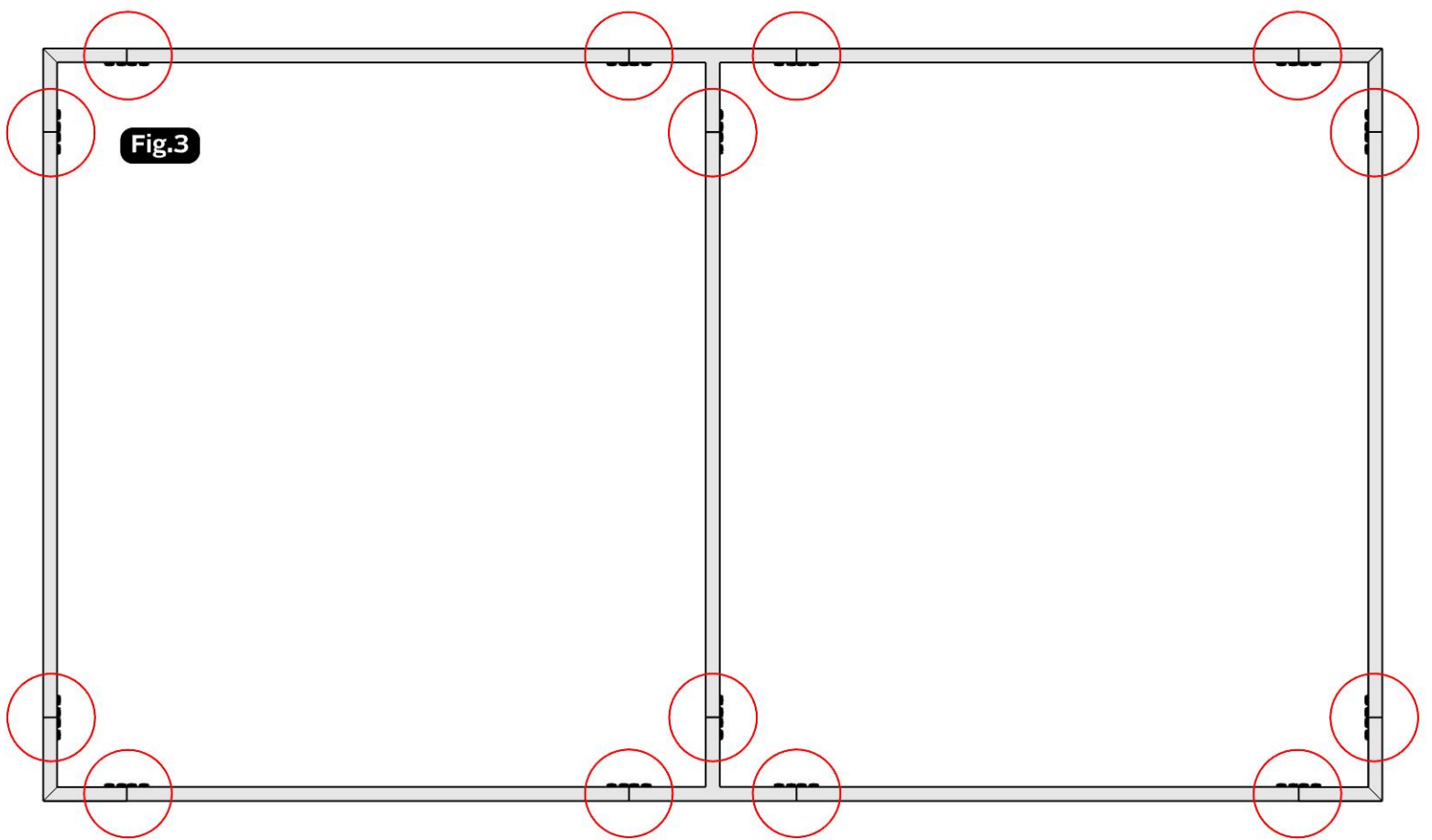

PRODUCT CONSTRUCTION

Fabric Application Tips and Tricks

To avoid smudges and dirt buildup on your fabric, always install the fabric using nitrile gloves. Consider using drop cloths or plastic sheeting on the floor to maintain a clean working environment free of debris.

Although we clean and coat our aluminum frames, quickly cleaning the frame with a towel or rag can help prevent stains on the fabric.



To properly install the fabric, insert the silicone keder edge so that the **SEWN EDGE** leads into the aluminium channel. See **FIGURE 1** below for correct installation method.

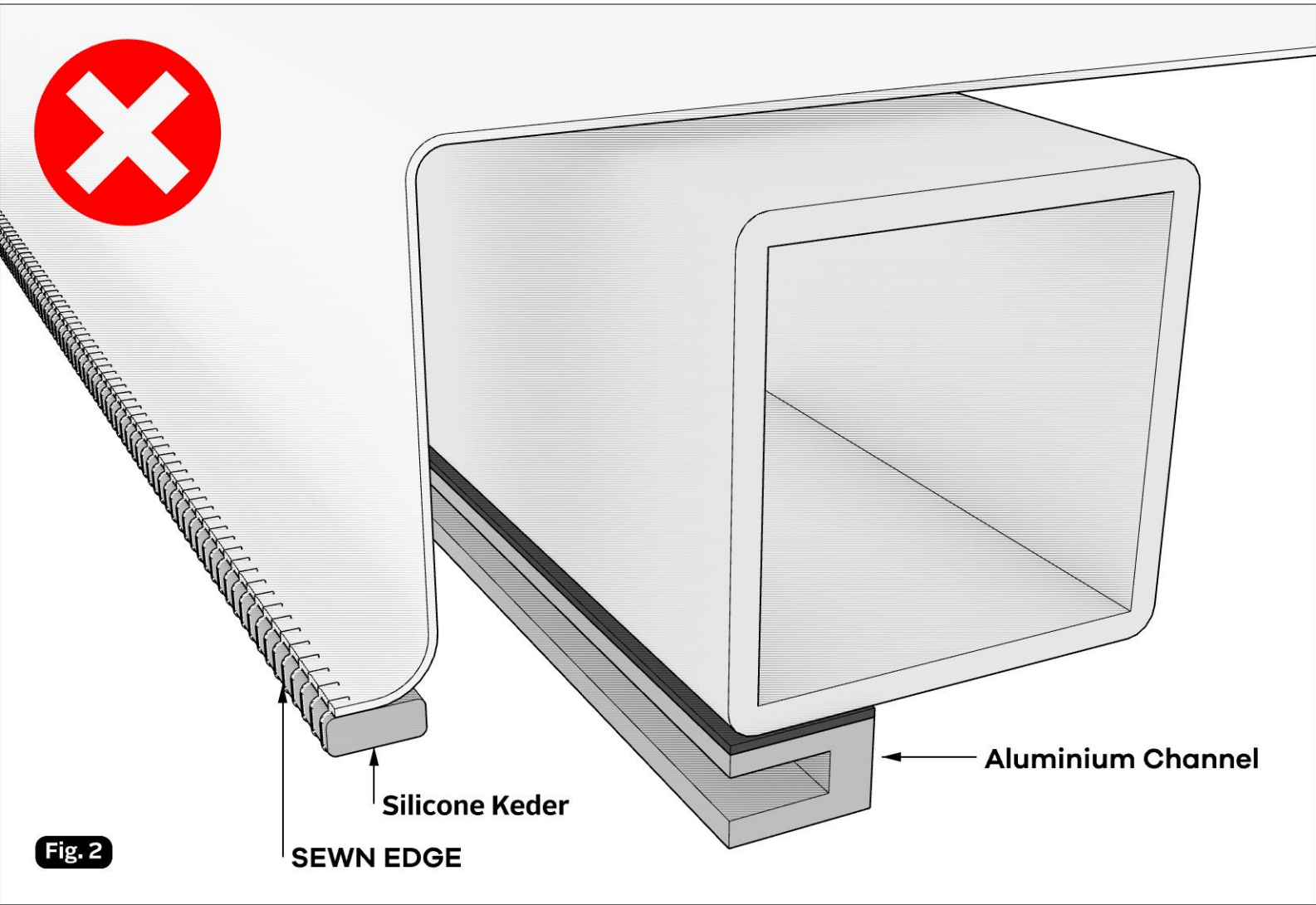
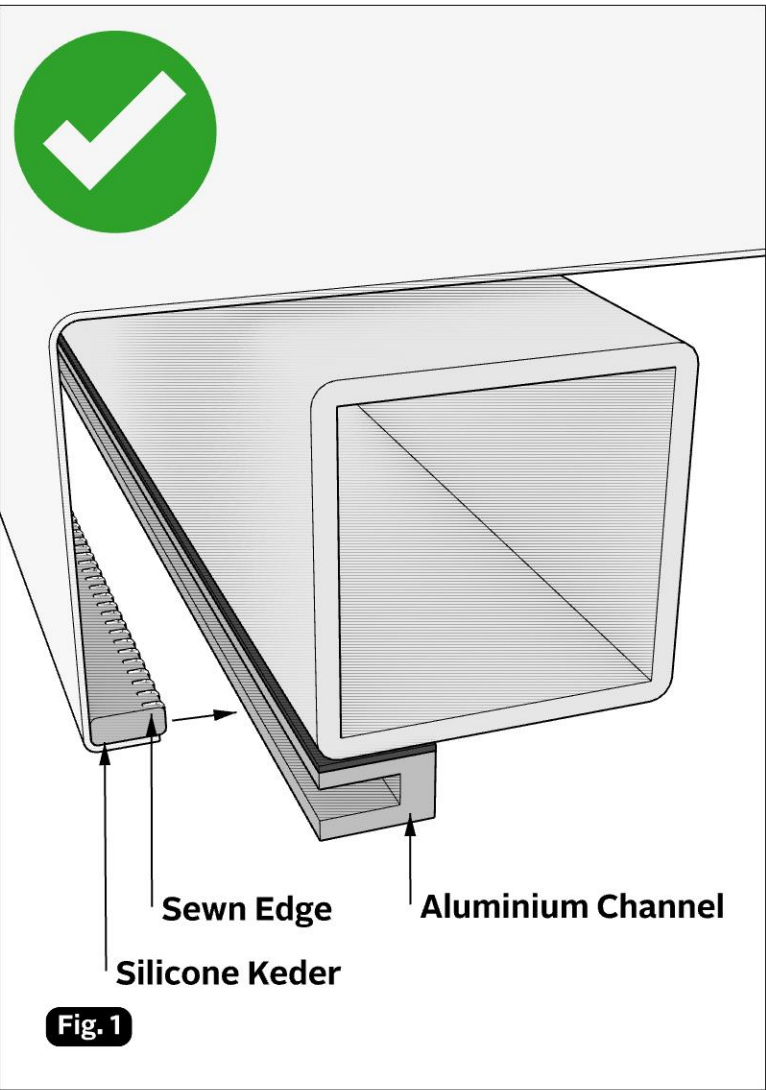

PRODUCT CONSTRUCTION

Fabric Application

- 1

Establish a clean working environment. Consider using drop cloths or plastic sheeting to maintain a debris-free surface. Put on your nitrile gloves.
- 2

Unpack your fabric skin and familiarize yourself with it. **If your fabric is Blockout (BOSF), the front surface is a matte fabric, and the back surface is a rubber coating.** The front goes onto the frame face up.

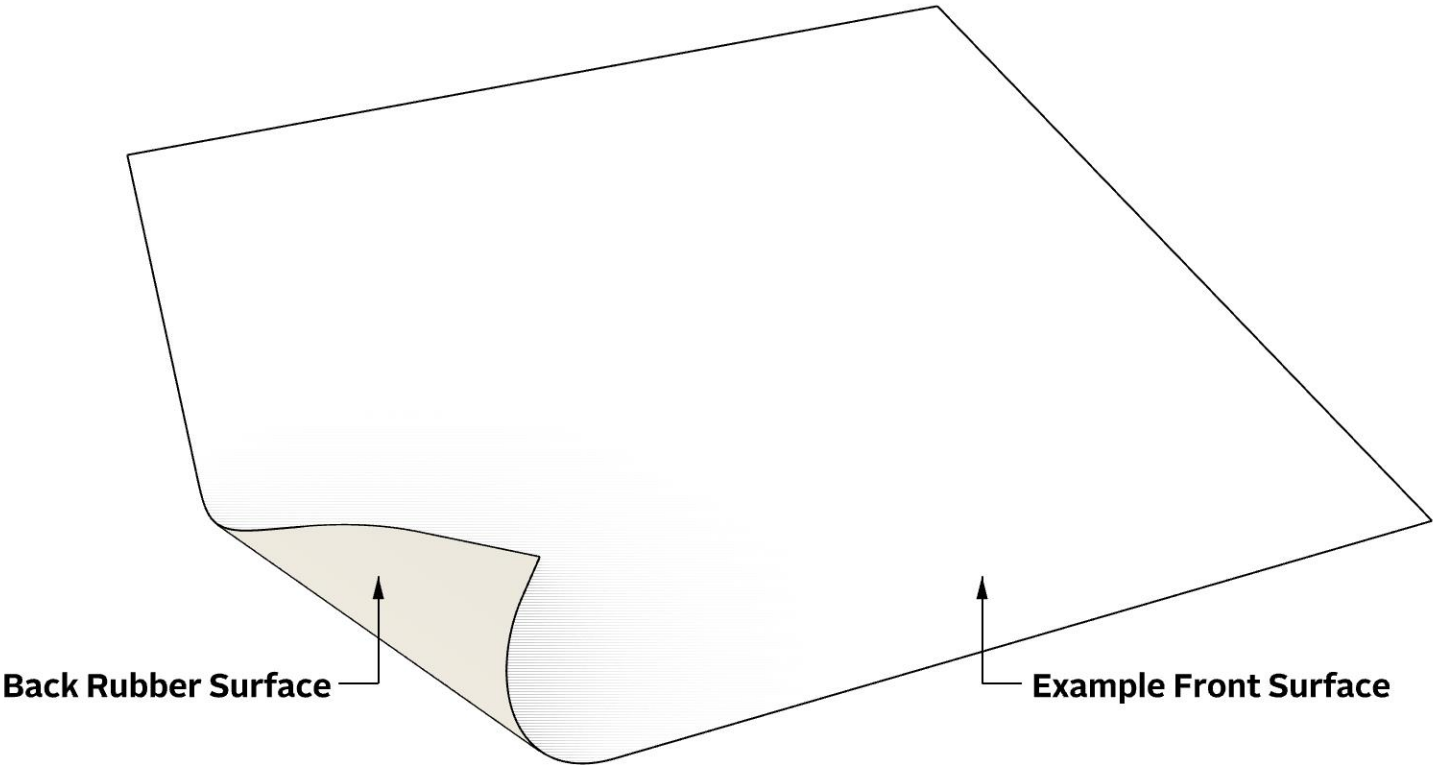

- 3

Lift your completed frame assembly onto an elevated working surface. **Saw-horses, wood blocks or road cases work are good options to use.**

PRO TIP

Work in a team of two or more people. This makes moving large frames easier.

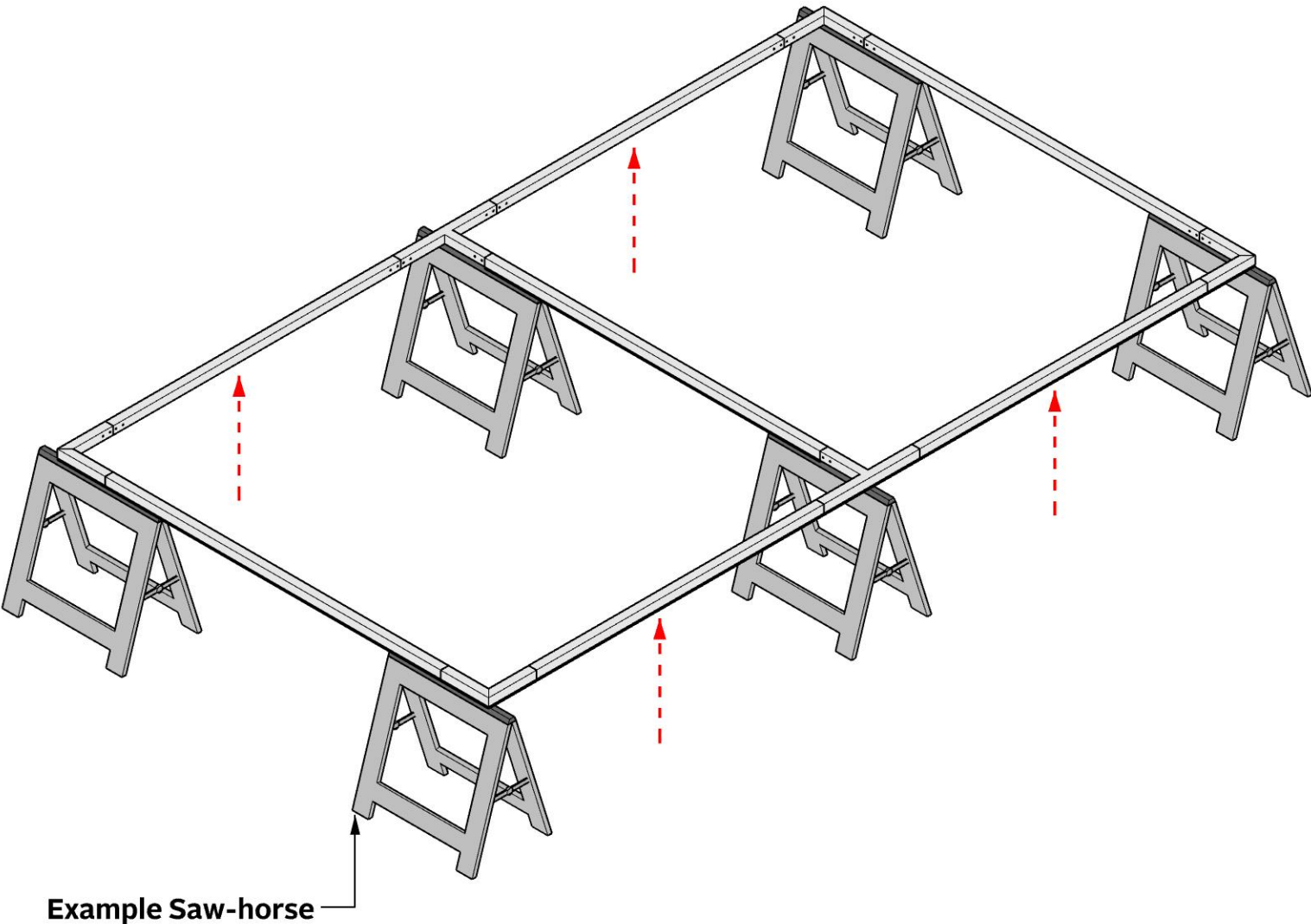

4

Locate a reinforced corner of your fabric and drape it onto the frame. Insert approximately 1 foot of the silicon keder edge into the frame's aluminium channel on each side of the corner.

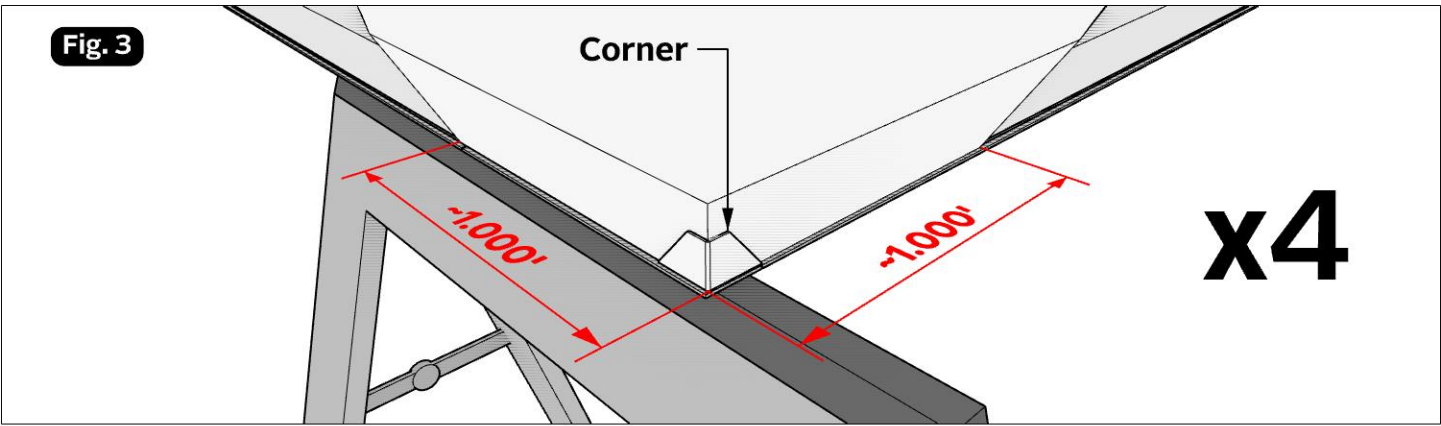
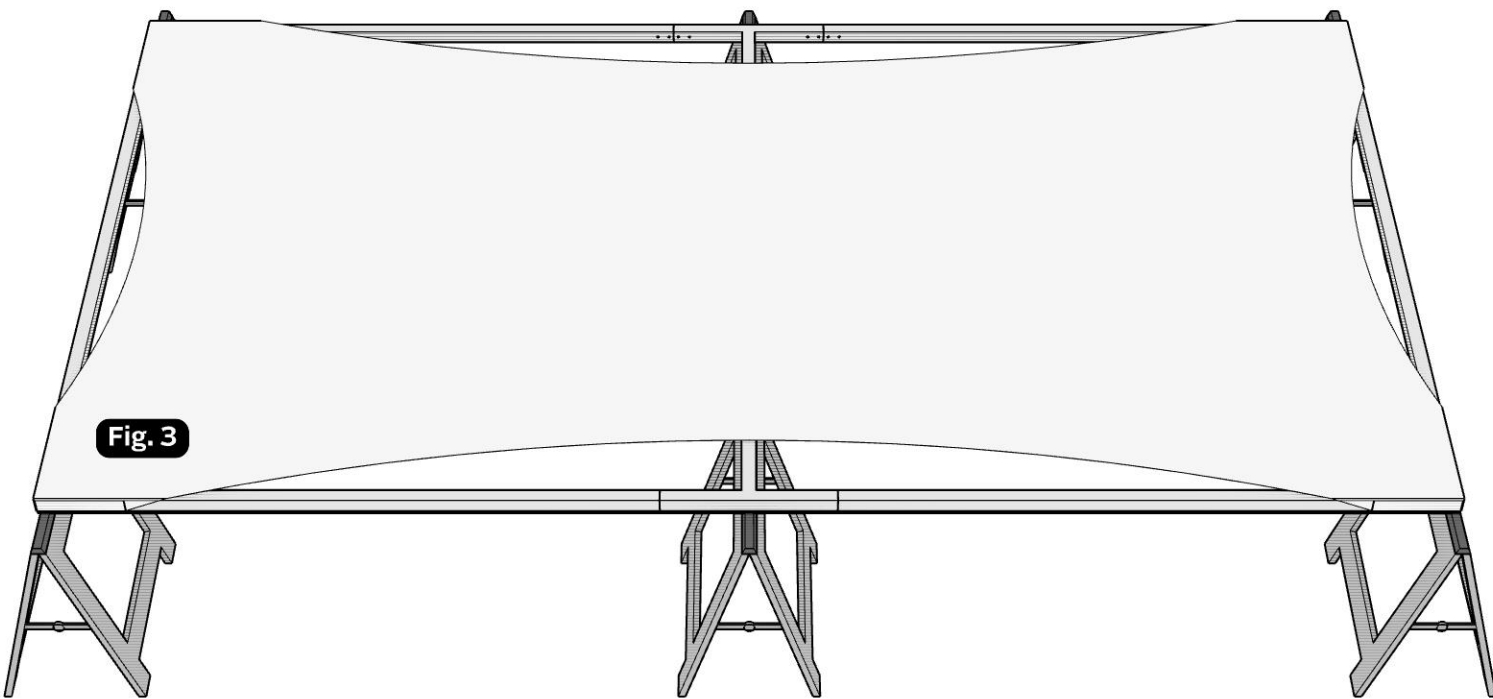

5

Insert ~1-2 feet of the silicone edge into the middle of the shortest sides.

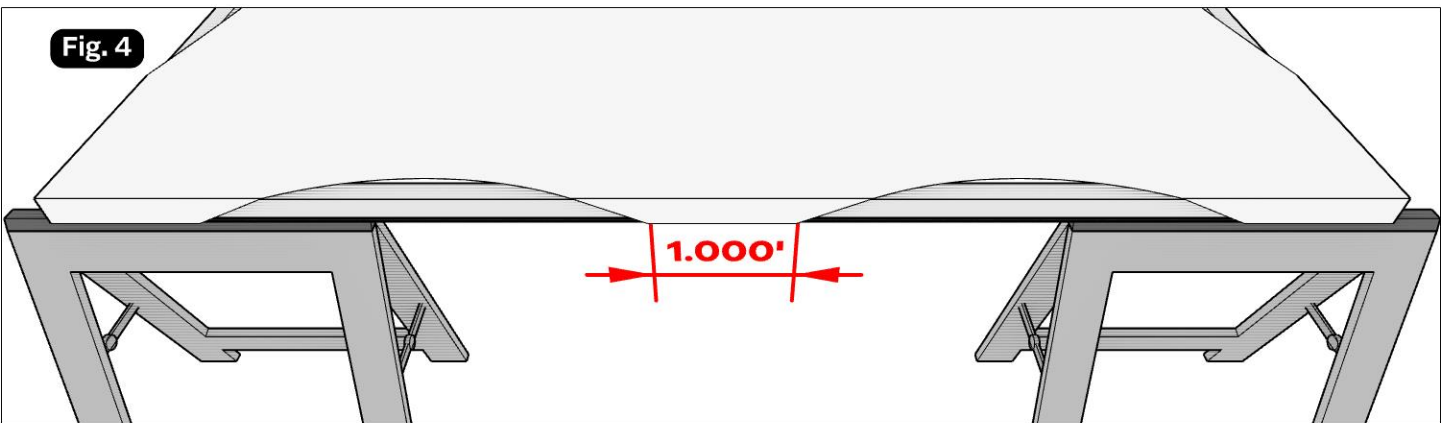
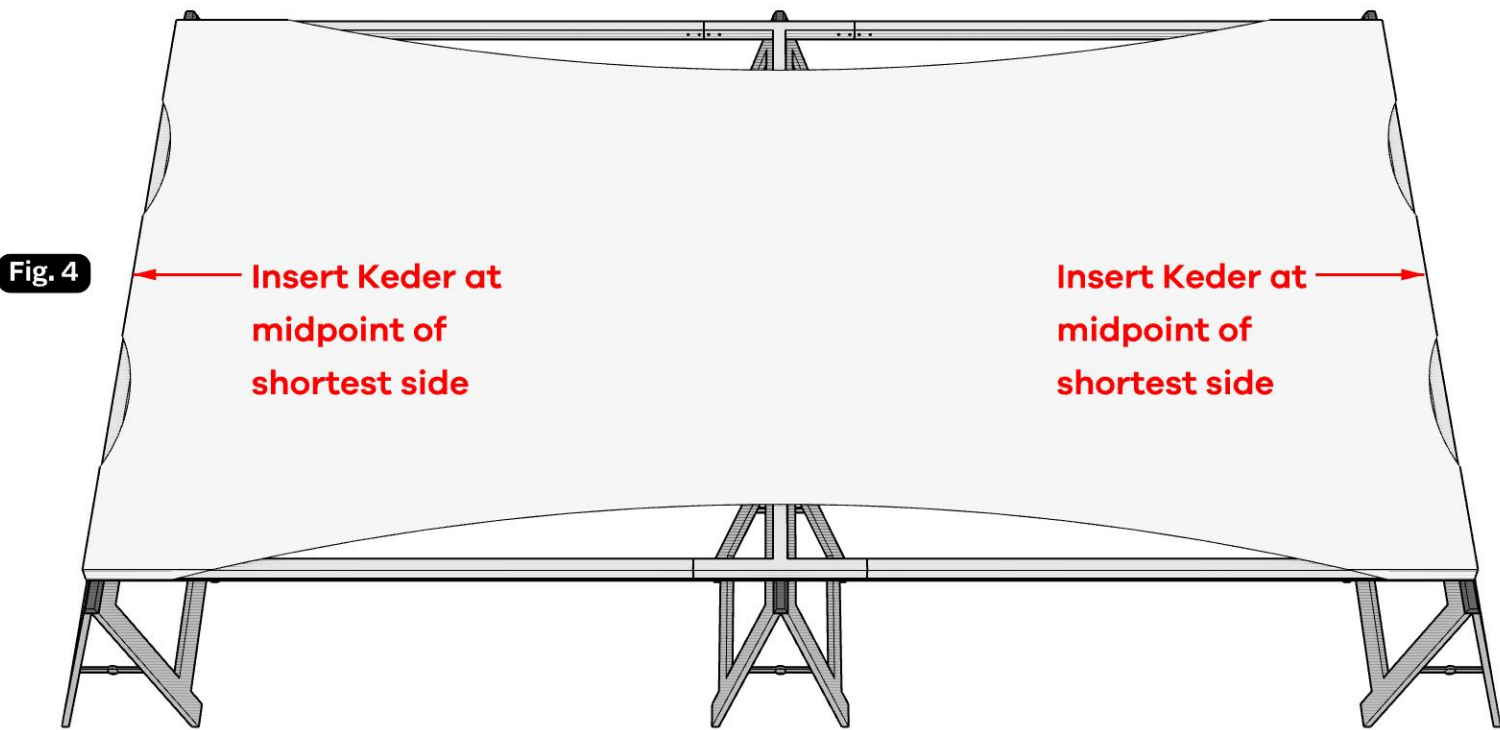

6

Finish installing the silicone keder onto the shortest edges of the frame. This can be easily accomplished by bisecting the loose edges and inserting them into the aluminium channel.

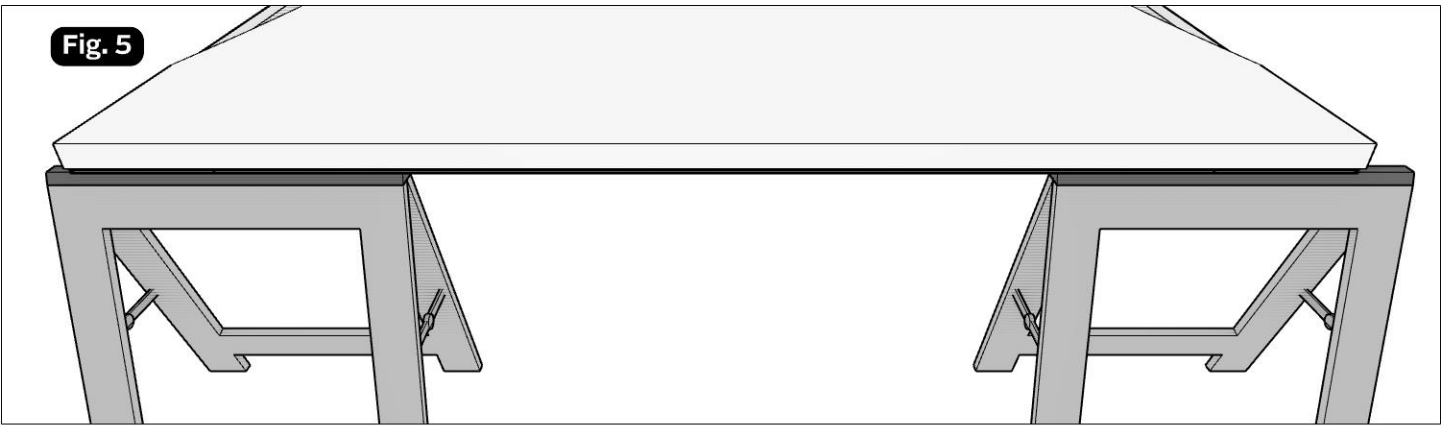
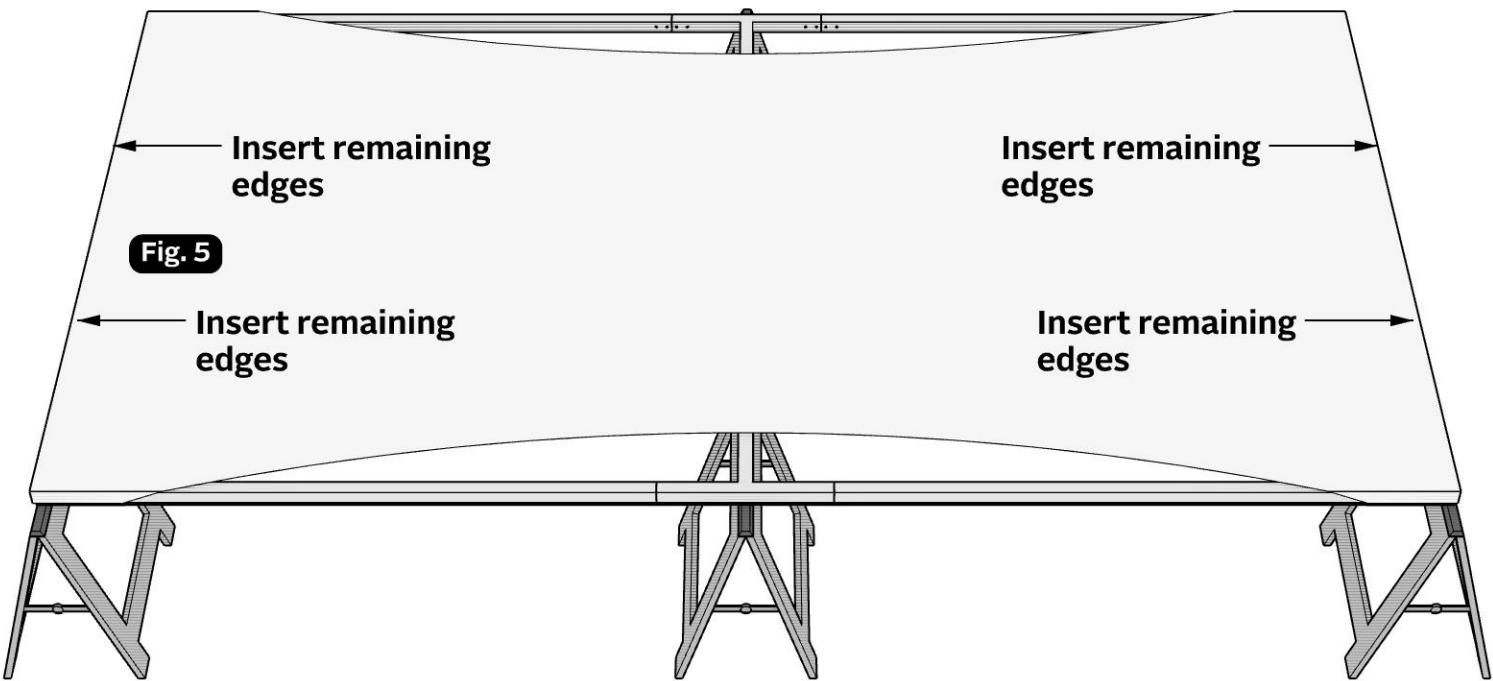

7

Repeat steps 5+6 on the longer edges of your BPS skin. Start by inserting the corners, then the midpoints, and finish each long edge by bisecting the skin.

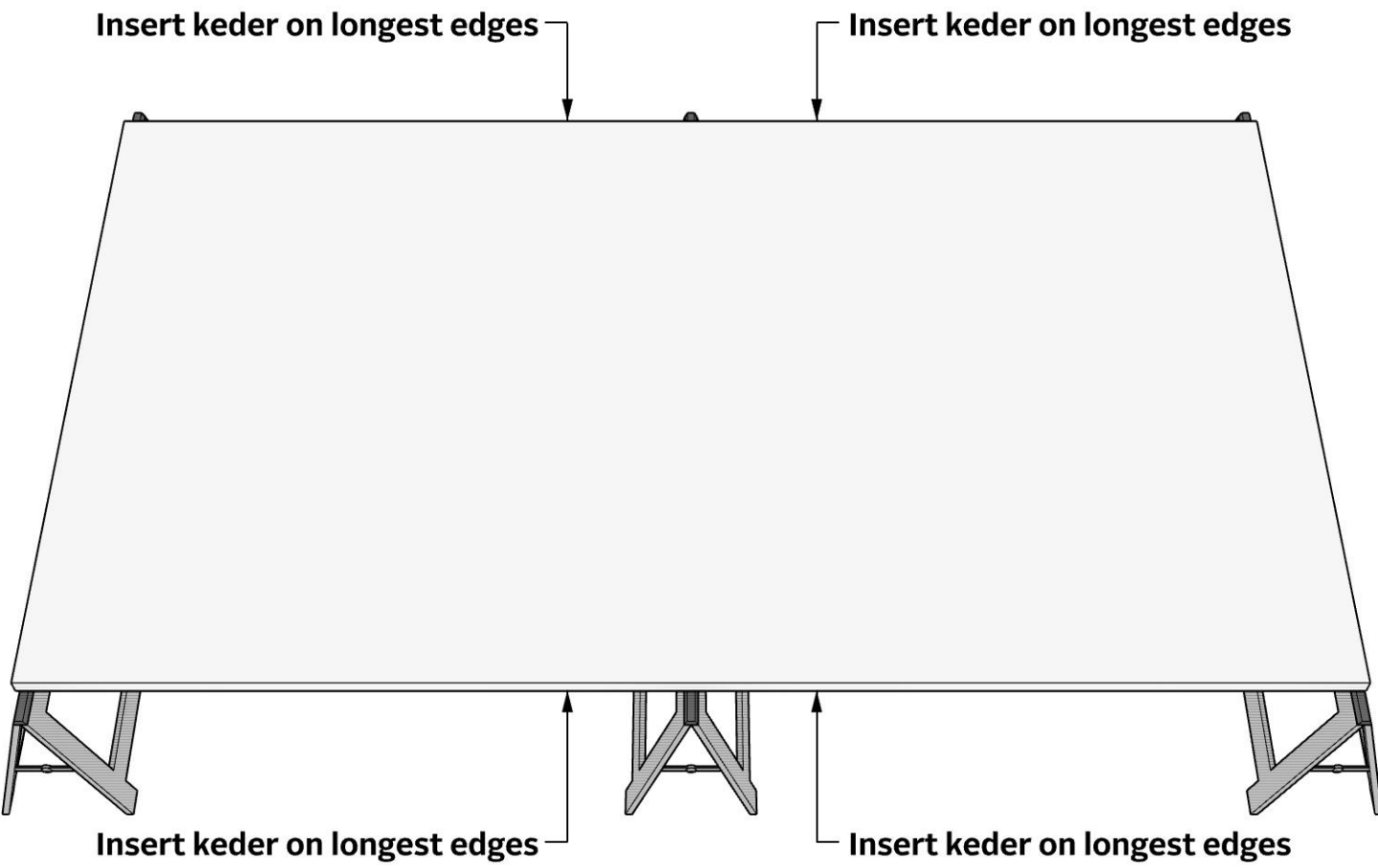

8

Do a final check around the perimeter of the frame. Ensure that all of the silicone keder edge has been completely inserted into the aluminium channel properly. (See page 7 - Fig. 1)

INSTALLATION

Rigging and Installation Notes

Each borderless system frame is fabricated with M10-threaded rivet nut inserts to optimize installation and rigging options. **Inserts are located on the back of the frame on all junctions and segments.** These are designed to recieve a variety of heavy-duty rigging hardware such as eyebolts, truss clamps, hoist rings, etc.

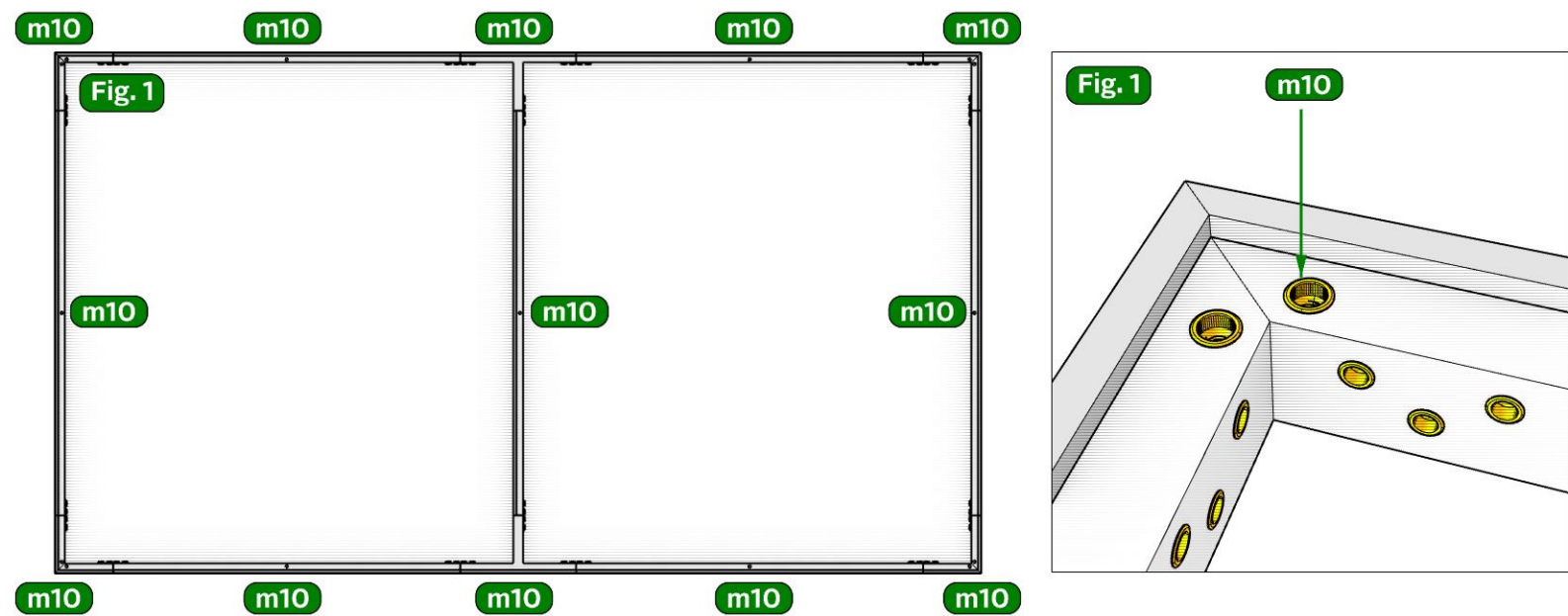

When aerial rigging a borderless system frame, hang frames perpendicular to attachment points (Fig.2).
DO NOT attach rigging equipment at an angle (Fig.3).

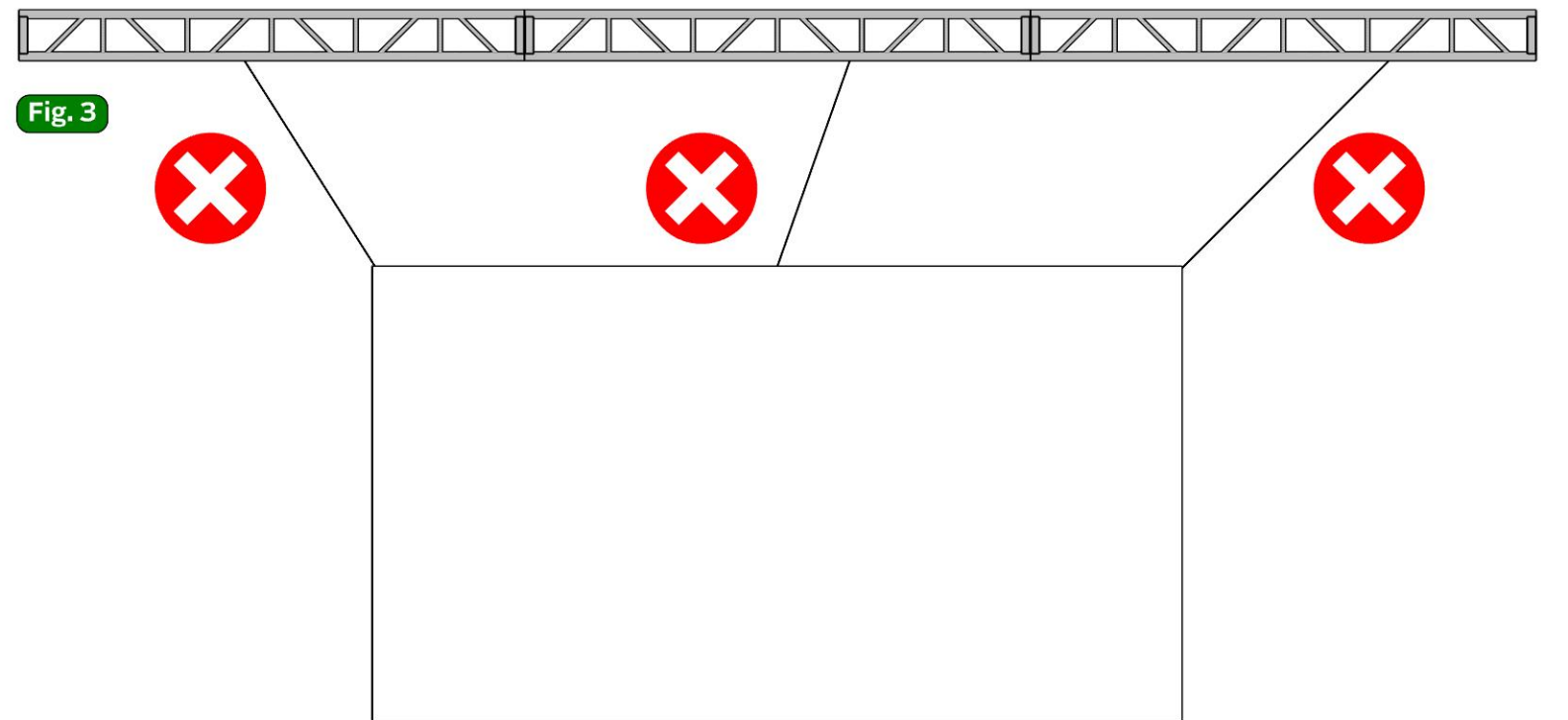
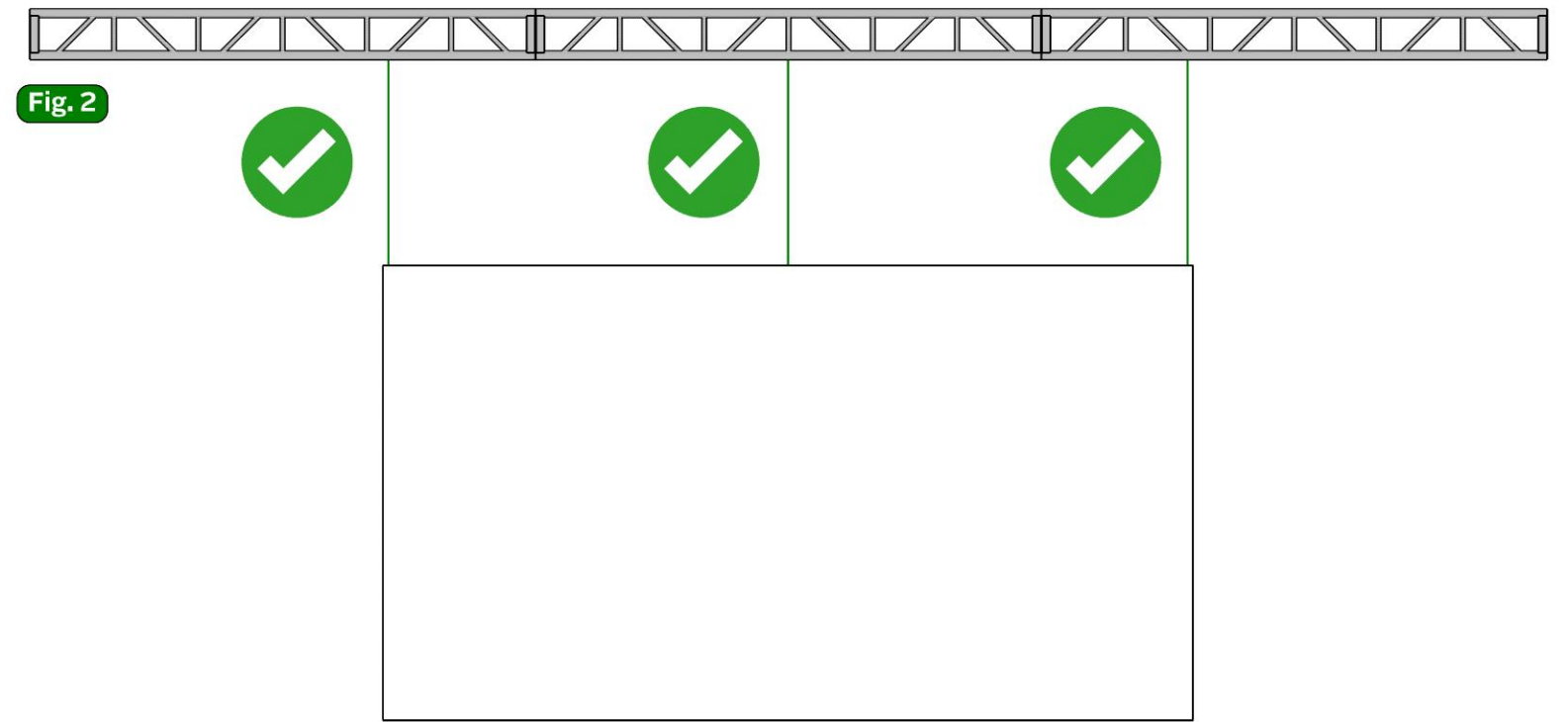

RIGGING HARDWARE OPTIONS

M10 Aerial Rigging Eye

These stout rigging eyes come standard with your Borderless Frame for aerial rigging capabilities.

- 1. Thread your m10 aerial rigging eye into the threaded insert above each vertical support on your frame.
- 2. Attach your rigging method of choice to the m10 aerial eye.

Fig. A



Fig. B



RIGGING HARDWARE OPTIONS

Top Hang Brackets

Custom fabricated rigging hardware that allow your Borderless System frame to hang perfectly plumb. They utilize the included m10 aerial eye.

1. At the top of your frame system's vertical struts, insert the included M10 bolt through the hole on the bracket's longer side.
2. Place the provided aluminium standoff over the threaded end of the M10 bolt, and thread the assembly into M10 rivet nut insert on the frame.
3. Tighten the bolt until snug using a 6mm or 7/32" hex wrench.
4. Use the top 3/8" diameter opening to connect rigging hardware of your choice, or use your M10 rigging eyes with the provided nut & washer.

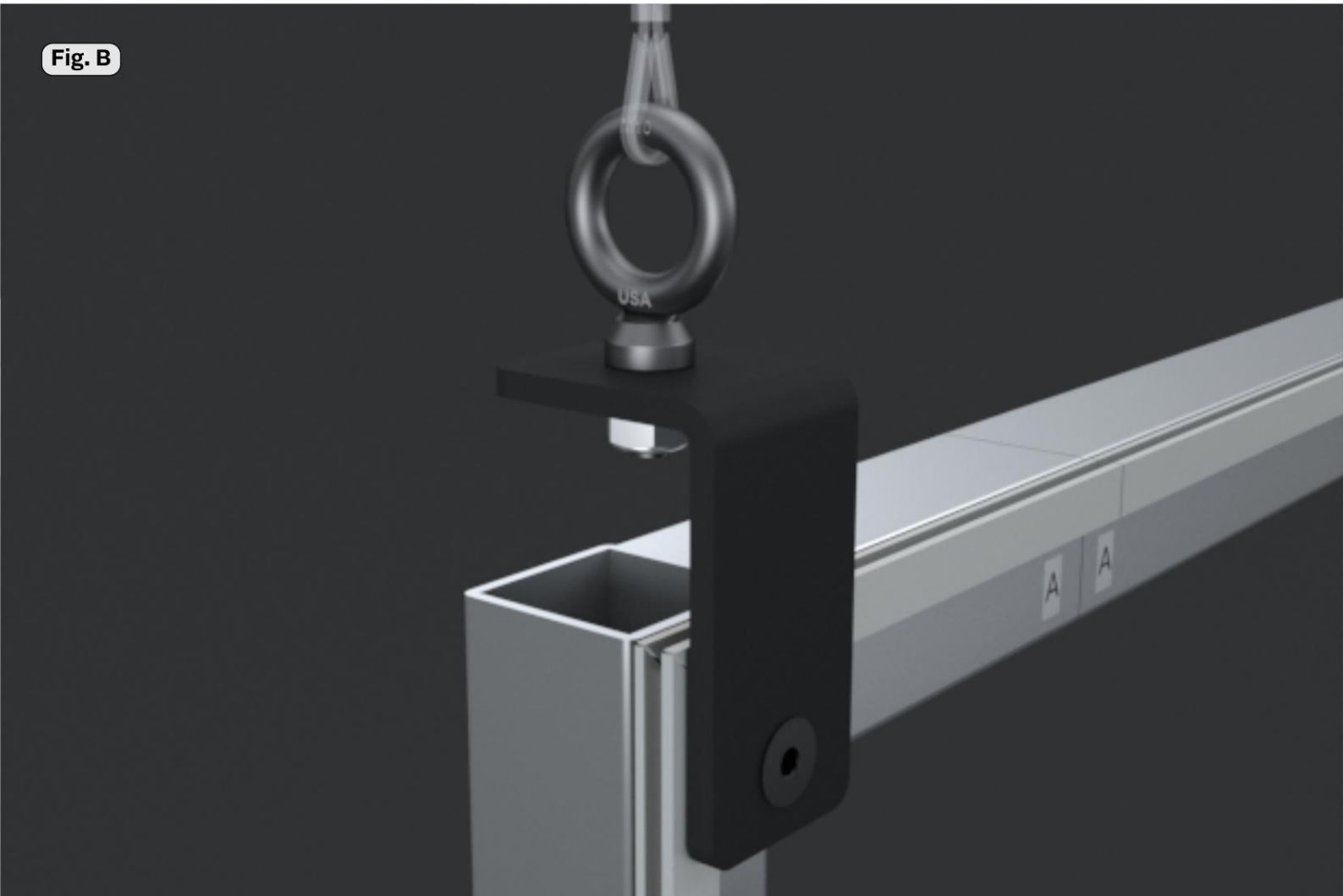
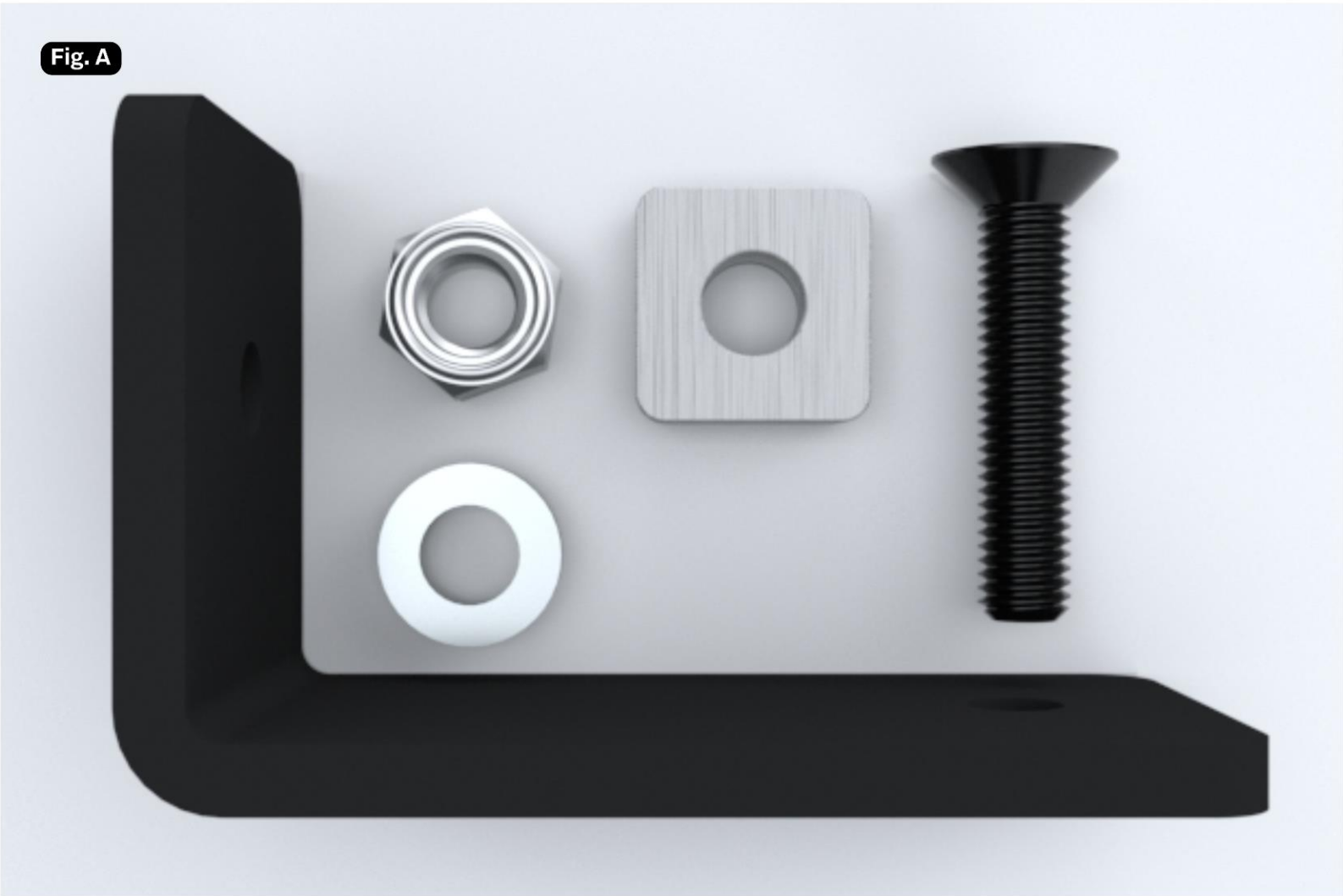

RIGGING HARDWARE OPTIONS

Borderless System Pro Clamps

These clamps adapt your Borderless Frame for direct-to-truss mounting. Designs shown are for attaching to round tube on imperial and metric truss.

- 1. Thread the included M10 bolt through the body of the pro clamp.
- 2. Place the provided aluminium standoff over the threaded end of the M10 bolt, and thread the assembly into M10 rivet nut insert on the frame.
- 3. Tighten the bolt until snug using a 6mm or 7/32" hex wrench.
- 4. Open the mouth of the clamp and attach it to your truss or tube. When your frame is in the desired position, close the mouth of the clamp and tighten the wingnut until snug.

Fig. A

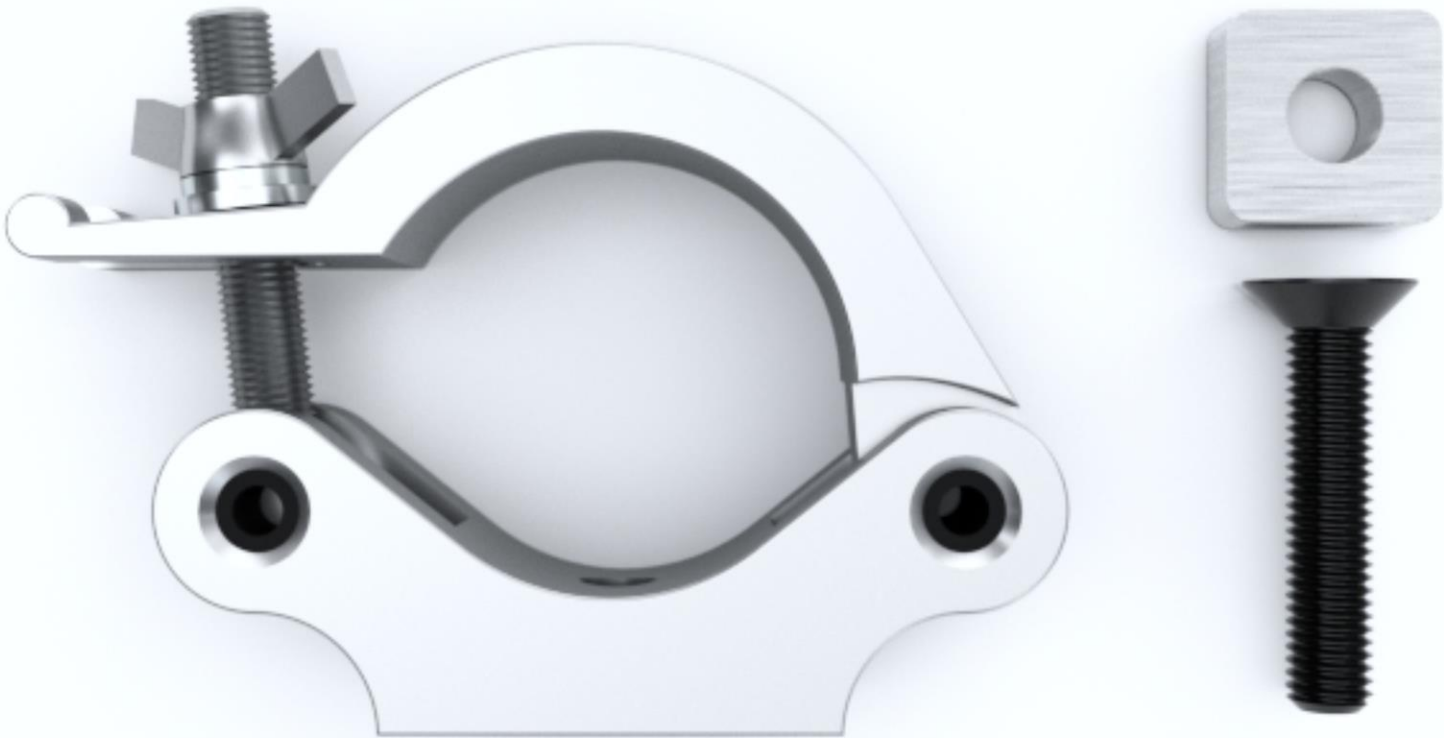
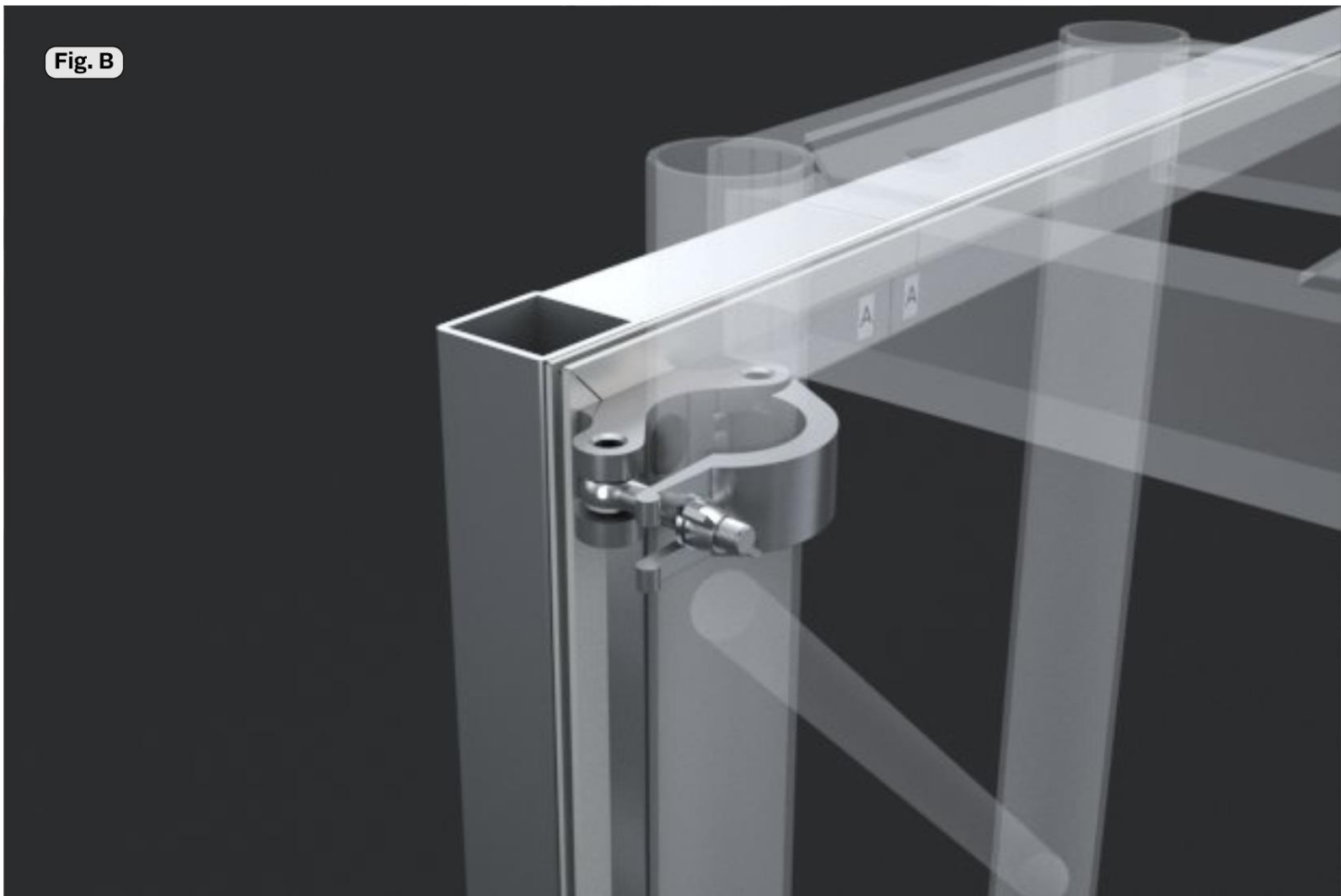

Fig. B



RIGGING HARDWARE OPTIONS

Ground Mount Brackets

Custom fabricated rigging hardware that allows your Borderless System to free stand by mounting to any standard pipe and drape base plate.

1. Locate the three additional 1/4-20 rivet nut inserts at the bottom/inside of your frame system verticals.
2. Using the provided 1/4-20 hex head bolts, attach your ground mount brackets to the frame. The bracket should extend out and down towards the bottom of the frame. Tighten the bolts using a 6mm or 7/16" wrench.
3. Lift and lower your frame onto the base plates so that the foot pins slide in to the ground mount bracket tubing.
4. Use the provided 3/16" hex wrench to tighten the set screws on the ground mount brackets.

 **DO NOT** tighten set screws before inserting pins. This will obstruct the pin.

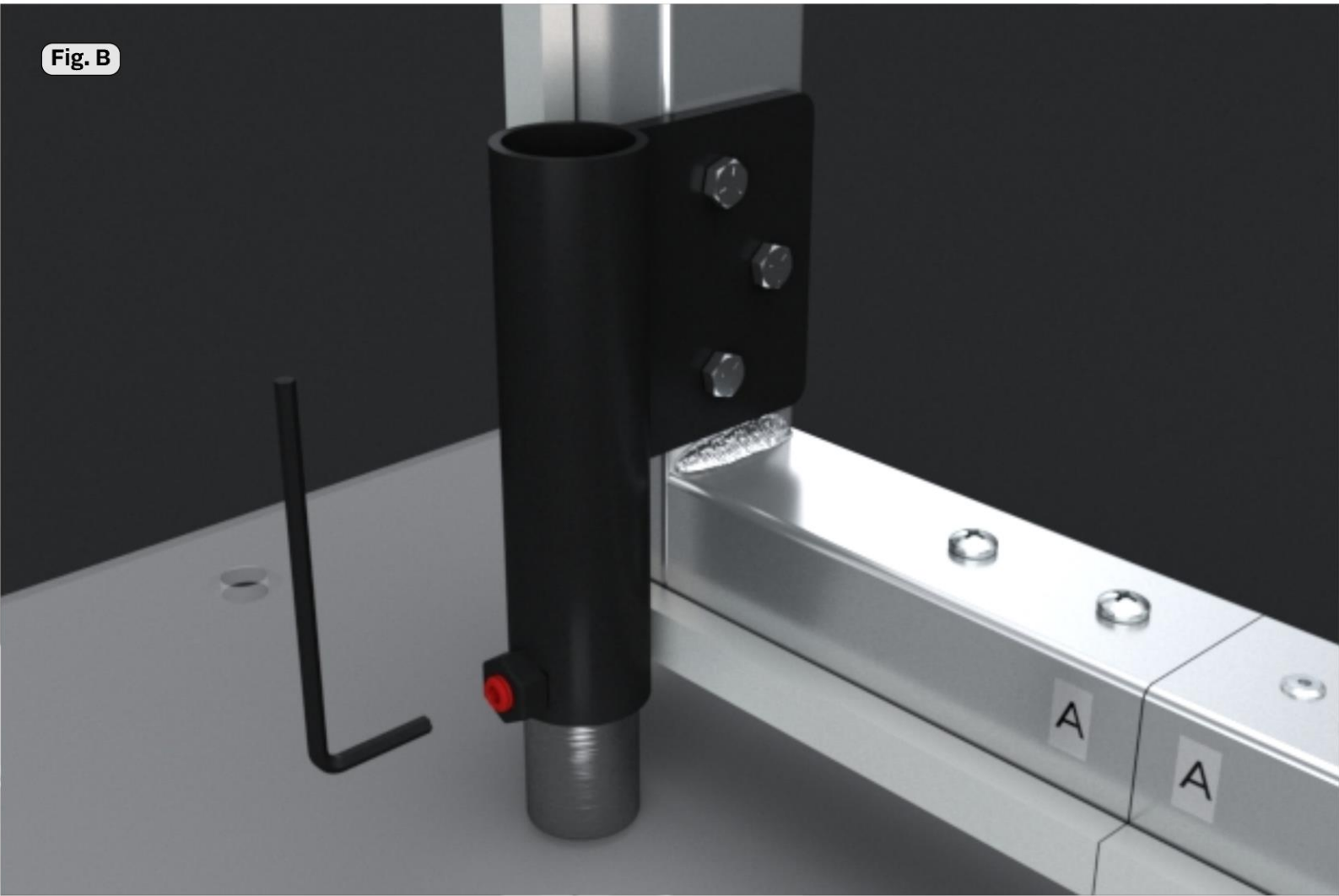

FABRIC CARE

BLOCKOUT STRETCH FABRIC (BOSF)

Storage Notes and Methods

Qualified orders include a cloth drawstring bag, which is ideal for long-term storage. When storing your fabric in a sealed container, like the plastic bag the skin arrived in, the fabric must be completely dry to avoid mold or mildew growth. Fold the fabric skin neatly, screen side in, avoiding tight creases. Place the fabric into the drawstring bag. Fabric can also be stored and transported in plastic totes or roadcases. Be sure to handle with care.

Cleaning and Dusting

Fingerprints from installation without gloves are the main culprit of a dirty screen. Follow the setup instructions carefully, and always use nitrile gloves when handling fabric skins.

Light clean: For light marks on the fabric, simply use the included Melamine Eraser to clean spots. Swipe side to side in the direction of the fabric grain. Avoid using circular motions when cleaning with a melamine eraser. Any excess debris from the cleaning process can be dusted away.

Deep clean: For more significant stains, wet a small section of a clean white paper towel with water or slightly soapy water (using dish soap). Wring out any excess water; the towel should just be damp and not dripping wet. Swipe from side to side in the direction of the fabric grain, lifting as much dirt as possible. Next, thoroughly dry the skin with a dry paper towel. Fabric will need to fully dry before it looks white again. If this does not remove the stain, use the same technique, but with Clorox Green Works spray.

Dusting: Projection screens and printed graphic panels may be left up over long periods of time indoors. Dust will inevitably stick to the surface and collect over time. To remove dust on fabric, use a clean object to lightly bat the back surface. Start at the center of the fabric and move towards the outer edges. Continue this process until the dust has been completely removed.



DO NOT machine wash your projection screen or printed graphic panel. DO NOT use a vacuum, broom, or other cleaning device on the surface of the fabric.



MOSS

WE ARE PLACE MAKERS™

FABRIC CARE

UNIVERSAL STRETCH FABRIC (USF)

Storage Notes and Methods

Qualified orders include a cloth drawstring bag, which is ideal for long-term storage. When storing your fabric in a sealed container, like the plastic bag the skin arrived in, the fabric must be completely dry to avoid mold or mildew growth.

If your product includes any metal parts such as gate ring, rigging supplies, or frames, be sure to remove them prior to storage. Wrinkles can result from fabric storage. Almost all wrinkles from storage will stretch out once the fabric is installed correctly. If deep wrinkles persists, place fabric in a dryer on low heat for a few minutes.

Cleaning and Dusting

Light clean: Fingerprints from installation without gloves are the main culprit of a dirty screen. Follow the setup instructions carefully, and always use nitrile gloves when handling fabric skins. To remove light stains, use hot soapy water and dab the area clean.

Deep clean: Machine wash fabric on delicate with detergent and Oxiclean®. Machine dry on low heat, regularly checking for completion. IFR products dry quickly. All USF products will retain IFR (Inherently Flame Retardant) certification after repeated washes.

Dusting: We understand that many of our products may be left up over long periods of time. Dust will inevitably stick to the surface and collect. To remove dust on fabric, use a clean object to lightly bat the back surface. Start at the center of the fabric and move towards the outer edges.



DO NOT OVER DRY. Extended heat will damage the spandex in the fabric material.



DO NOT USE BLEACH or bleach-based cleaners on USF fabric. Bleach will damage the spandex in the fabric.



MOSS

WE ARE PLACE MAKERS™

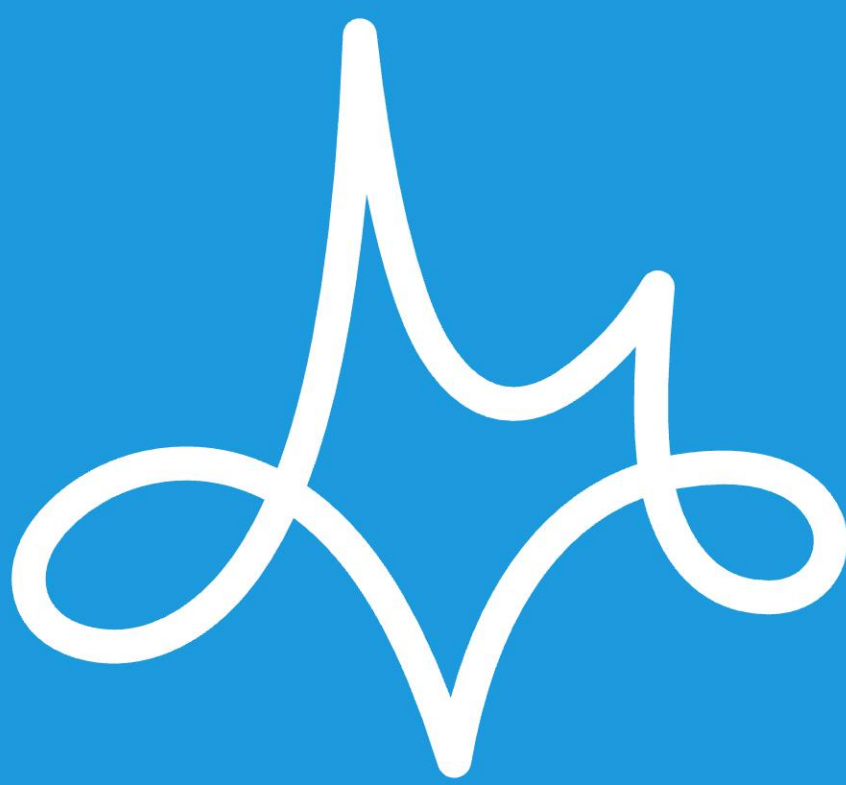

MOSS

WE ARE PLACE MAKERS™