

2D FORMS

FABRIC COVERS AND ROUND-TUBE FRAMES

INSTALLATION & MAINTENANCE GUIDE

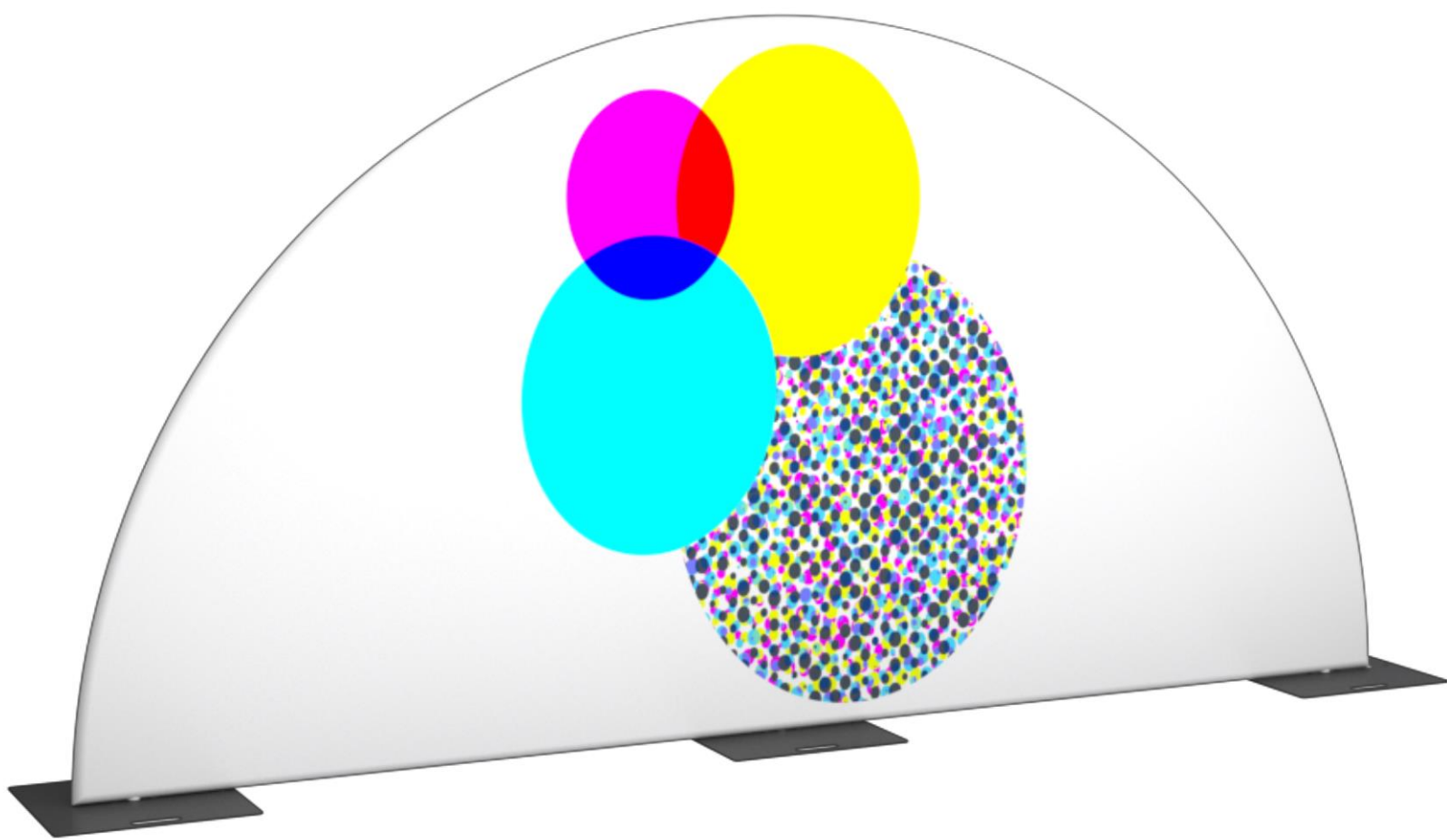
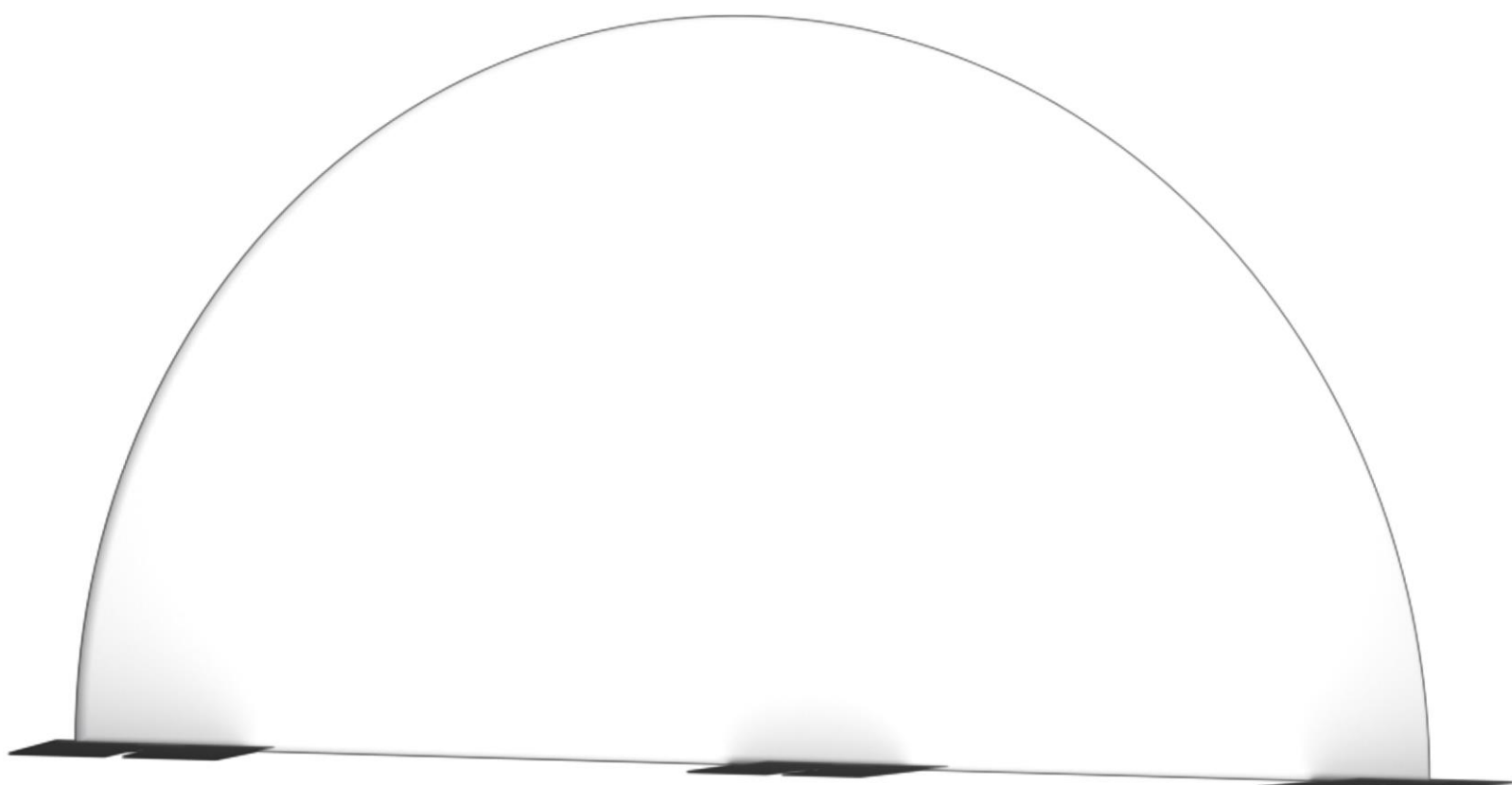

INTRIGUE YOUR AUDIENCES WITH AN ENVIRONMENT THAT USES
UNIQUE SHAPES



MOSS
WE ARE PLACE MAKERS™

TABLE OF CONTENTS

- 1.0 Before You Build.....3**
 - Proper Fabric Handling.....3
 - Included Parts and Recommended Tools3

- 2.0 Product Construction 4 - 14**
 - Frame Assembly Instructions4 - 8
 - Fabric Tips and Tricks9
 - Fabric Application Instructions10 - 14
 - i. Ground Mount Foot Pins with Set Screws13
 - ii. 1/4-20 Aerial Rigging Eyes14

- 3.0 Fabric Care..... 15**
 - IFR Storage notes and methods.....15
 - IFR Cleaning and fabric care15

Install questions?

Contact us. We are here to
help you succeed!

1.888.370.0202



BEFORE YOU BUILD

Proper Fabric Handling

To avoid smudges and dirt buildup on your fabric, always install your product using nitrile gloves. Even clean hands can leave an oily residue on the fabric surface that attracts dirt and dust. Additionally, consider using drop cloths or plastic sheeting on the floor to maintain a clean working environment free of debris.

Included in the Box



Nitrile Gloves

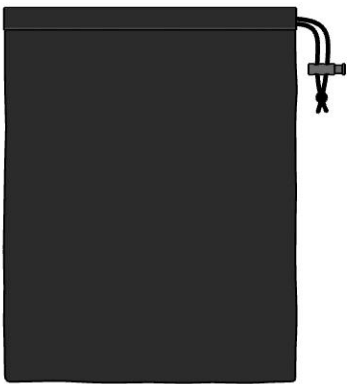

Storage Bag

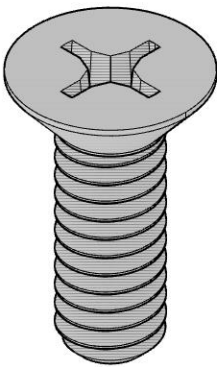

1/4-20 Fasteners

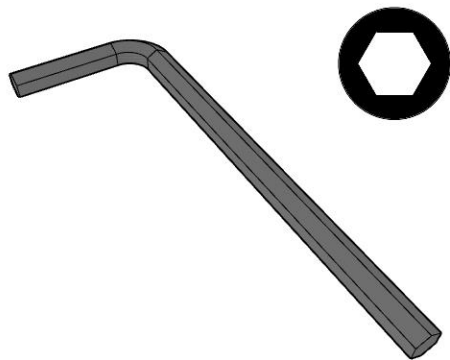

3/16" Allen Key - x1

For ground-supported frames

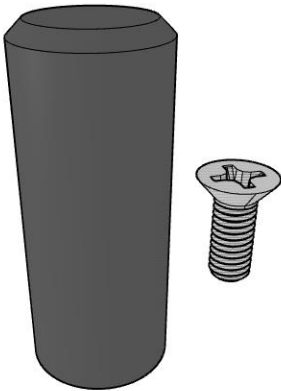

Foot Pin and Fastener

For ground-supported frames



1/4-20 Aerial Eye

For frames with aerial capabilities

Recommended Tools

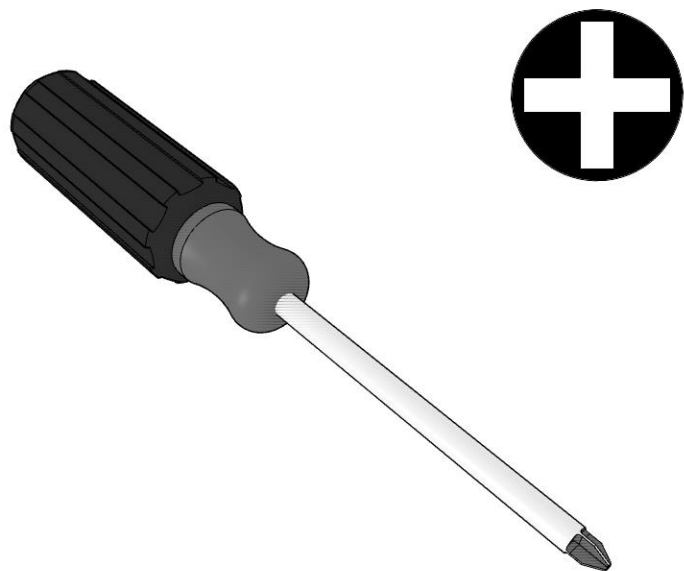

#3 Phillips Head Driver

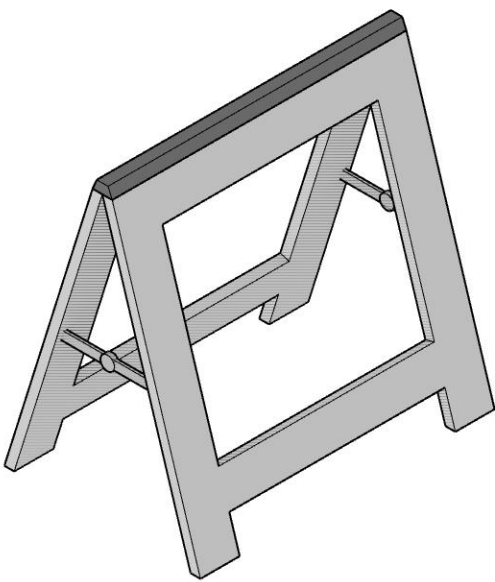

Sawhorses

PRODUCT CONSTRUCTION

Frame Assembly

1

Establish a clean working environment. Consider using drop cloths or plastic sheeting to maintain a debris-free surface.

PRO TIP

Carpeted floors work well for setup



2

Familiarize yourself with assembly labels. 2D Forms come with drawings that show how a frame is constructed. **Joints are labeled with letters.** **Each side of a joint has the same letter.**

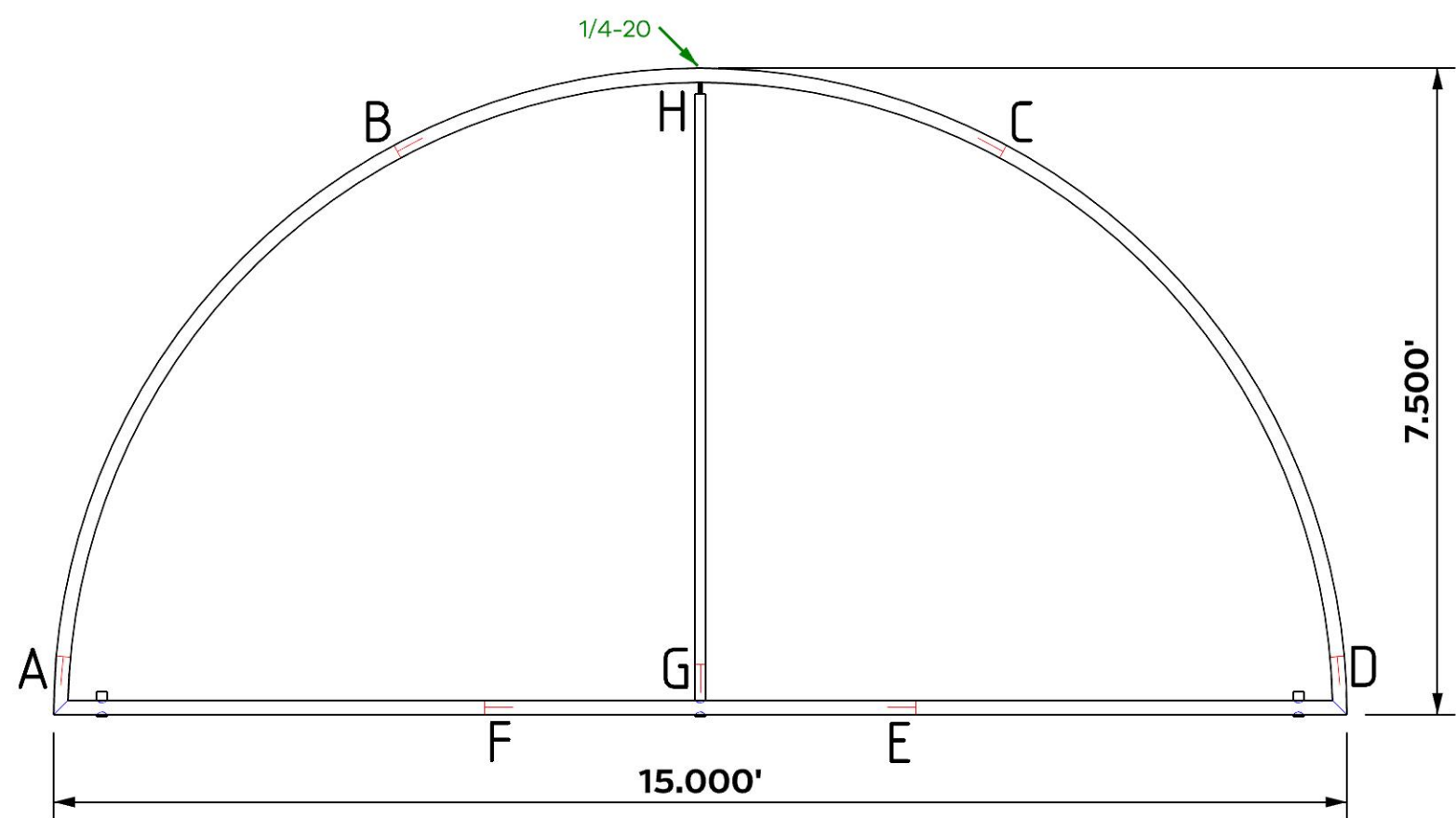

3

Organize your frame. Place each part on your clean surface, and match each joint label with its corresponding part (A+A, B+B, etc.). **Make sure the joint bolt holes on each part are facing up.**

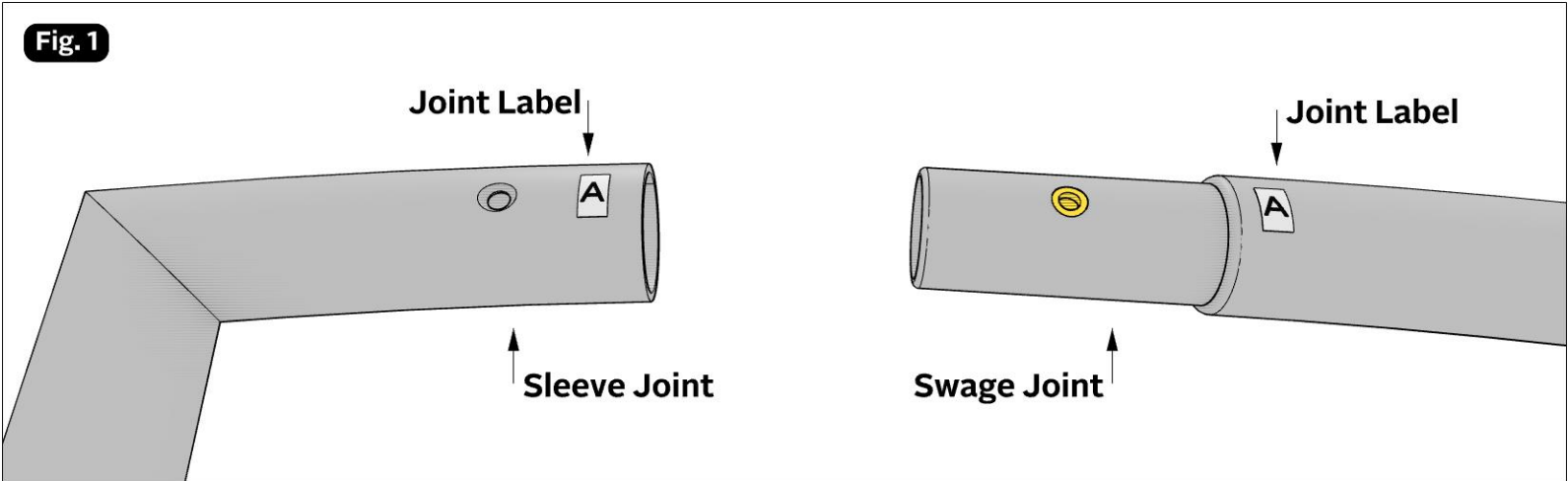
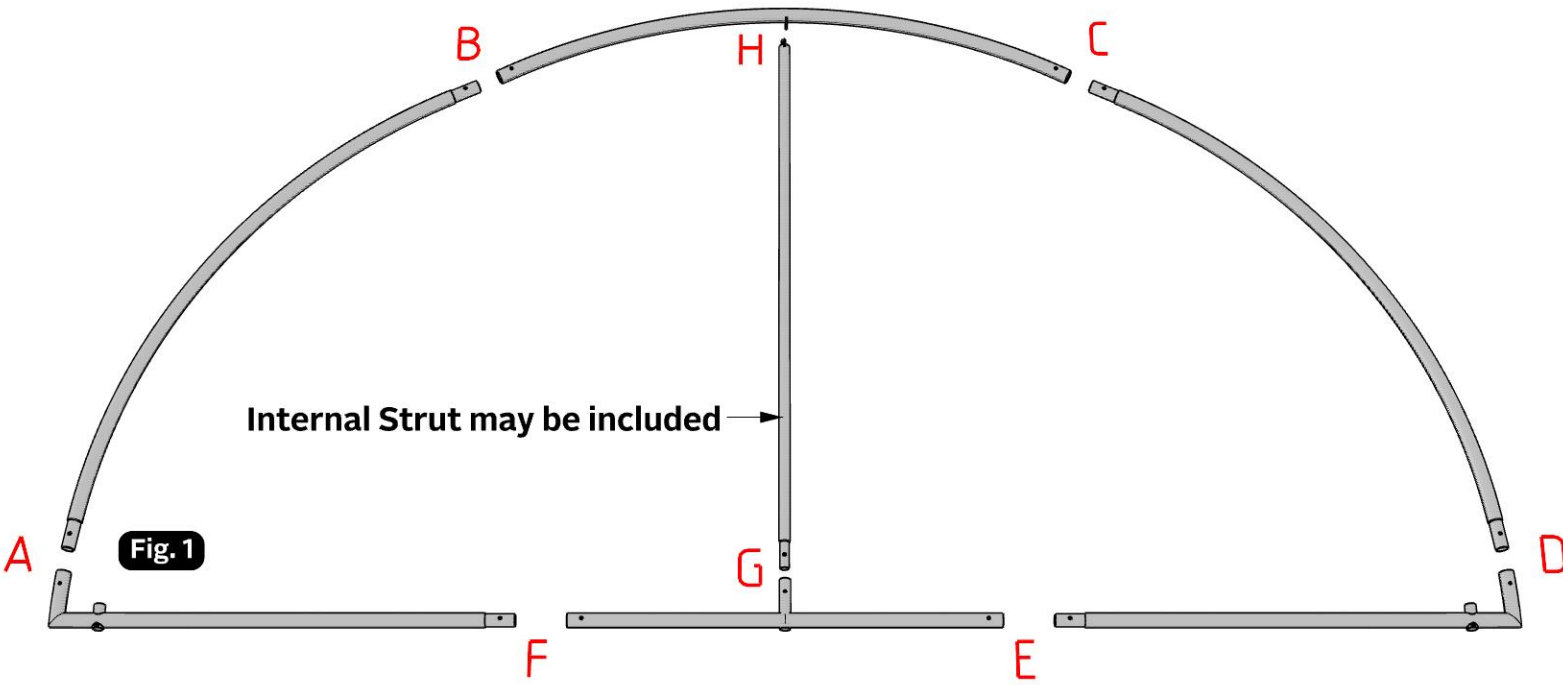

4

Connect all of the joints. Insert the swage joint (male) into the sleeve joint (female). If your frame includes internal struts, lay them near their welded tabs and/or connect their sleeve joints.

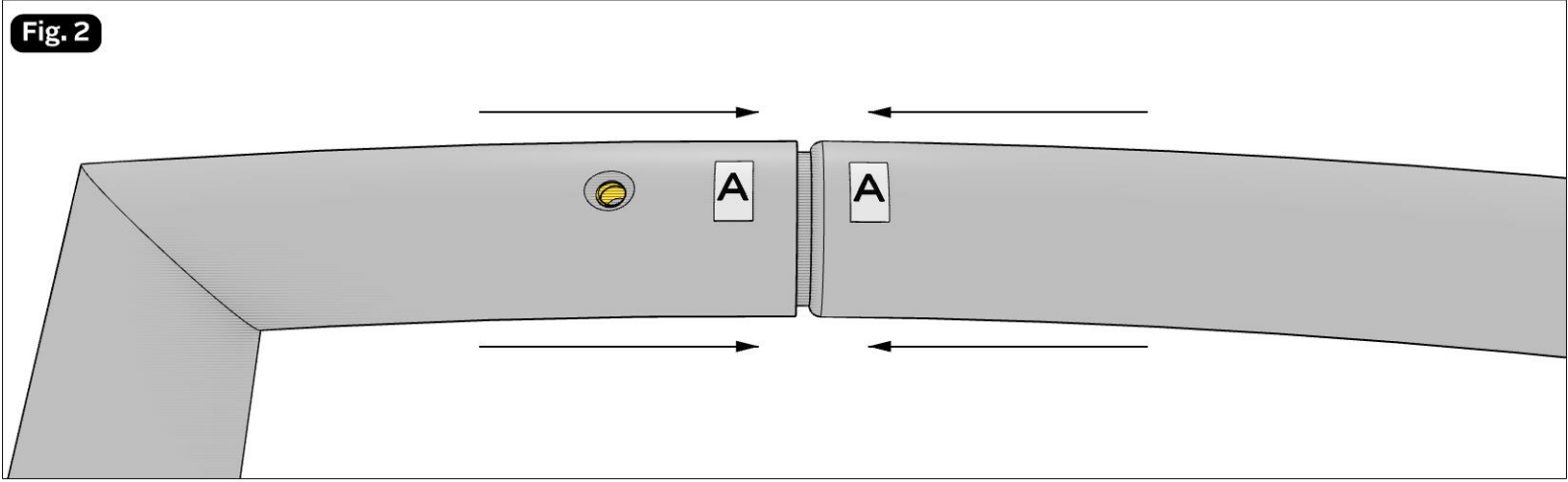
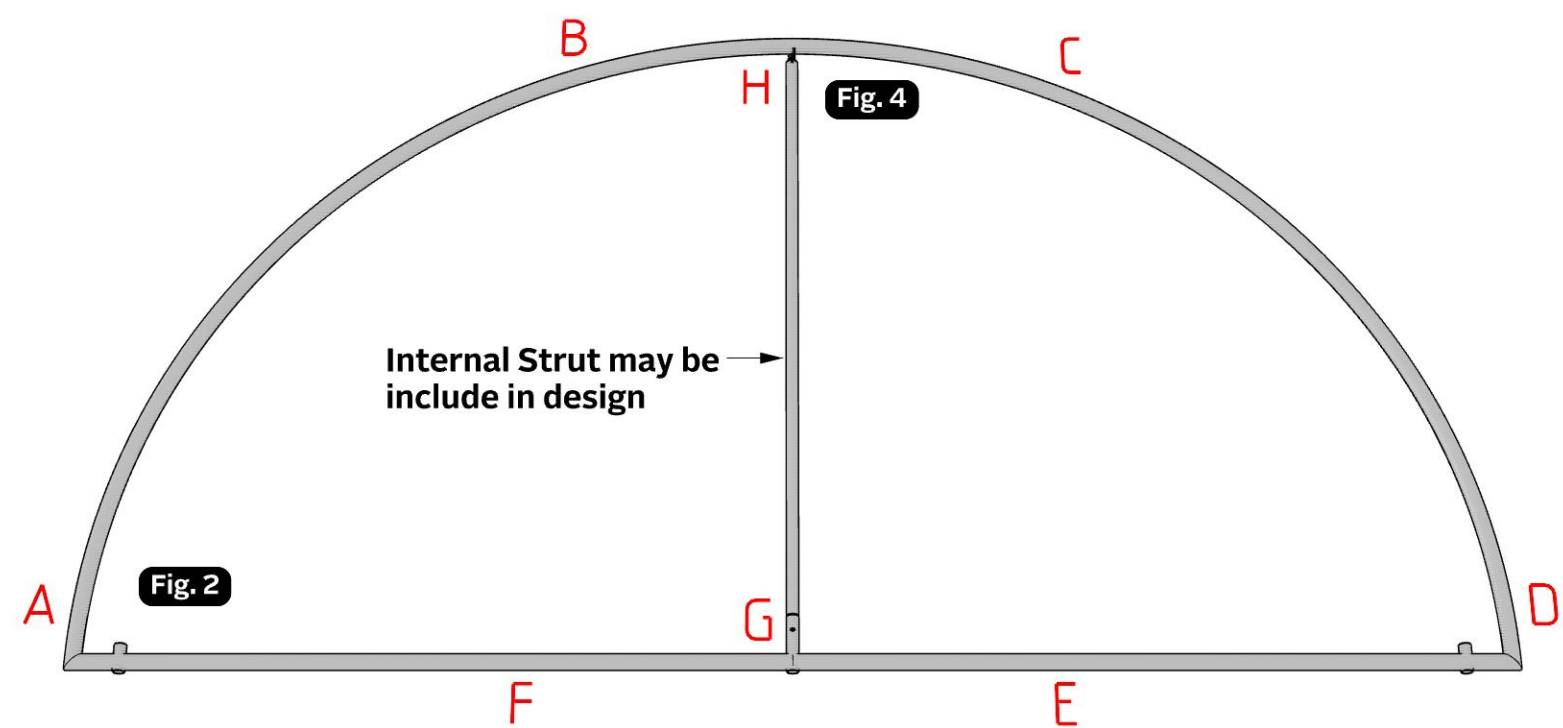

5

Screw together all the frame segments using the provided bolts.
Sleeve junctions require one fastener.
Tab connections on internal struts will require two fasteners.

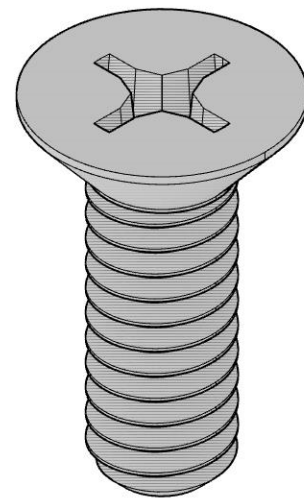
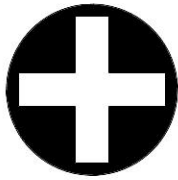
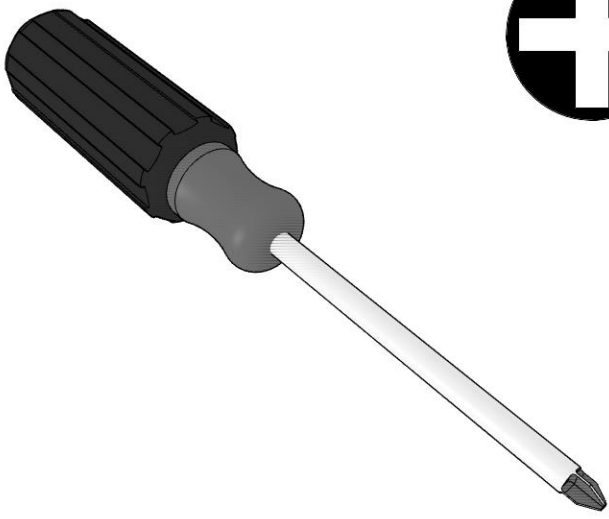

#3 Phillips Head Driver

1/4-20 Fasteners

Fig.3

PRO TIP

Tighten fasteners with caution
to avoid cross-threading bolts

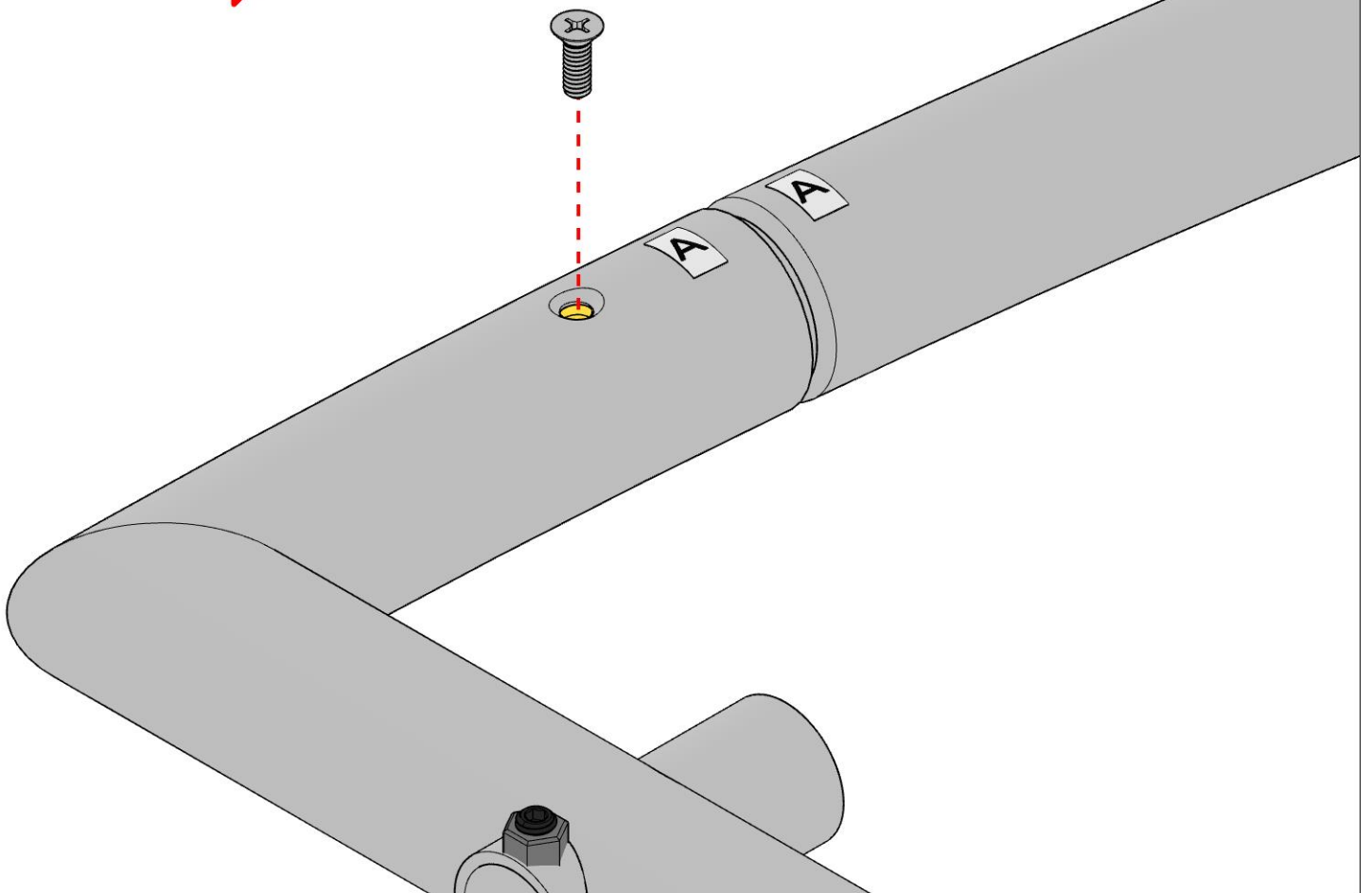
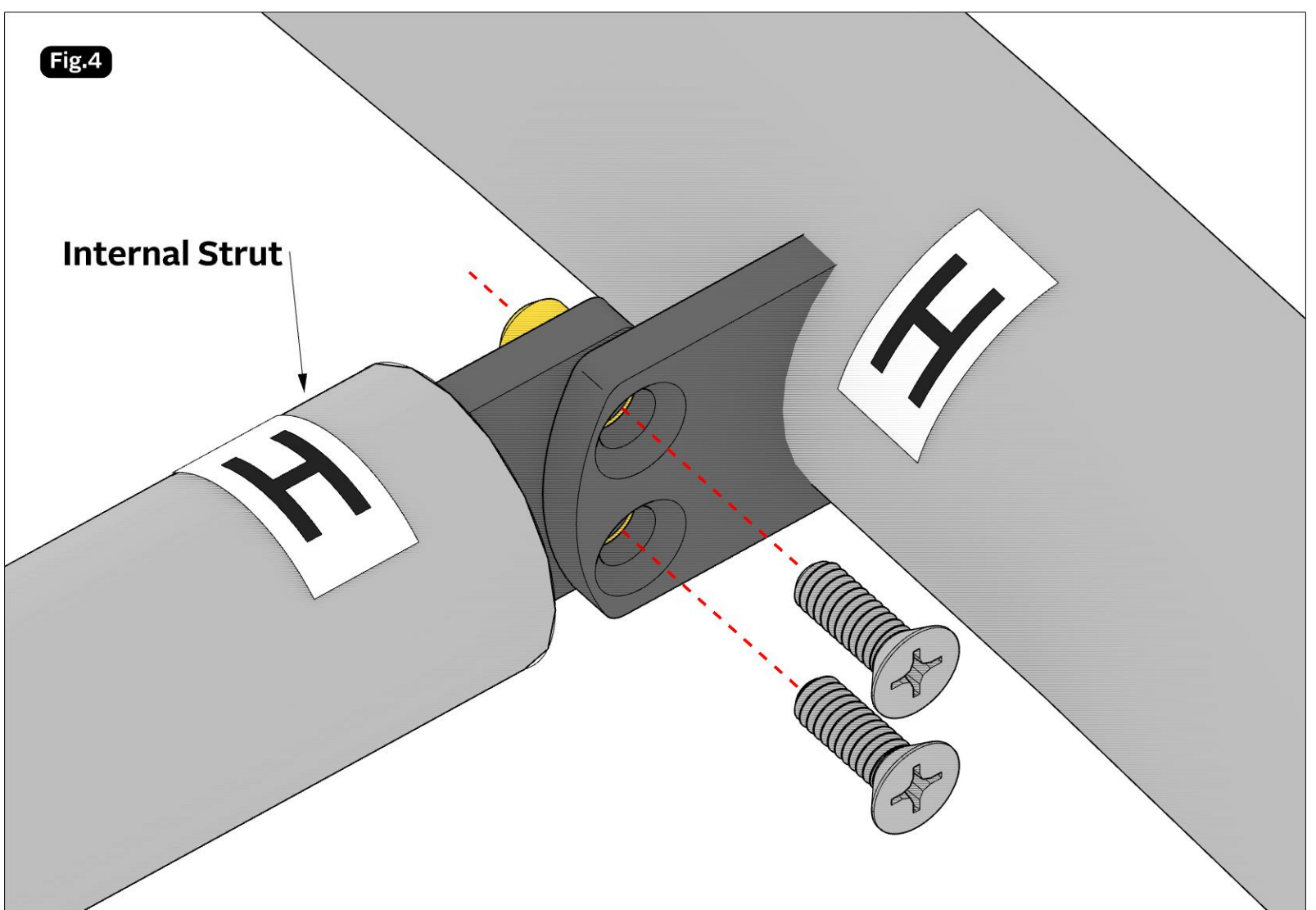

Fig.4

Internal Strut



6

If your frame is ground supported, prepare all of your base plates. Fasten each steel pin to a base plate with the provided fastener. Pins attach through the center hole, but other holes may be used.

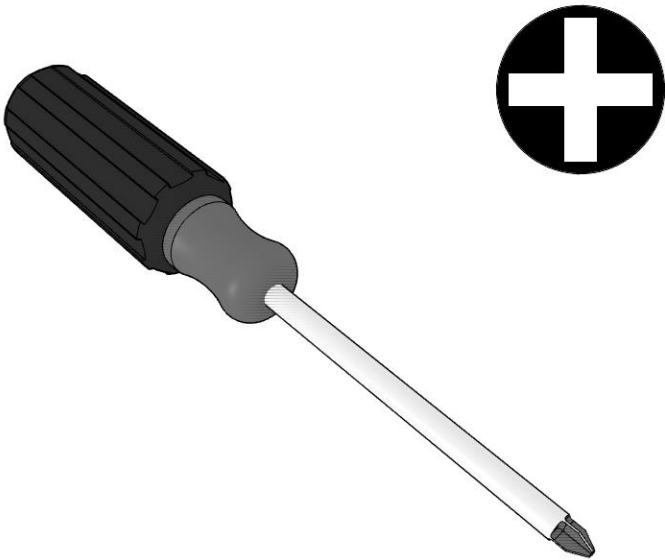
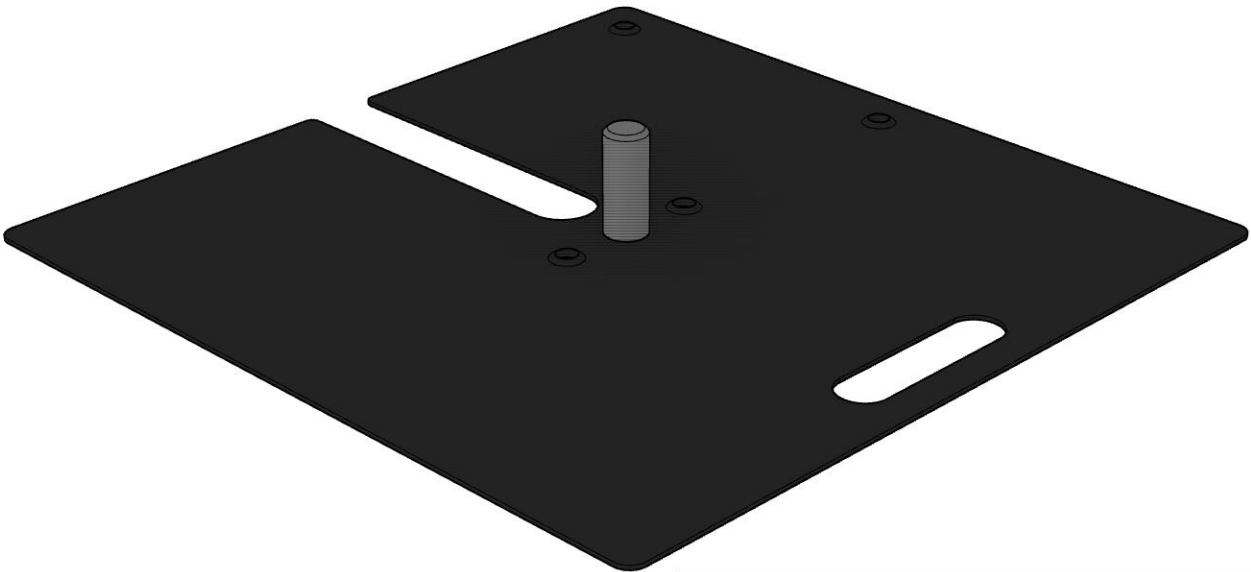

#3 Phillips Head Driver

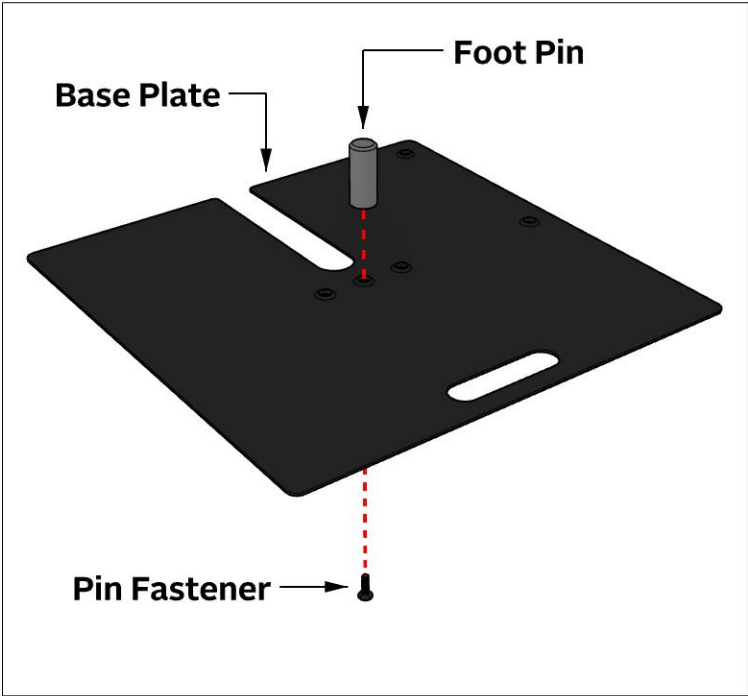

7

Before you install base plates, ensure set screws are loose/do not obstruct the coped opening. With the frame lying on the ground, insert the steel pins into the coped opening on the frame.

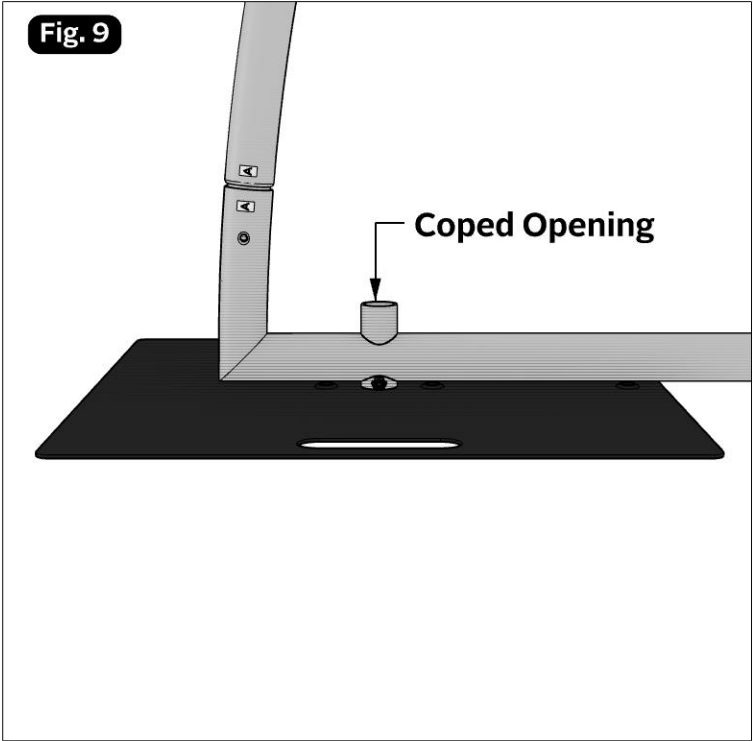
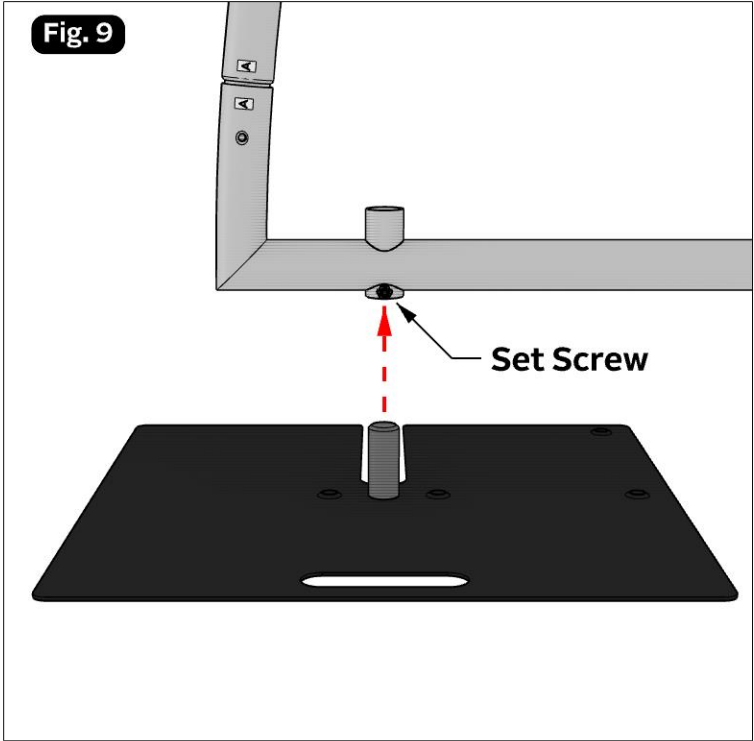
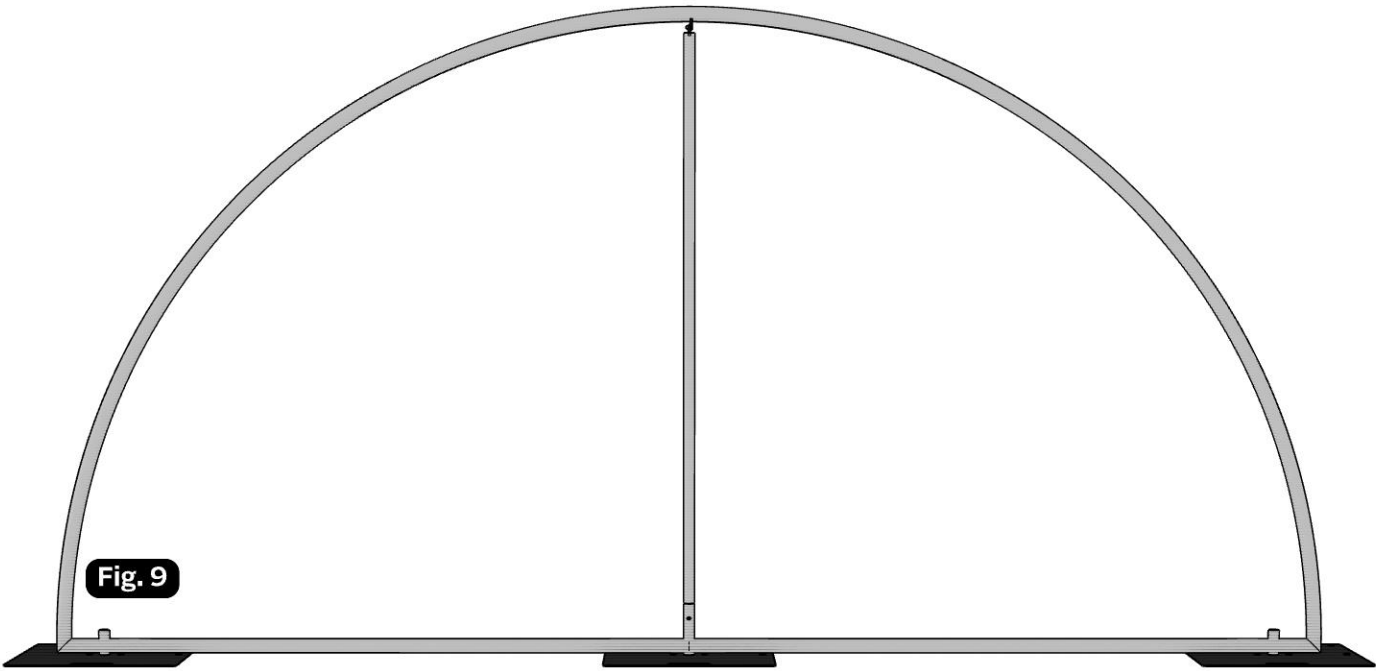

8

When all the base plates are fully installed, walk your 2D form frame into its intended upright position.

PRO TIP

For frames that are very wide and/or tall, 10'+, work in a team of 2 or more people to safely raise the frame.

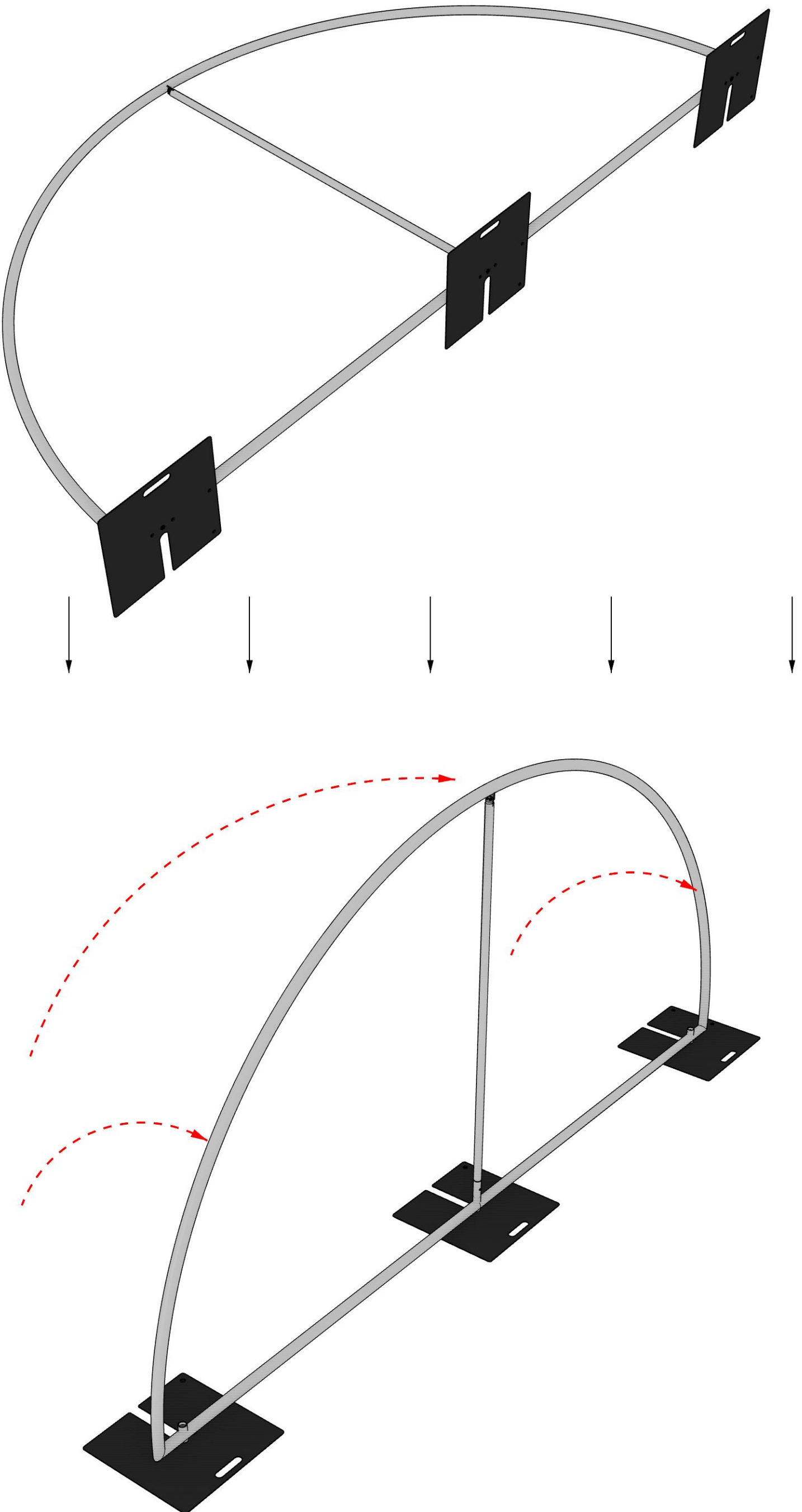

PRODUCT CONSTRUCTION

Fabric Application Tips and Tricks

Even though we meticulously clean and coat the aluminium, a quick wipe down of the frame with a clean towel or rag before assembly will help prevent staining your fabric skin with unseen oils or residues.

PRO TIP Use the provided nitrile gloves during fabric installation to avoid marring the fabric skin.

PRO TIP We recommend installing fabric in a team of two or more, especially for frames exceeding 15 feet in width and/or height.

PRO TIP Establish a clean working environment before installing fabric. Consider using a drop cloth or plastic sheeting.



Nitrile Gloves

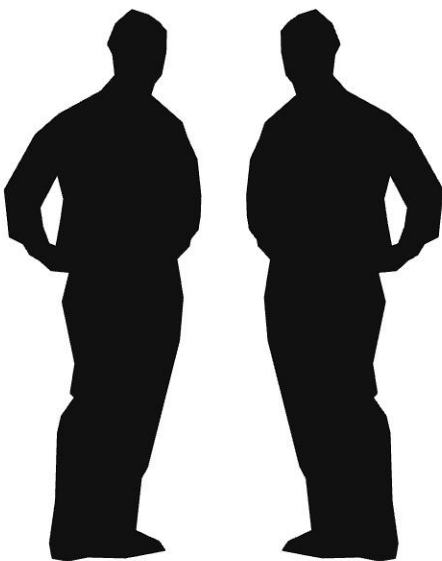

Team Work

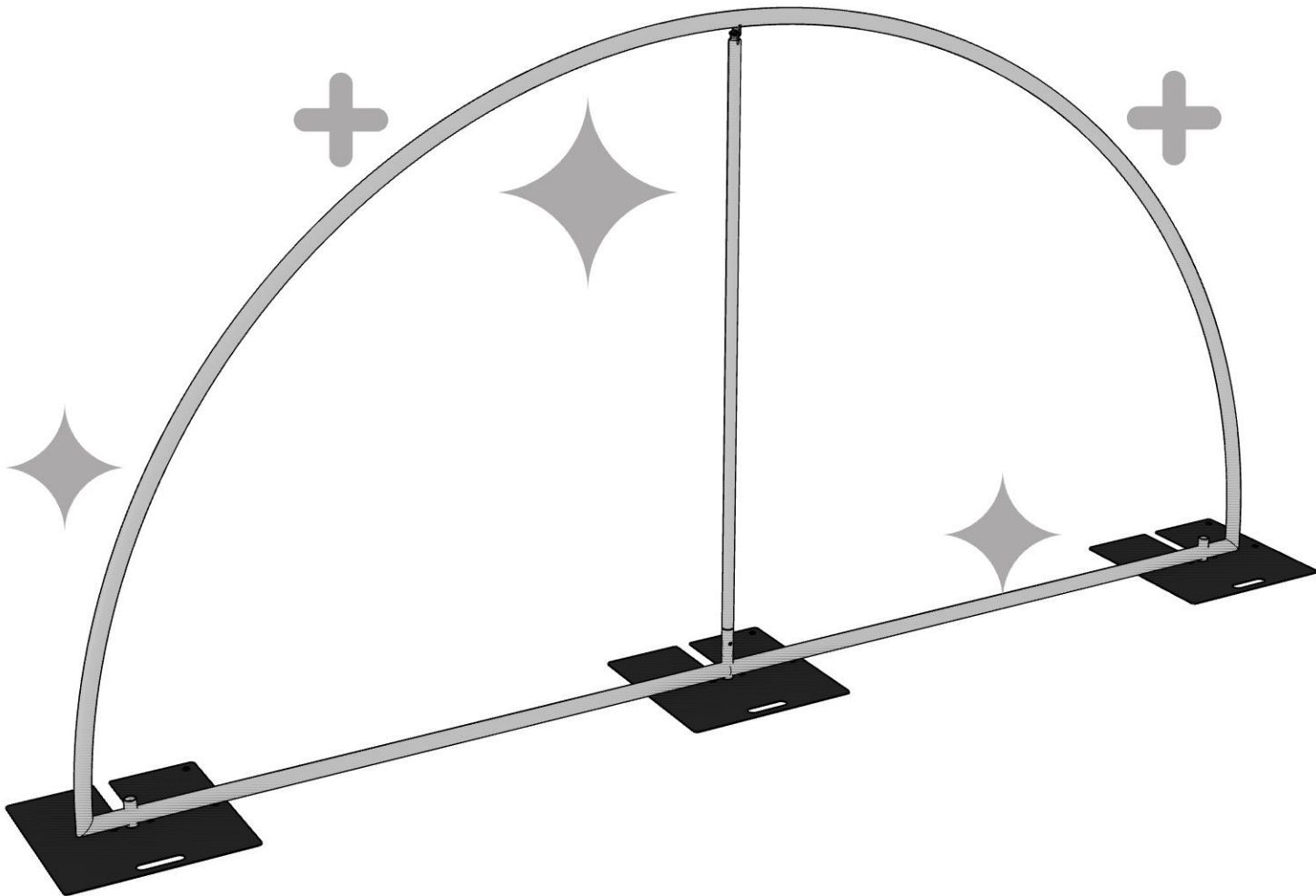

PRODUCT CONSTRUCTION

Fabric Application

1

Establish a clean working environment. Consider using drop cloths or plastic sheeting to maintain a debris-free surface. Put on your nitrile gloves.

PRO TIP

Carpeted floors work well for setup

An illustration of a squeegee tool with a long, thin handle and a wide, flat head with a brush-like edge. The tool is positioned diagonally on a light gray, rectangular surface that represents a drop cloth or plastic sheeting. The background is white.

2

Unpack your fabric skin. For asymmetrical forms, take a moment to lay out the fabric and identify the correct orientation in accordance with your frame.

An illustration of a large, irregularly shaped piece of fabric or plastic sheeting. It is shown in a perspective view, with one corner folded over. The material has a light gray, textured appearance. The background is white.

3

Unzip the zipper at the bottom of the fabric skin, and pull the skin over the top of the upright frame like a pillowcase. The fabric will drape down over both sides.

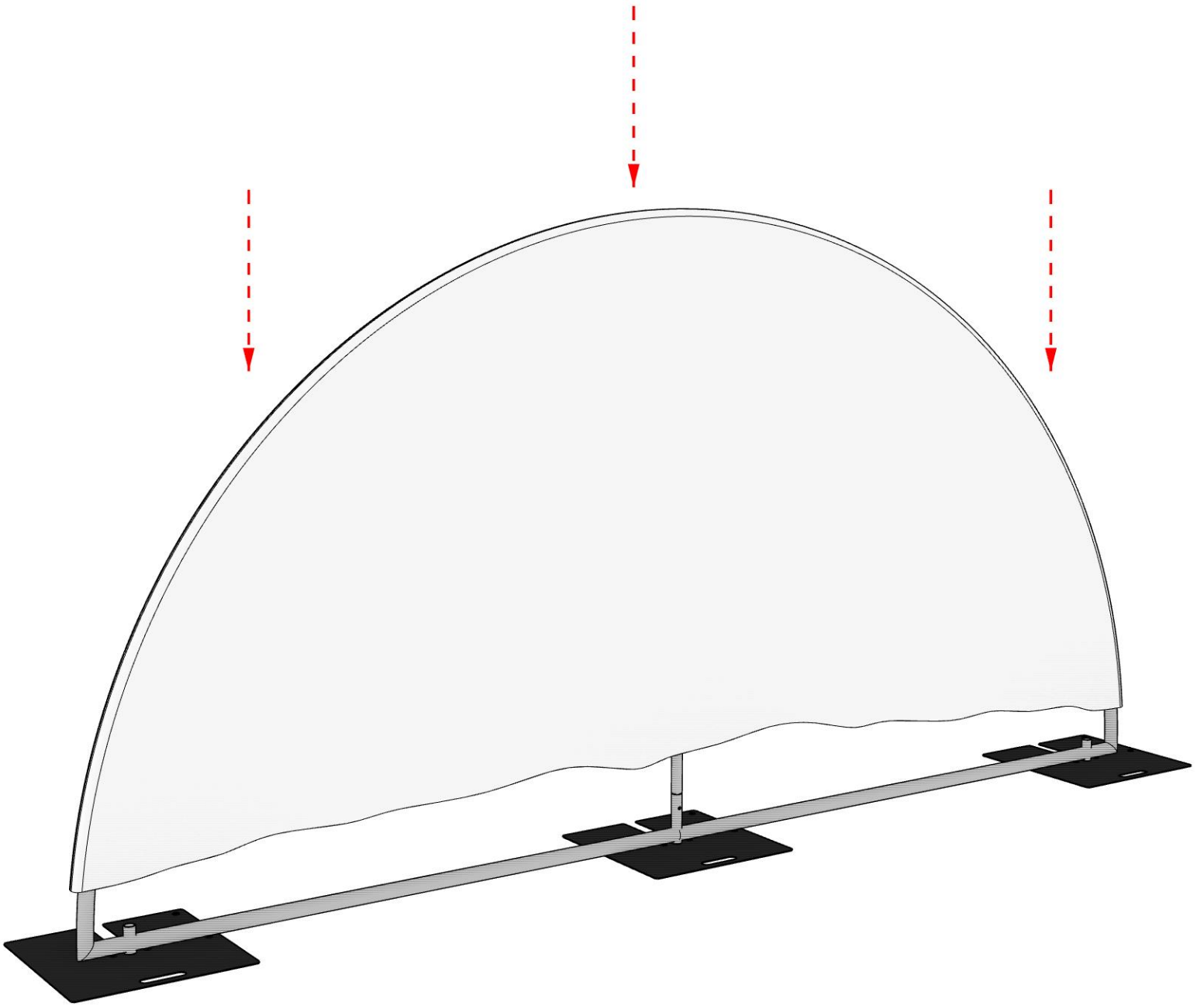

PRO TIP

For tall frames, consider tilting the frame back onto sawhorses to create a better working height. You can pull the fabric on and then return the frame to its upright position.

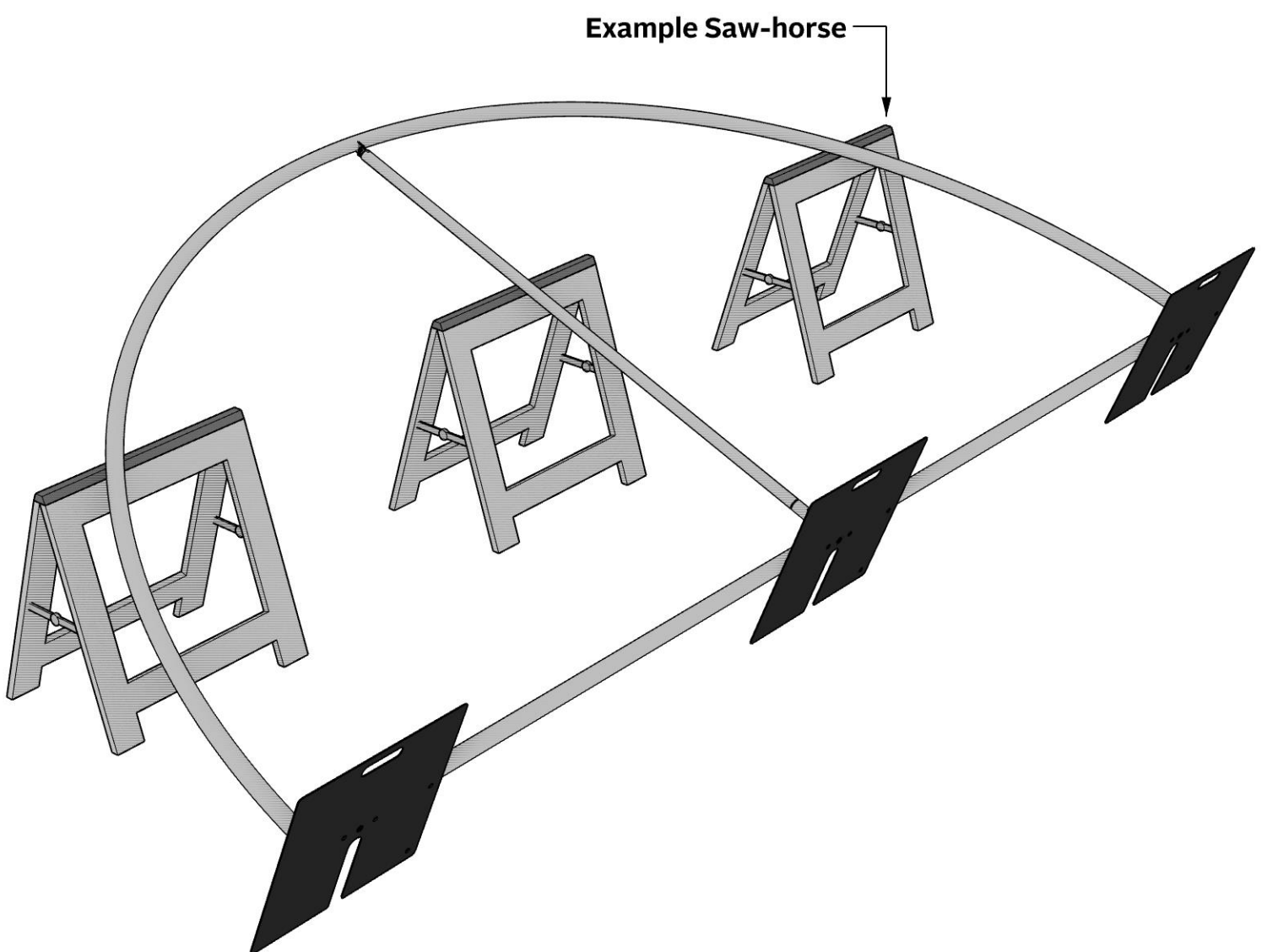

4

On the bottom of the fabric cover, fasten the zipper enclosures. When fully fastened, adjust the zipper and fabric so that the enclosure lays as flat against the tube as possible.

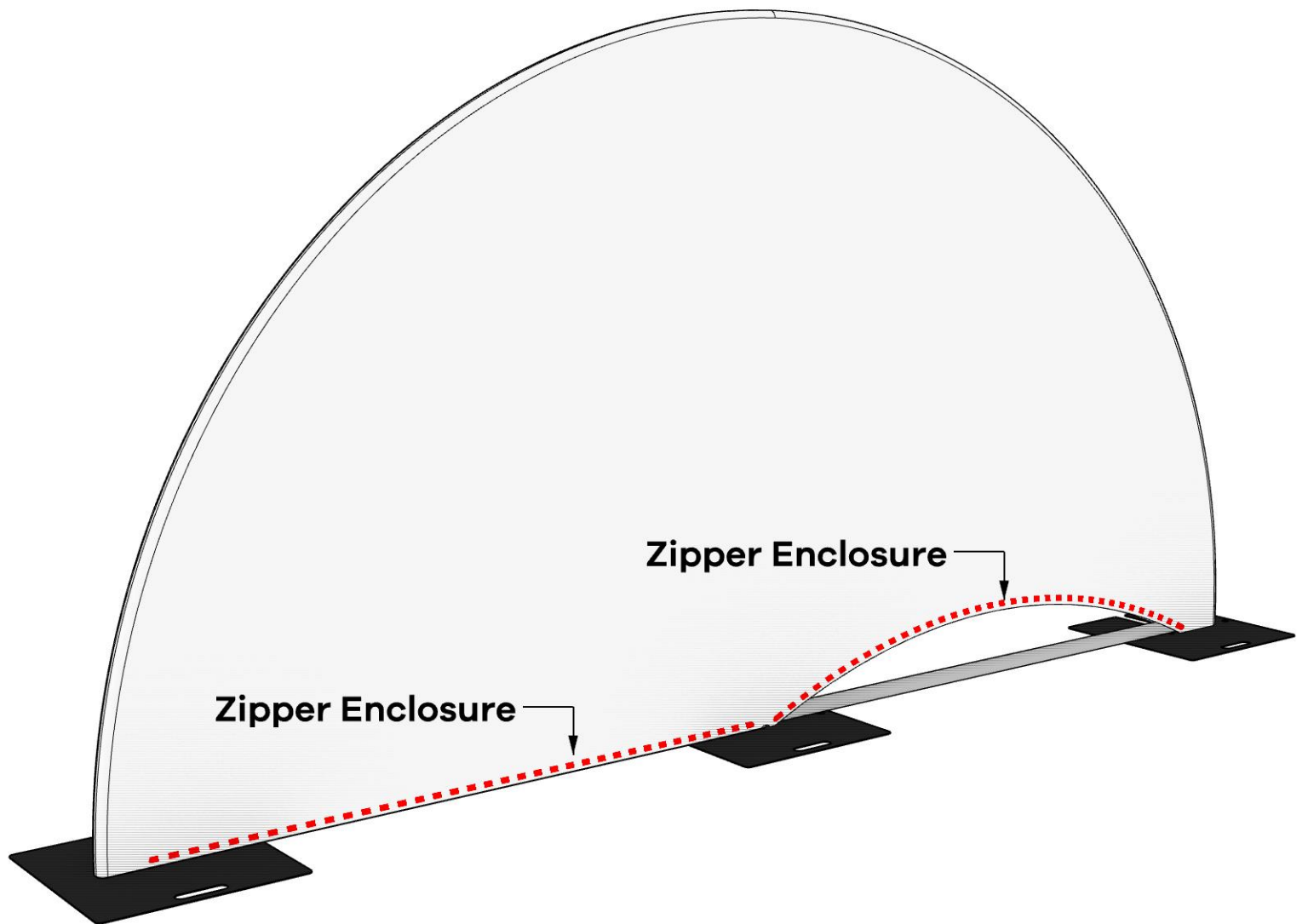

5

If your frame includes hook and loop enclosure on the bottom corners of the fabric, fasten all of the enclosures on your cover. This enclosure is **NOT PRESENT ON ALL FABRIC COVERS.**

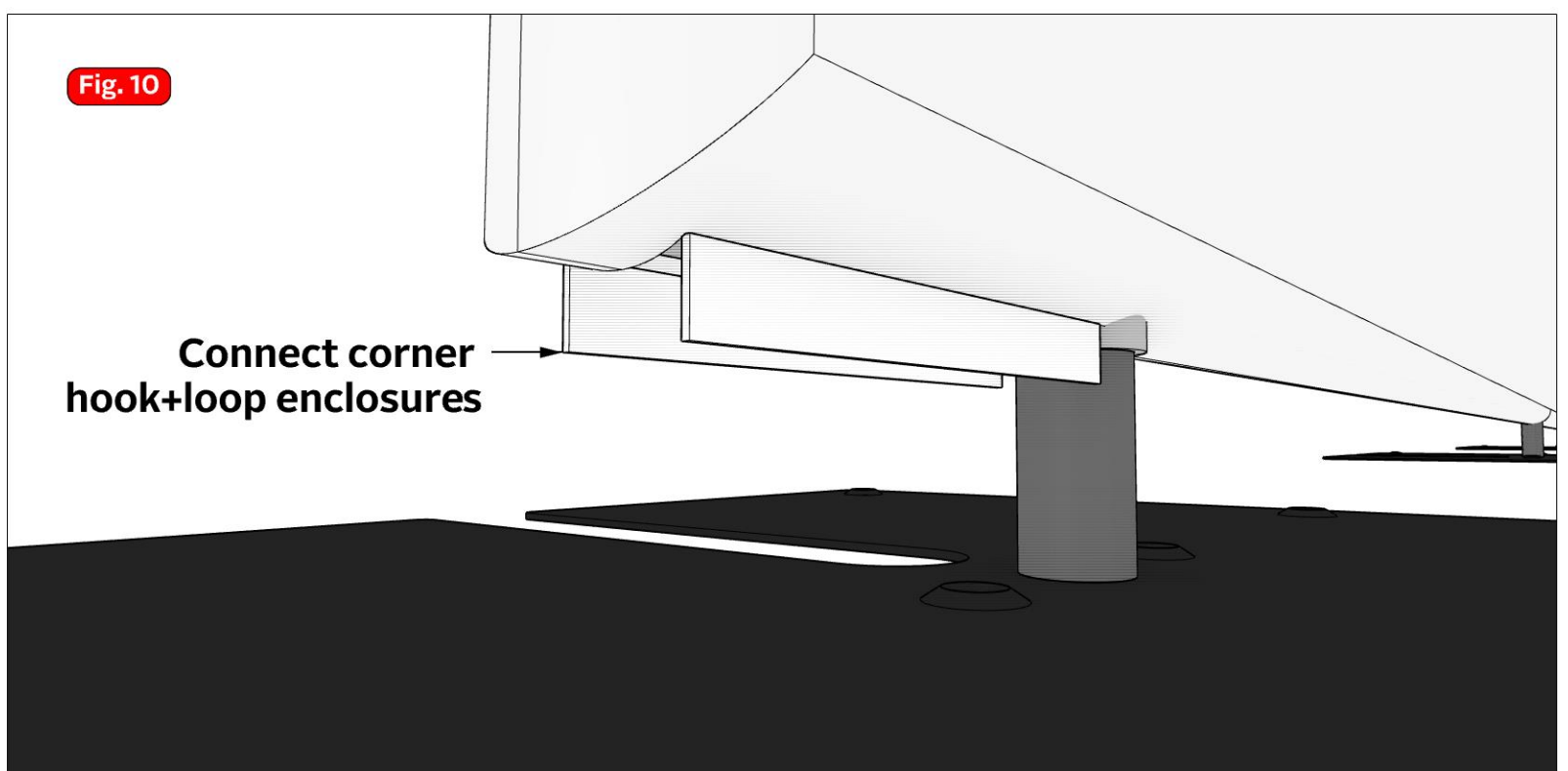

6

If your ground mounted frame requires set screws, use the provided $\frac{3}{16}$ " hex key to tighten the set screws against the foot pins.

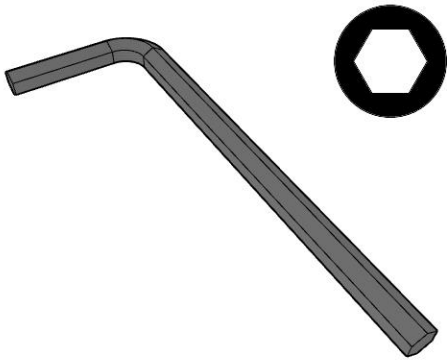

3/16" Allen Key - x1

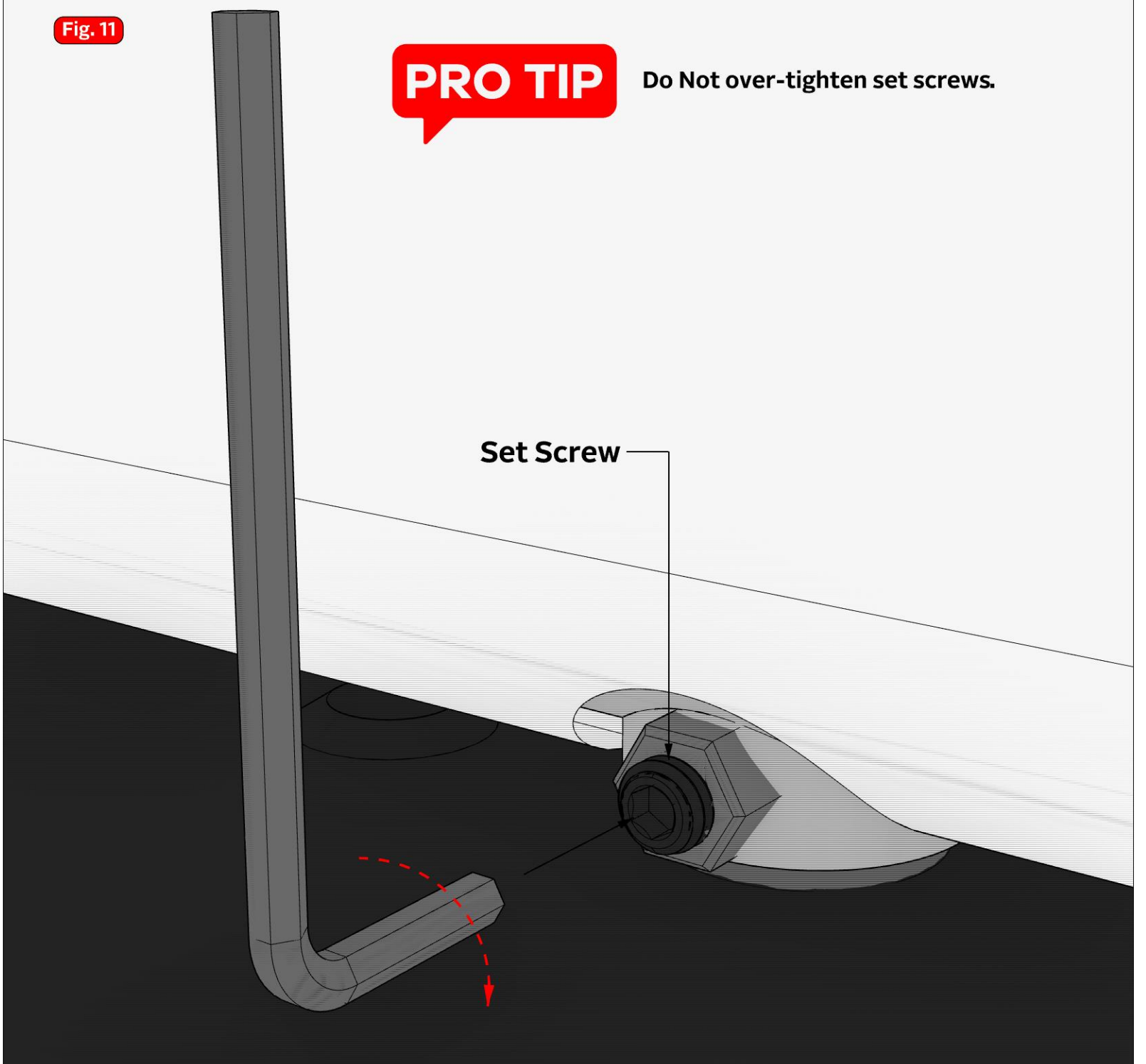

Fig. 11

PRO TIP

Do Not over-tighten set screws.

Set Screw



7

Your frame may have 1/4-20 Aerial Eyes for safety lines or aerial rigging. Review your design drawings, and install the aerial eyes at locations marked. Some typical locations are shown below.

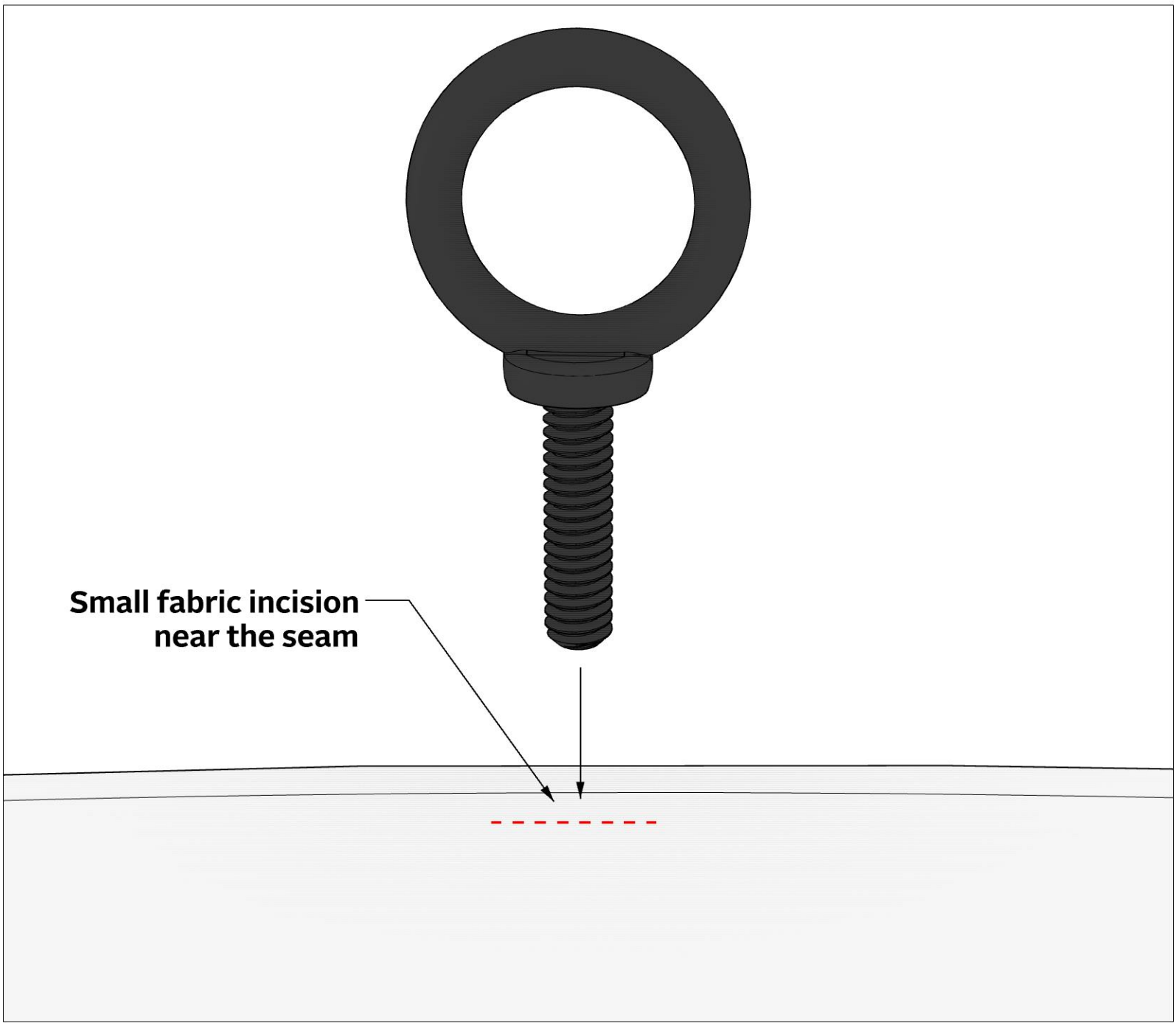
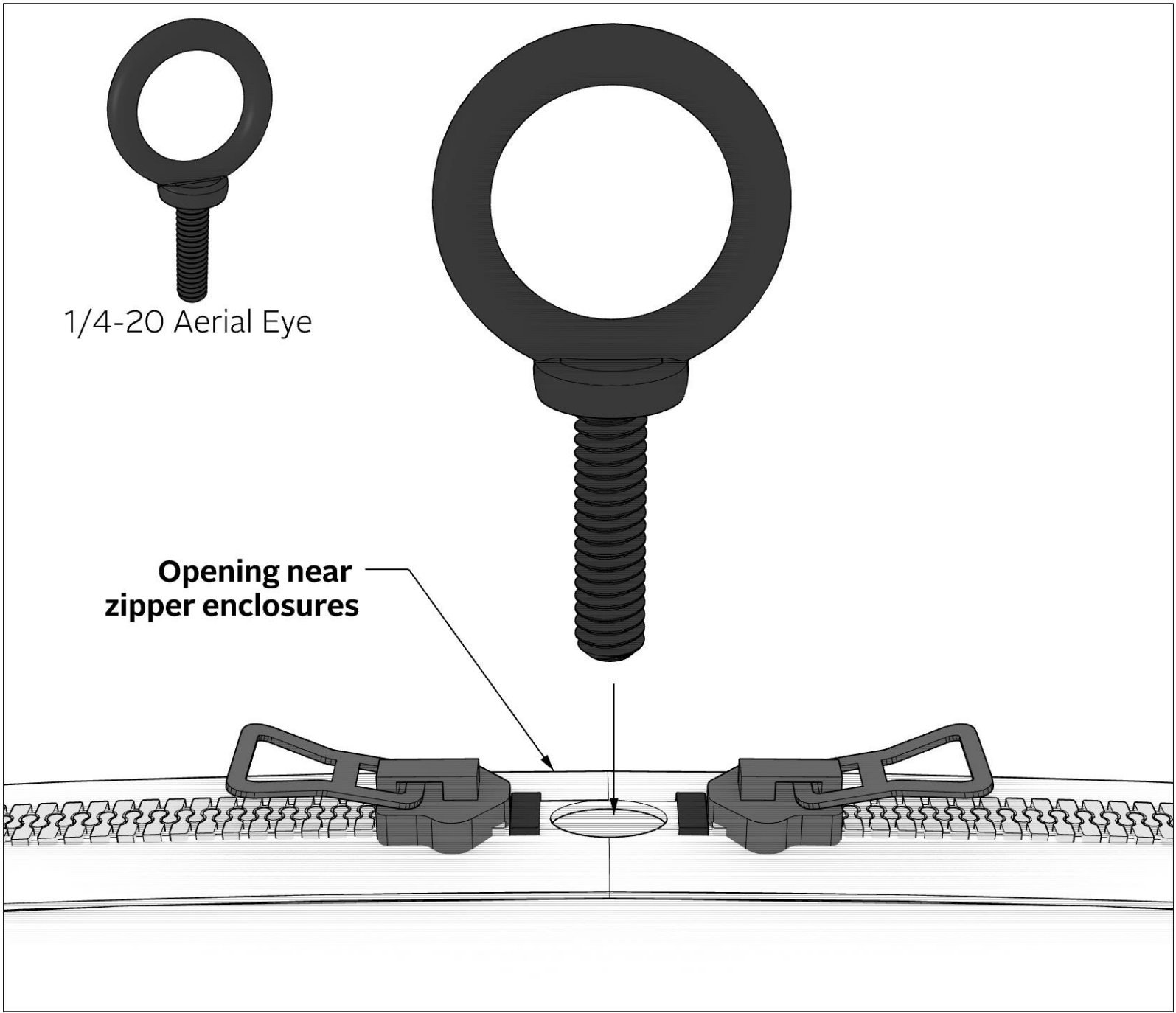

FABRIC CARE

UNIVERSAL STRETCH FABRIC (USF)

Storage Notes and Methods

Qualified orders include a cloth drawstring bag, which is ideal for long-term storage. When storing your fabric in a sealed container, like the plastic bag the skin arrived in, the fabric must be completely dry to avoid mold or mildew growth.

If your product includes any metal parts such as gate ring, rigging supplies, or frames, be sure to remove them prior to storage. Wrinkles can result from fabric storage. Almost all wrinkles from storage will stretch out once the fabric is installed correctly. If deep wrinkles persists, place fabric in a dryer on low heat for a few minutes.

Cleaning and Dusting

Light clean: Fingerprints from installation without gloves are the main culprit of a dirty screen. Follow the setup instructions carefully, and always use nitrile gloves when handling fabric skins. To remove light stains, use hot soapy water and dab the area clean.

Deep clean: Machine wash fabric on delicate with detergent and Oxiclean®. Machine dry on low heat, regularly checking for completion. IFR products dry quickly. All USF products will retain IFR (Inherently Flame Retardant) certification after repeated washes.

Dusting: We understand that many of our products may be left up over long periods of time. Dust will inevitably stick to the surface and collect. To remove dust on fabric, use a clean object to lightly bat the back surface. Start at the center of the fabric and move towards the outer edges.



DO NOT OVER DRY. Extended heat will damage the spandex in the fabric material.



DO NOT USE BLEACH or bleach-based cleaners on USF fabric. Bleach will damage the spandex in the fabric.



MOSS

WE ARE PLACE MAKERS™

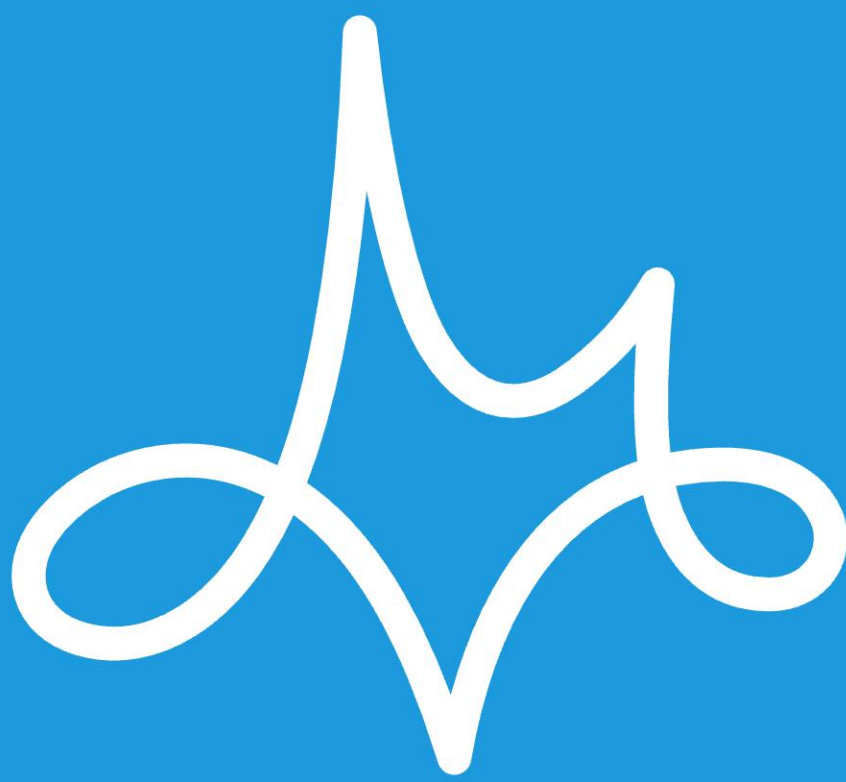

MOSS

WE ARE PLACE MAKERS™