

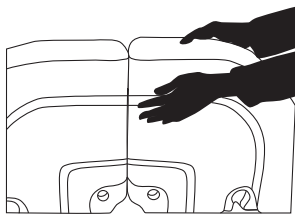

- A - Mast Guide- 2 qty
- B - Mast Support- 1 qty
- C - Collar- 1 qty
- D - Graphic Bar- 1 qty
- E - Screw- 1 qty
- F - Rings (not needed)

Before Beginning: Please remove all the rings (F) from the mast and graphic bar(D). In order to make assembly easier, the graphic is sleeved so the rings are not needed.



1
Unfold the base.

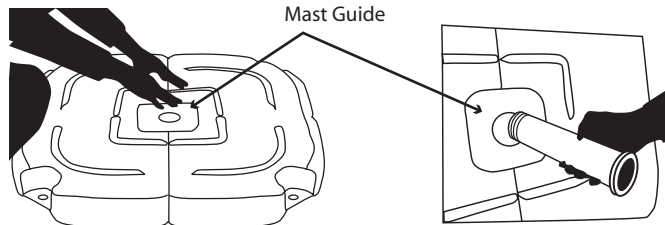

2
Place a mast guide (A) on the top and bottom of the base.

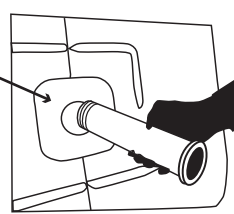

3
Insert the mast support (B) from the bottom with the threads on top.

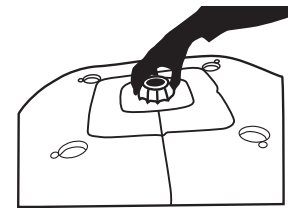

4
Secure the mast support (B) with the collar (C).



5
Place base in desired location and fill with water.

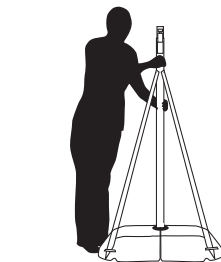

6
Place the mast into the center hole and the four support poles in the corners.
Note: If the support legs don't reach the corners, loosen and lower the mast ring.

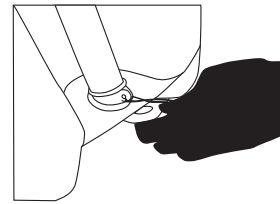

7
Secure the support poles by pushing the locking plastic bracket into position.

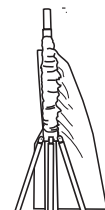

8
Place the sleeve on the side of the graphic over the mast pole.

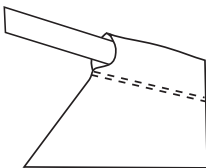

9
Insert the graphic bar (D) into the sleeve on the top of the banner.

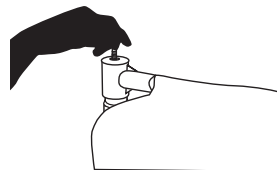

10
Secure the graphic bar (D) by screwing the thumb screw (E) into the top of the mast.



11
Locate the velcro tab at the end of the sleeve. Remove the protective backing and apply the adhesive layer directly to the pole. (Note: When disassembling flag, simply unzip velcro pieces from each other.)

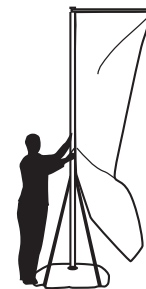

12
Lift the mast one section at a time, making sure that every section clicks into position.